

# Claim of Beneficial Use Map Permit R-12138 (Application R-81267)

Water Right in the Name of Nike Inc.

Township 1 South, Range 1 West, Section 5 (W.M.)

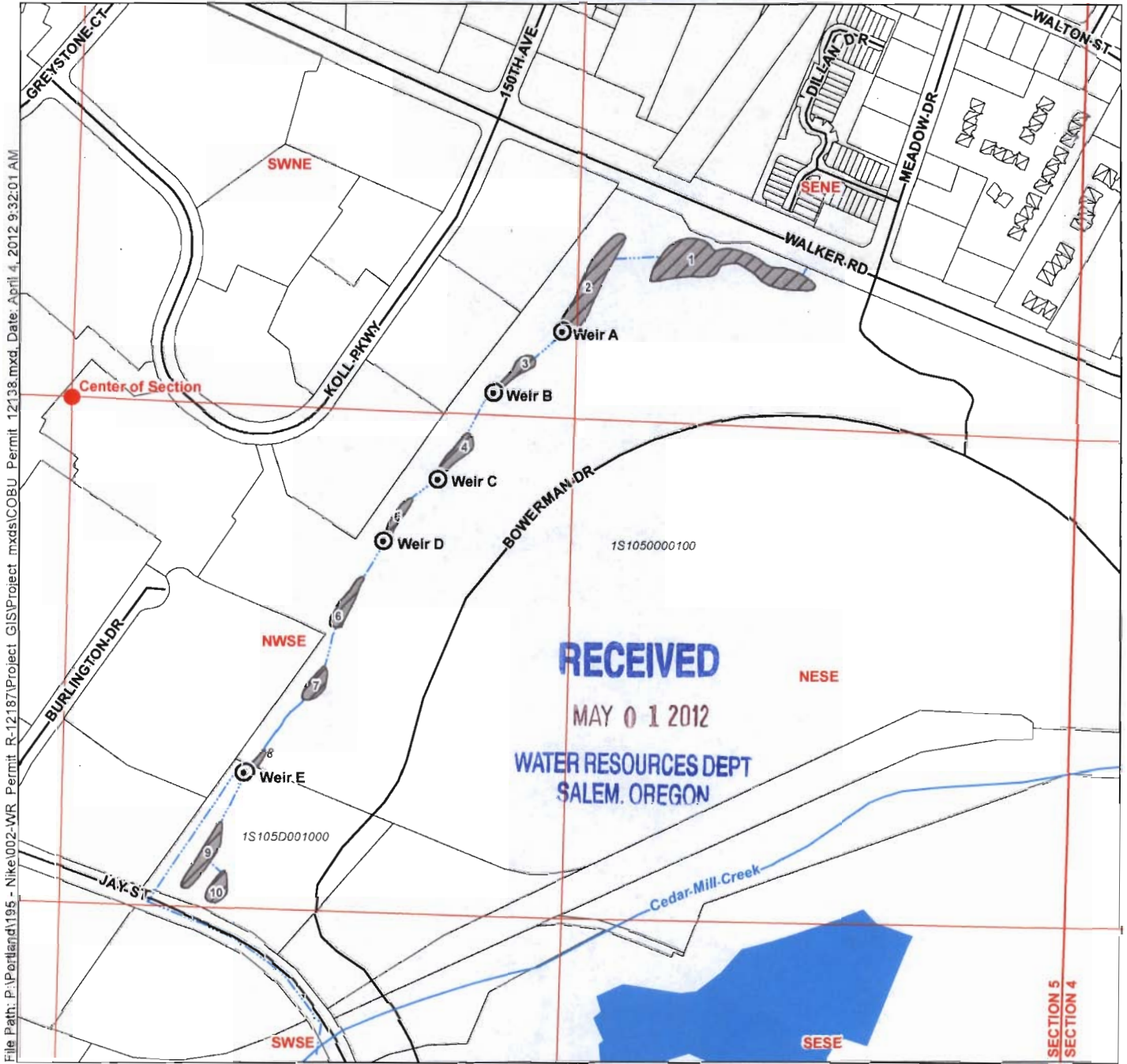

File Path: P:\Portland\195 - Nike\002-WR\_Permit\_R-12138\Project\_GIS\Project\_mxd\COBU\_Permit\_12138.mxd, Date: April 4, 2012 9:32:01 AM

- LEGEND**
- Point of Diversion (POD)
  - Place of Use (POU)
  - Taxlots
  - streets
  - Culvert
  - Watercourses
  - Waterbodies

**POD Legal Description:**  
**Weir A** - Located 235 feet North and 1,285 feet East from the center of Section 5, Township 1 South, Range 1 West (W.M.).  
**Weir B** - Located 60 feet North and 1,110 feet East from the center of Section 5, Township 1 South, Range 1 West (W.M.).  
**Weir C** - Located 170 feet South and 970 feet East from the center of Section 5, Township 1 South, Range 1 West (W.M.).  
**Weir D** - Located 340 feet South and 845 feet East from the center of Section 5, Township 1 South, Range 1 West (W.M.).  
**Weir E** - Located 970 feet South and 485 feet East from the center of Section 5, Township 1 South, Range 1 West (W.M.).

**Disclaimer**  
 This map was prepared for the purpose of identifying the location of a water right only and it is not intended to provide legal dimensions or location of property ownership lines.

**Map Notes**  
 Date: April 6, 2012  
 Data Sources: Nike, METRO  
 Prepared By: GSI Water Solutions, Inc.

