

RENEWAL 12/31/99

FINAL PROOF SURVEY

FOR
LEEROY AND NANCY HORTON
P.O. BOX 784
CHRISTMAS VALLEY, OR 97641
(541) 576-2438

APPLICATION: T-7333
PERMIT: G-7470

REVISION	BY
ANDERSON ENGINEERING AND SURVEYING, INC. P.O. BOX 28 LAKEVIEW, OREGON 97630 (541) 947-4407 FAX 947-2321	
ANDERSON ENGINEERING AND SURVEYING, INC. P.O. BOX 419 REDMOND, OREGON 97756 (541) 923-4307 FAX 923-4308	
PREPARED FOR: LEEROY AND NANCY HORTON P.O. BOX 784 CHRISTMAS VALLEY, OR 97641	
DATE: 10/7/98	
SCALE: 1"=1320'	
JOB: 98078	
DWG. BY: R.F.C.	
FILE: 98078	
SHEET 1 OF 1	

EXISTING WELL, LOCATED
1150.0 FEET EAST AND
1340.0 FEET SOUTH FROM
THE NORTHWEST CORNER
OF SECTION 28 AS PER
CERTIFICATE NO. 65871, NOT
SURVEYED AS A PART OF THIS
FINAL PROOF MAP.

TOWNSHIP 26 SOUTH

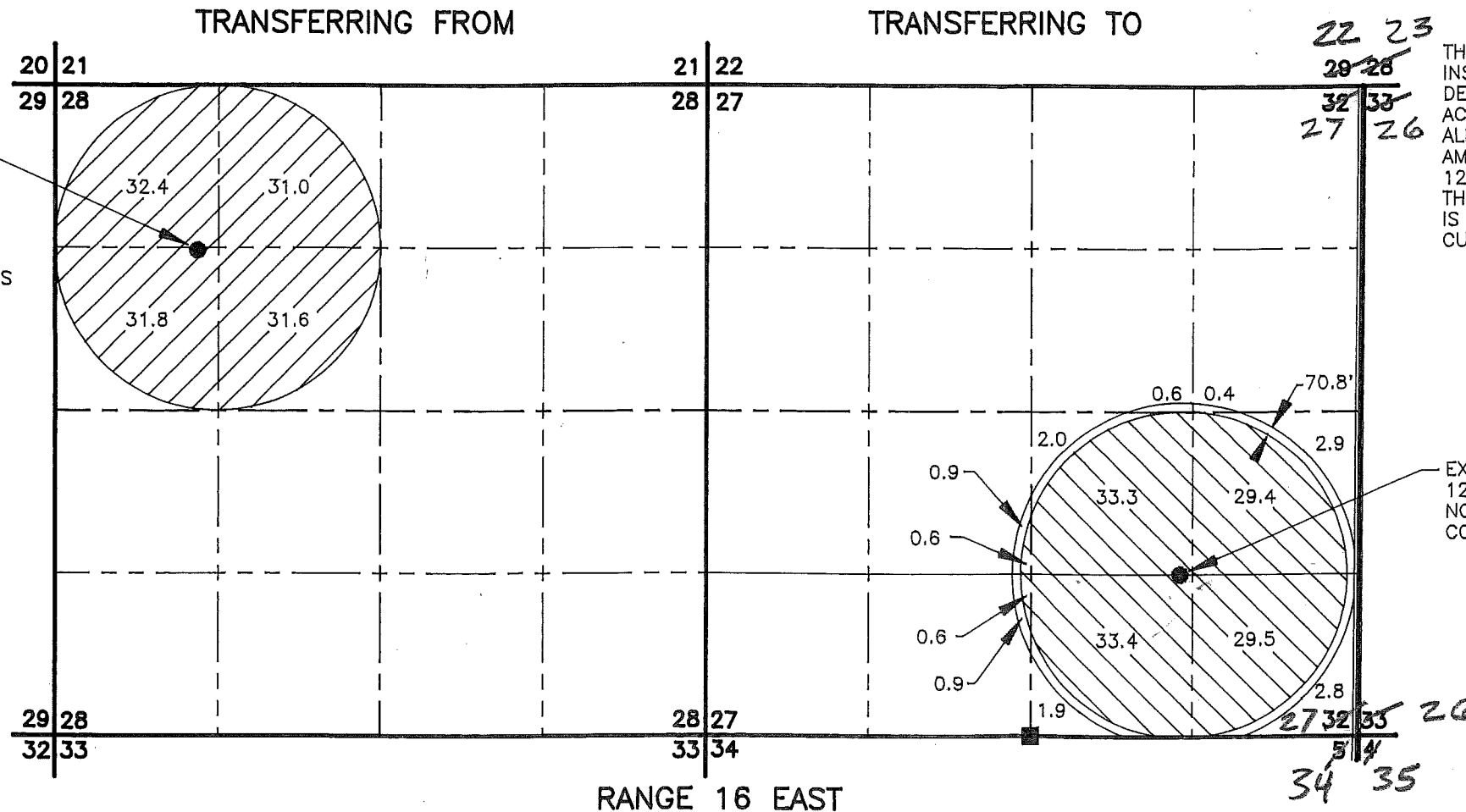

NOTE

THE ACREAGE AS SURVEYED DURING THE FIELD INSPECTION FOR THE FINAL PROOF SURVEY WAS DETERMINED FROM THE CROP CUT LINE. 139.2 ACRES ARE BEING IRRIGATED. TRANSFER T-7333 ALLOWED 126.8 TO BE IRRIGATED. THE EXCESS AMOUNT OF ACREAGE BEING IRRIGATED AMOUNTS TO 12.4 ACRES.
THE CORRECT ACREAGE AS PER TRANSFER T-7333 IS AT A DISTANCE OF 70.8 FEET IN FROM THE CROP CUT LINE AS SURVEYED ON 10/5/98 AS SHOWN.

EXISTING WELL, LOCATED
1219.6 FEET EAST AND 1314.0 FEET
NORTH FROM SOUTH ONE QUARTER
CORNER OF SECTION 27.

LEGEND

- SECTION LINE
- 1/4 SECTION LINE
- 1/16 SECTION LINE

● EXISTING WELL

■ FOUND 1912 G.L.O.
BRASS CAP ON IRON
PIPE AT THE S1/4 OF
SECTION 27.

126.8 ACRES UNDER CERTIFICATE NO.65871
TRANSFERRED AS SHOWN.

126.8 ACRES UNDER CERTIFICATE NO.65871
TRANSFERRED TO HERE AS SHOWN.
THE AREA AS SHOWN AROUND THE HATCHED
AREA IS BEING IRRIGATED AND THE ACRES
OF EXCESS BEING IRRIGATED ARE AS SHOWN.
12.4 ACRES EXCESS BEING IRRIGATED AS
PER FINAL PROOF SURVEY MEASUREMENTS.

NOTE: PREPARATION OF THIS MAP IS FOR IDENTIFYING PROPOSED
WATER RIGHTS ONLY. IT HAS NO INTENT TO PROVIDE LOCATIONS
OR DIMENSIONS OF PROPERTY BOUNDRIES..

RECEIVED

OCT 22 1998

WATER RESOURCES DEPT.
SALEM, OREGON

SCALE: 1"=1320'

Section numbers updated by DC/WED
4/10/2012