

2/7/12 AMENDMENT  
 TRANSFER APPLICATION MAP for WILLIAM & ROSA RUPP  
 for an ADDITIONAL POD for Portions of CERTIFICATES 434 AND 2553  
 SECTIONS 11 & 12 T2S, R32E, W.M., UMATILLA COUNTY

EXISTING WATER RIGHTS

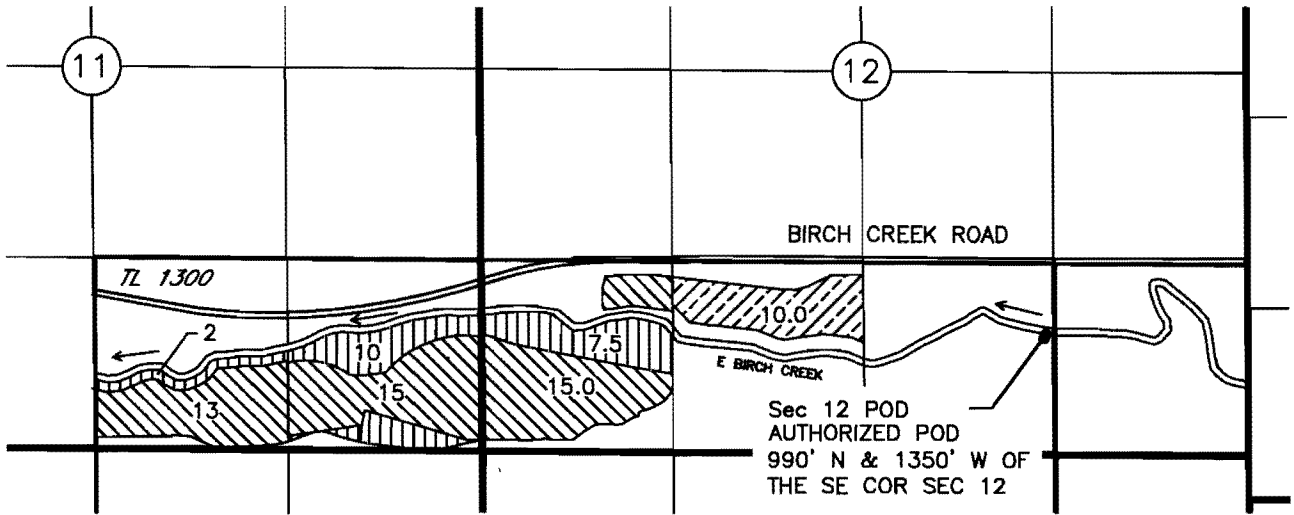

LEGEND

- |  |  |  |
|--|--|--|
|  CERT 2553<br>PRIORITY 1897 |  CERT 2553<br>PRIORITY 1885 |  CERT 434 |
|--|--|--|

NOTE: ACCORDING TO THE WATER MASTER THE ACREAGE VALUES LISTED ON CERT 434 FOR THE SWSE & SESE OF SEC 11 ARE TO BE REDUCED BY THE CORRESPONDING  $\frac{1}{2}$  ACREAGE VALUES LISTED ON CERT 2553 AND THE ACREAGE LISTED ON CERT 434 FOR THE SWSW IN SEC 12 IS TO BE REDUCED TO 7.5 ACRES. THE MAP SHOWN ABOVE REFLECTS THESE ADJUSTMENTS.

**RECEIVED**

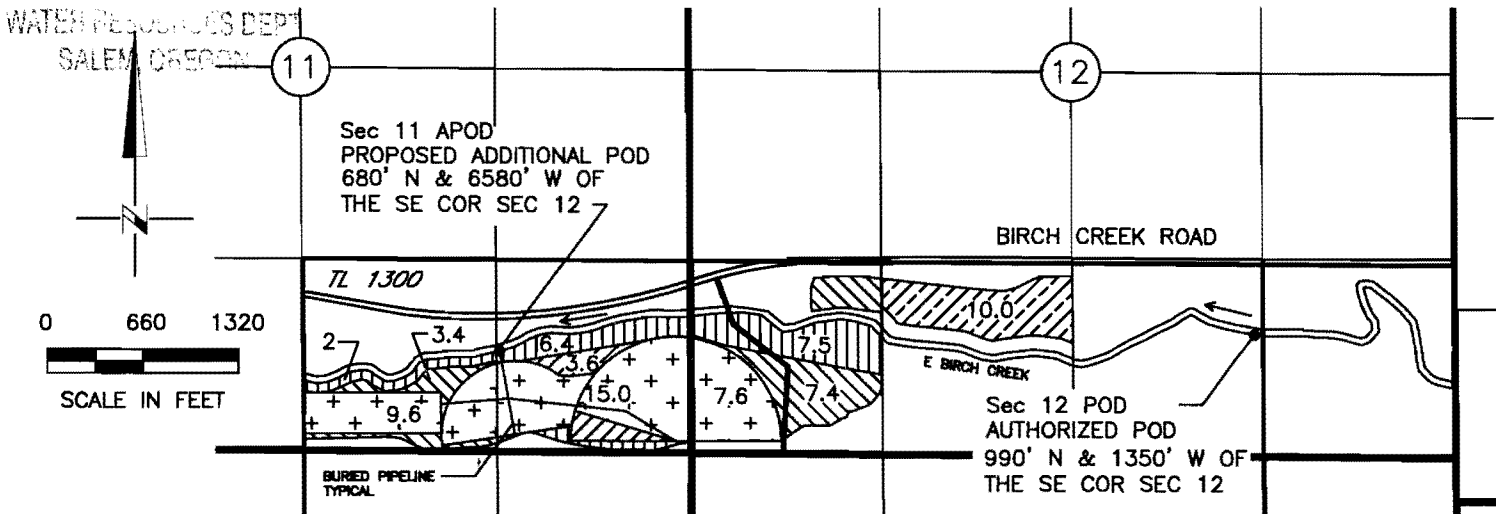

FEB 13 2012

CHANGED WATER RIGHTS





LEGEND

CHANGED  
WATER RIGHTS (APOD)

- |   |                            |
|---|----------------------------|
|  | CERT 2553<br>PRIORITY 1897 |
|  | CERT 434                   |

UNCHANGED  
WATER RIGHTS

- |   |                            |   |          |
|---|----------------------------|---|----------|
|  | CERT 2553<br>PRIORITY 1897 |  | CERT 434 |
|  | CERT 2553<br>PRIORITY 1885 |   |          |

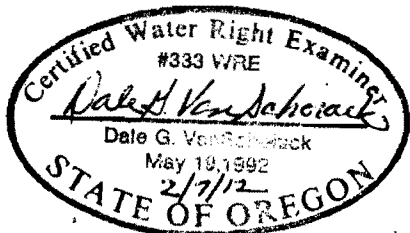

NOTE: THE PURPOSE OF THIS MAP IS TO IDENTIFY THE APPROXIMATE LOCATION OF THE WATER RIGHT. IT IS NOT INTENDED TO PROVIDE INFORMATION RELATIVE TO THE LOCATION OF PROPERTY OWNERSHIP BOUNDARY LINES.

2/7/12