

RECEIVED

AUG - 7 1996

WATER RESOURCES DEPT.
SALEM, OREGON

TOWNSHIP 6 SOUTH, RANGE 1 WEST, W.M.

Orig Well: MARI 3205 (Byer)
Added Well: MARI 3203 (Luda)
K.L.W.

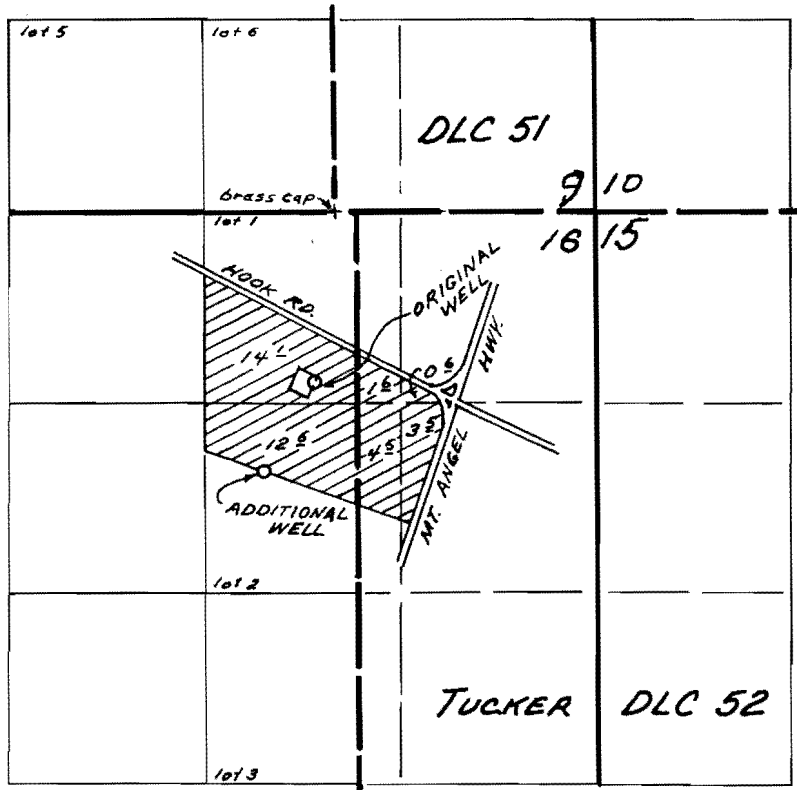

WELLS LOCATED:
 ORIGINAL WELL - 1180' S. AND 140' W. } BOTH FROM SW COR. DLC 51
 ADDITIONAL WELL - 1820' S. AND 480' W. }
 630 on order V 49, p. 300

FINAL PROOF SURVEY
 UNDER
 TRANSFER 6804
 IN NAME OF
 JOHN BEYER
 JULY 24, 1996

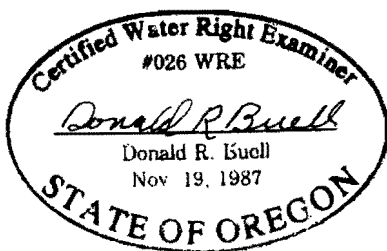

THIS MAP WAS PREPARED FOR THE PURPOSE OF IDENTIFYING THE LOCATION OF A WATER RIGHT ONLY AND IS NOT INTENDED TO PROVIDE LEGAL DIMENSIONS OR LOCATION OF PROPERTY OWNERSHIP LINES.