

Claim of Beneficial Use - Well Location Map
Application G-13336; Permit G-12798
City of Klamath Falls
Klamath County, Oregon
Government Lot 8, Section 32, Township 38 South,
Range 9 East (W.M.)

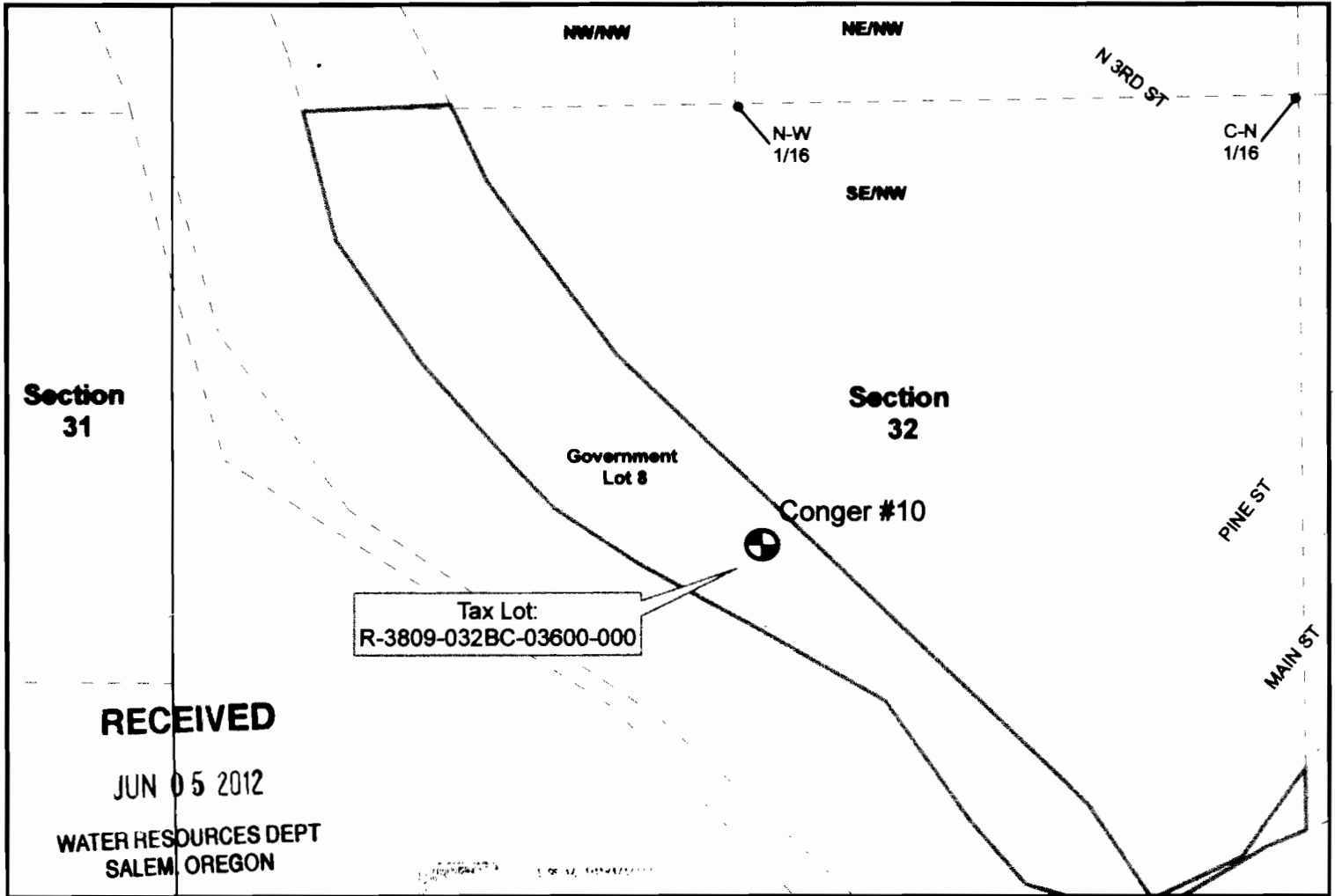

Legend

- Conger Well 10
- Section Line
- 1/4 1/4 Section Line
- Government Lots
- Tax Lot

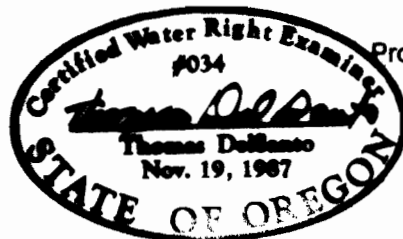

Map Information
 Projection: OCRS Bend-Klamath Falls Zone
 Datum: North American Datum of 1983
 Date: February 27, 2012
 Prepared by: City of Klamath Falls

Data Sources
 City of Klamath Falls

NOTES:

- 1) Water meter is located 12 feet from discharge head inside the well house
- 2) Conveyance System: Refer to the system overview map in Attachment 1.

POA Location Description

Conger #10
 Located 222 Feet North and 1401 Feet East from W 1/4 corner of Section 32, Township 38 South, Range 9 East (W.M.)

Disclaimer
 This map was prepared for the purpose of identifying the location of a water right only and is not intended to provide legal dimensions or location of property ownership lines.



0 400

 1 inch equals 400 feet

Claim of Beneficial Use
 Place of Use Map
 Application G-13336
 Permit G-12798
 City of Klamath Falls
 Klamath County, Oregon

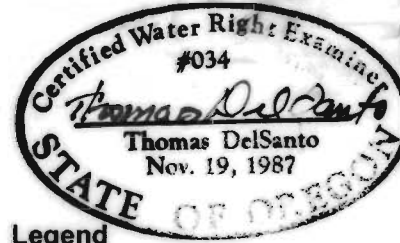

Legend

- Point of Appropriation (POA)
- Place of Use: Permit G-12798

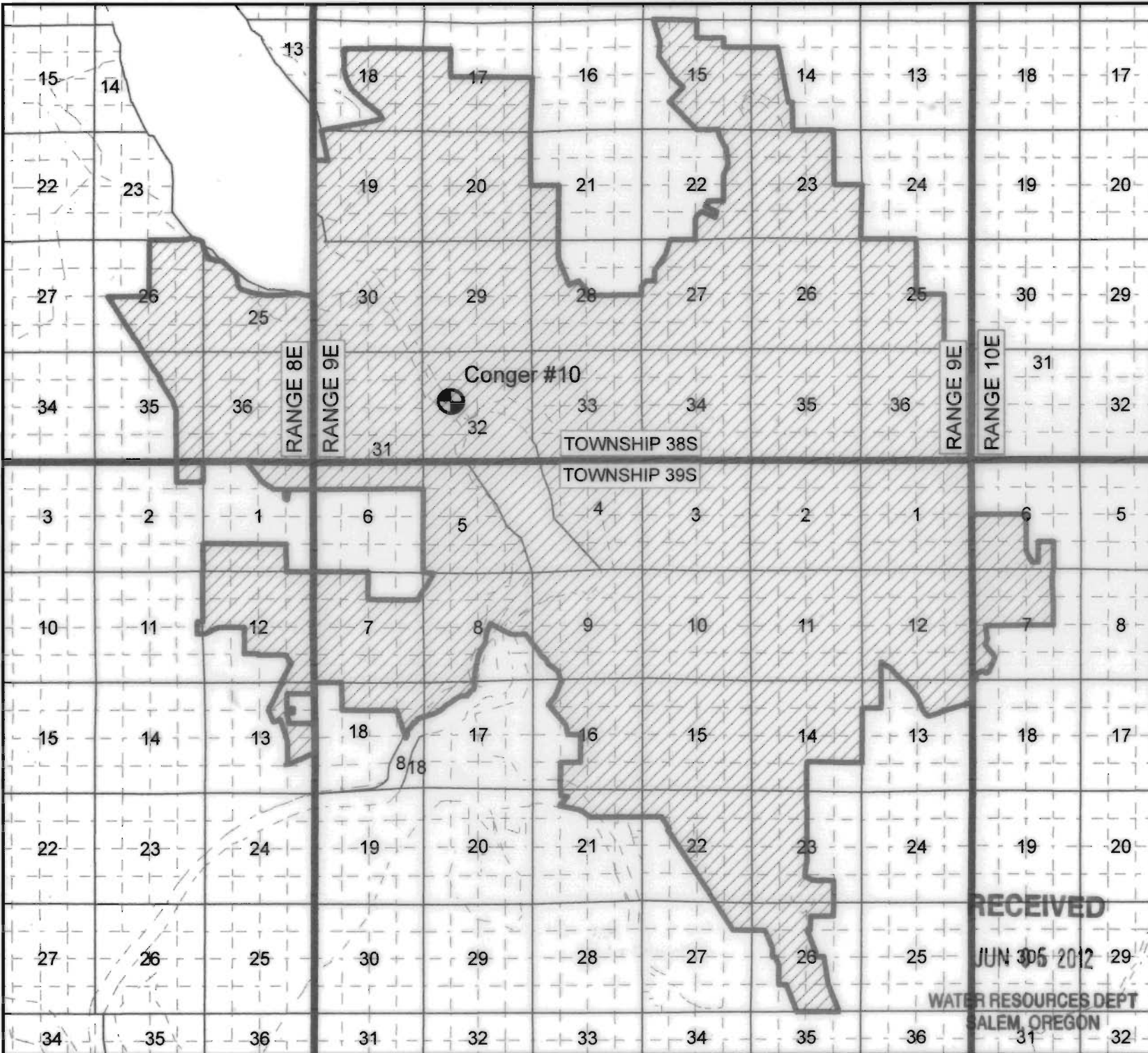

Map Information
 Projection: OCRS Bend-Klamath Falls Zone
 Datum: North American Datum of 1983
 Date: February 27, 2012
 Prepared by: City of Klamath Falls

Data Sources
 City of Klamath Falls

Disclaimer
 This map was prepared for the purpose of identifying the location of a water right only and is not intended to provide legal dimensions or location of property ownership lines.

0 3,250 6,500

1 inch equals 6,500 feet



RECEIVED

JUN 30 2012

WATER RESOURCES DEPT
 SALEM, OREGON

Claim of Beneficial Use
 Place of Use Map
 Application G-13336
 Permit G-12798
 City of Klamath Falls
 Klamath County, Oregon

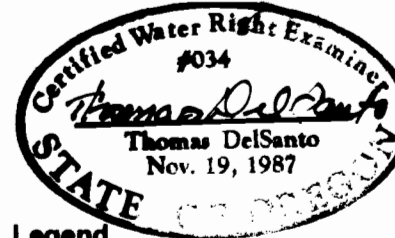

Legend

- Point of Appropriation (POA)
- Place of Use: Permit G-12798

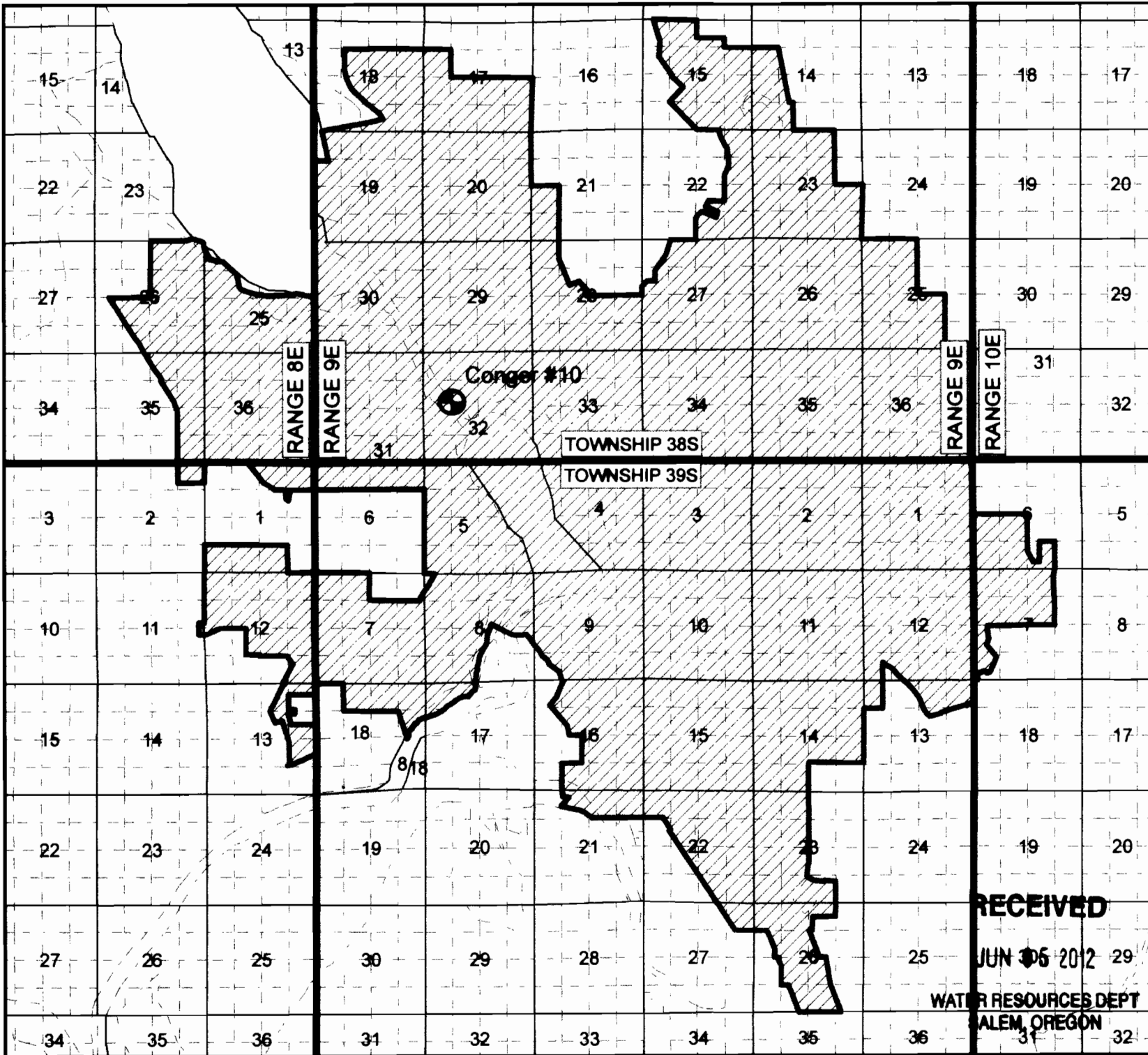

Map Information
 Projection: OCRS Bend-Klamath Falls Zone
 Datum: North American Datum of 1983
 Date: February 27, 2012
 Prepared by: City of Klamath Falls

Data Sources
 City of Klamath Falls

Disclaimer
 This map was prepared for the purpose of identifying the location of a water right only and is not intended to provide legal dimensions or location of property ownership lines.

0 3,250 6,500



1 inch equals 6,500 feet

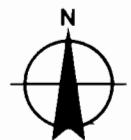

RECEIVED

JUN 05 2012

WATER RESOURCES DEPT
 SALEM, OREGON