

T.6S. R.2W. W.M.

MARION COUNTY

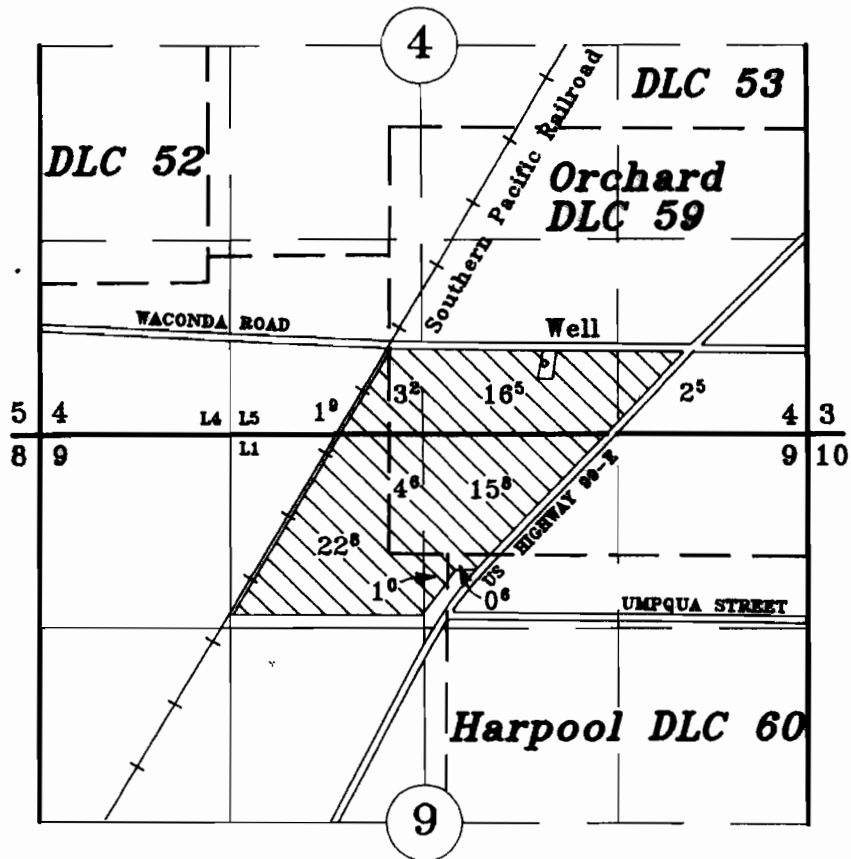

WELL LOCATION: 1361' North and 735' East of ^{NW} NE Corner of William P. Harpool
DLC 60 as projected in Section 9.

Application No. G-9357 Permit No. G-8635 Transfer No. T-7608

FINAL PROOF SURVEY

IN NAME OF

Lisa McKay

AUGUST 14, 1998

SCALE 1" = 1320'

NOTE: This map is for the purpose of identifying the location of water rights and has not intent to dimension or locate property ownership lines.

