

RECEIVED

APR 15 1999

WATER RESOURCES DEPT
SALEM, OREGON

T. 6S. R. 1W., W.M.

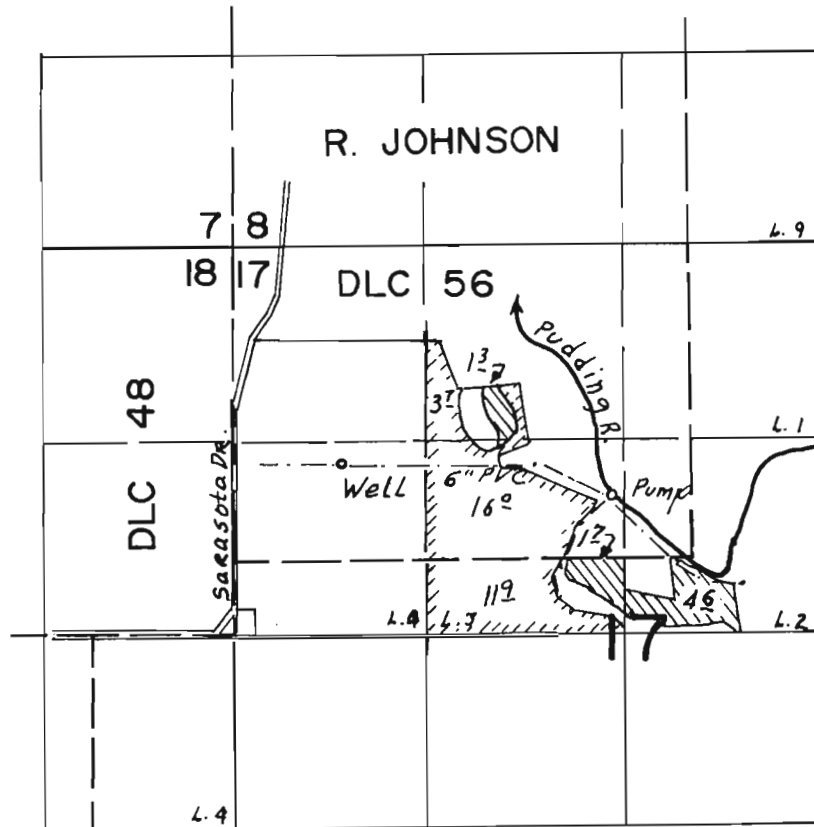

Scale
4" = 1 Mi.

Well Located 1470' S & 740' E FROM NW COR. Sec. 17

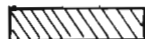
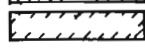
 Primary
 Supplemental

FINAL PROOF SURVEY UNDER

Application No. ~~G-13314~~ Permit No. ~~G-11961~~
IN NAME OF

SEIFER BROTHERS.....

Surveyed April 6, 1999, by

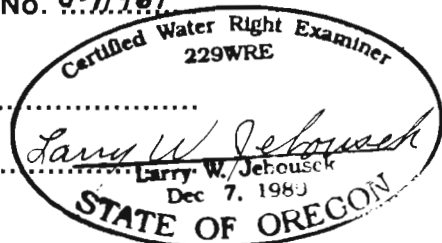

THIS MAP WAS PREPARED FOR THE PURPOSE OF IDENTIFYING THE LOCATION OF A WATER RIGHT ONLY AND IS NOT INTENDED TO PROVIDE LEGAL DIMENSIONS OR LOCATION OF PROPERTY OWNERSHIP LINES.