

**LEGEND**

- Place of Use (POU)
- Water Service Area
- Water Mainlines
- Major Roads
- Watercourses
- Waterbodies

**DISCLAIMER:**

This map was prepared for the purpose of identifying the location of a water right only and it is not intended to provide legal dimensions or location of property ownership lines.

**RECEIVED**

OCT 15 2012

WATER RESOURCES DEPT  
SALEM, OREGON

**Certified Water Rights Examiner Stamp**

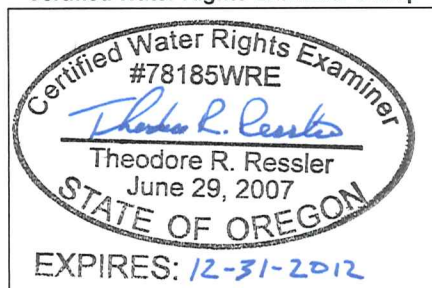

**Claim of Beneficial Use Place of Use Map  
Water Right in the Name of City of Salem**

**Transfer T-3999 (North Santiam River Decree)**  
Townships 6, 7, & 8 South, Ranges 2 & 3 West (W.M.)

**MAP NOTES:**

Date: May 30, 2012  
Data Sources: City of Salem, Marion Co GIS, OGIC, ESRI

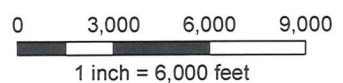



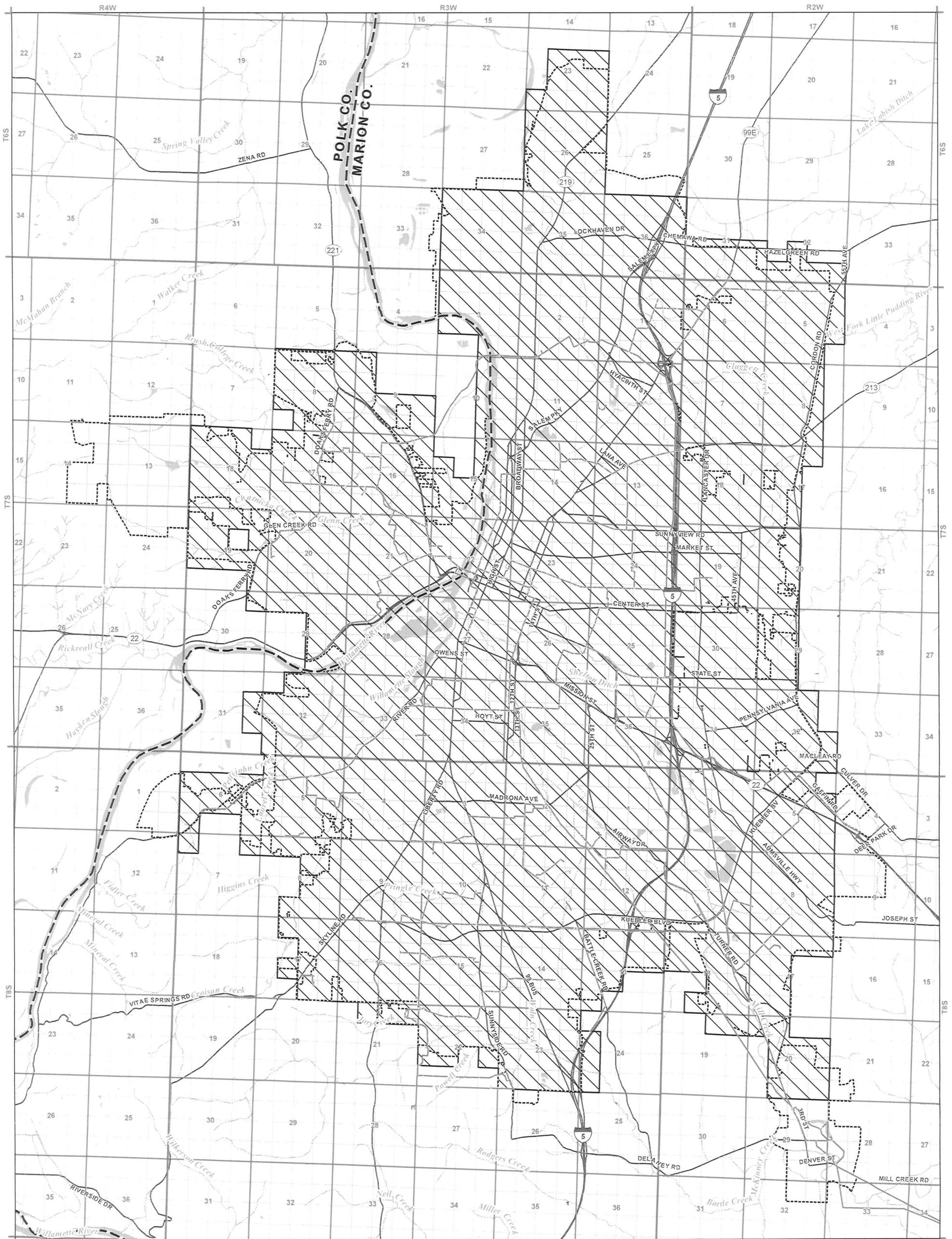

**LEGEND**

- Place of Use (POU)
- Water Service Area
- Water Mainlines
- Major Roads
- Watercourses
- Waterbodies

**DISCLAIMER:**

This map was prepared for the purpose of identifying the location of a water right only and it is not intended to provide legal dimensions or location of property ownership lines.

**RECEIVED**  
 OCT 15 2012  
 WATER RESOURCES DEPT  
 SALEM, OREGON

**Certified Water Rights Examiner Stamp**

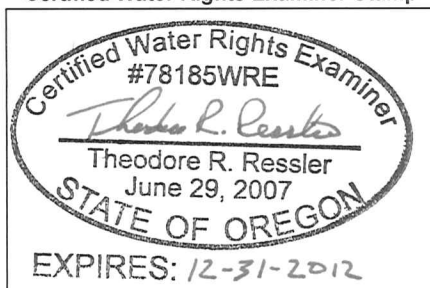

**Claim of Beneficial Use Place of Use Map  
 Water Right in the Name of City of Salem**

**Transfer T-3999 (North Santiam River Decree)**  
 Townships 6, 7, & 8 South, Ranges 2 & 3 West (W.M.)

**MAP NOTES:**

Date: May 30, 2012  
 Data Sources: City of Salem, Marion Co GIS, OGIC, ESRI

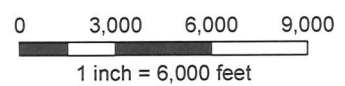

# Claim of Beneficial Use Point of Diversion Map

Transfer T-3999 (North Santiam River Decree)  
Section 13, Township 9 South, Range 1 West (W.M.)

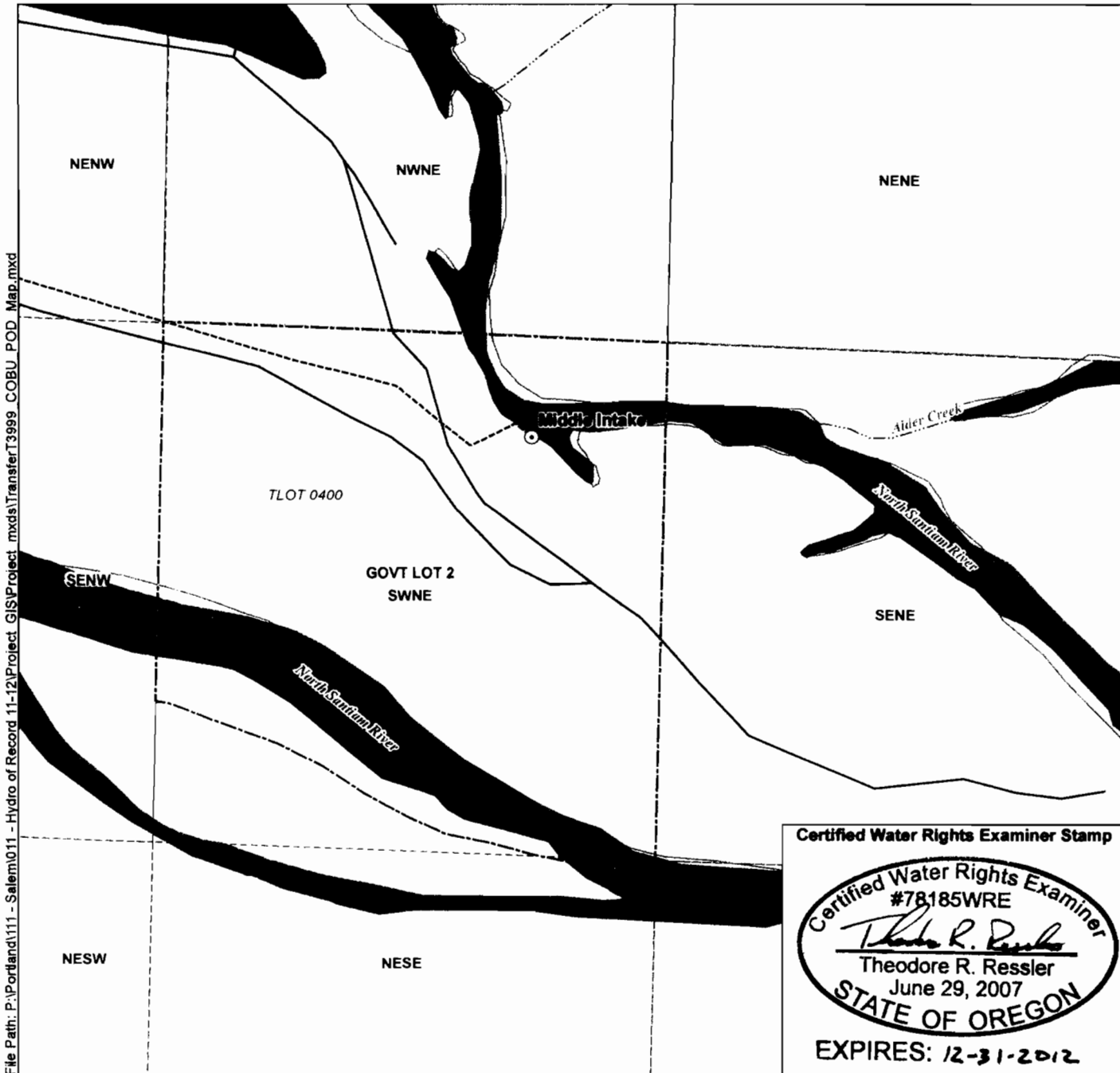

**LEGEND**

- Point of Diversion (POD)
- South Intake Channel
- Government Lots
- ⊕ Tax Lots
- Roads
- ~ Watercourses
- Waterbodies

**POD Location Descriptions**

**Middle Intake**  
 210 feet South and 310 feet West from the NE corner of the SW1/4 NE1/4 of Section 13, Township 9 South, Range 1 West (W.M.)

**Disclaimer**  
 This map was prepared for the purpose of identifying the location of a water right only and it is not intended to provide legal dimensions or location of property ownership lines.

**Map Notes**  
 Date: October 5, 2012  
 Data Sources: City of Salem, Marion Co GIS, OGIC, ESRI  
 Prepared By: GSI Water Solutions, Inc.

