

724

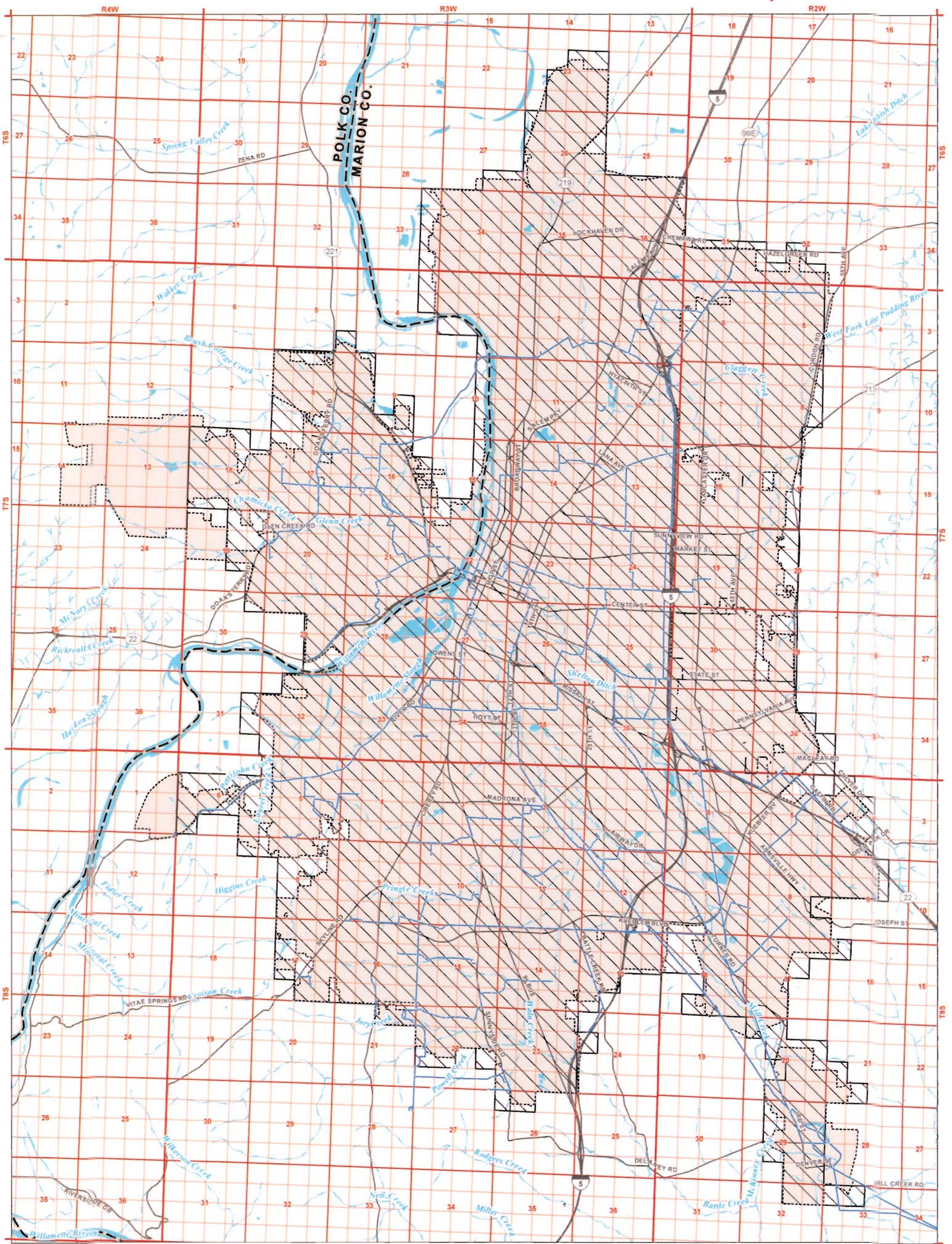

LEGEND

- Place of Use (POU)
- Water Mainlines
- Water Service Area
- Major Roads
- Watercourses
- Waterbodies

DISCLAIMER:

This map was prepared for the purpose of identifying the location of a water right only and it is not intended to provide legal dimensions or location of property ownership lines.

RECEIVED
 OCT 15 2012
 WATER RESOURCES DEPT
 SALEM, OREGON

Certified Water Rights Examiner Stamp

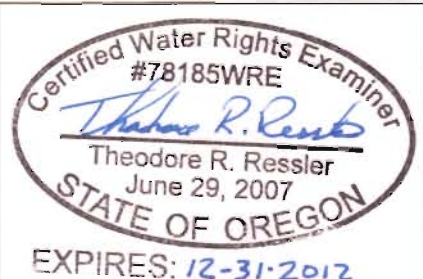

**Claim of Beneficial Use Place of Use Map
Water Right in the Name of City of Salem**

**Transfer T-5476 (North Santiam River Decree)
Townships 6, 7, & 8 South, Ranges 2 & 3 West (W.M.)**

MAP NOTES:
Date: May 30, 2012
Data Sources: City of Salem, Marion Co GIS, OGIC, ESRI

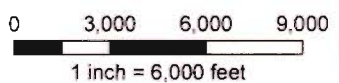

COBU MAP 724

Claim of Beneficial Use Point of Diversion Map

Transfer T-5476 (North Santiam River Decree)
Section 13, Township 9 South, Range 1 West (W.M.)

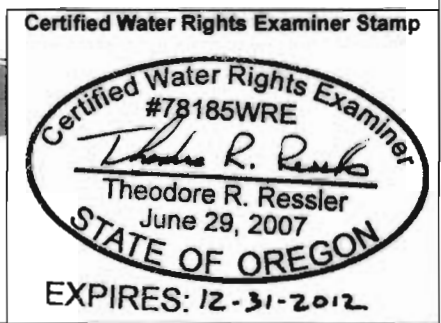
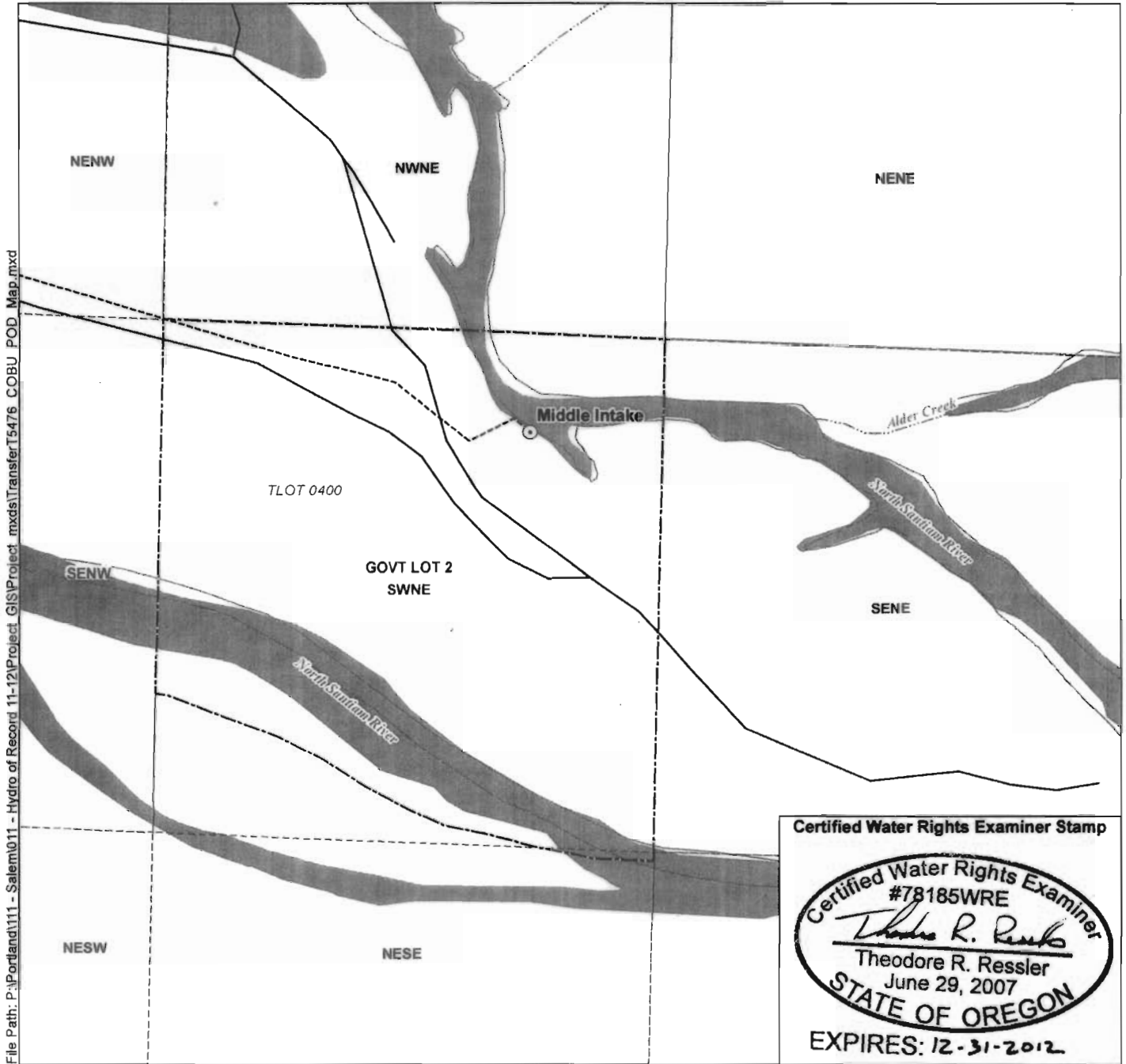

LEGEND

- Point of Diversion (POD)
- South Intake Channel
- Government Lots
- Tax Lots
- Roads
- Watercourses
- Waterbodies

POD Location Descriptions

Middle Intake
210 feet South and 310 feet West from the NE corner of the SW1/4 NE1/4 of Section 13, Township 9 South, Range 1 West (W.M.)

Disclaimer

This map was prepared for the purpose of identifying the location of a water right only and it is not intended to provide legal dimensions or location of property ownership lines.

Map Notes

Date: October 5, 2012
Data Sources: City of Salem, Marion Co GIS, OGIC, ESRI
Prepared By: GSI Water Solutions, Inc.

