

CLAIM OF BENEFICIAL USE  
 FOR: DAVID BERGER  
 BY: DUANE W. KIRBY  
 DATE: 10/27/03  
 T26S, R3W, W.M.  
 SECTION 19  
 TAXLOT 1100  
 T-7782

**RECEIVED**

OCT 31 2003

WATER RESOURCES DEPT.  
 SALEM, OREGON

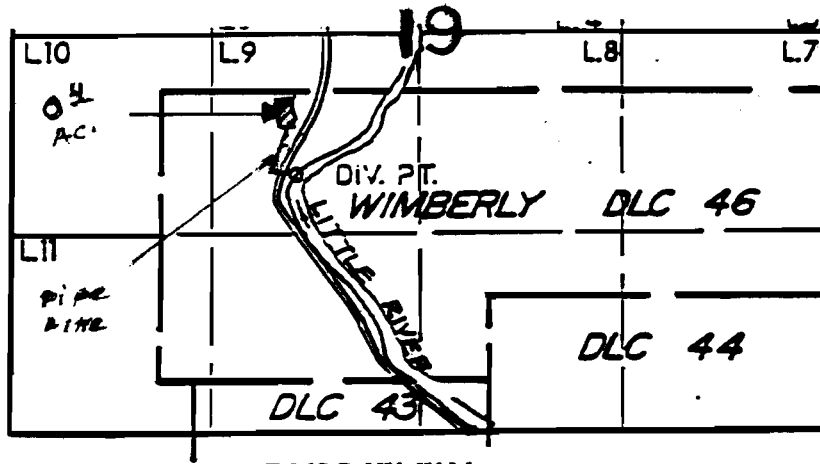
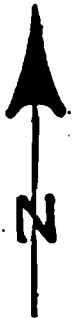

T.26S,R.3W.,W.M.

DIV. PT. IS LOCATED 3600' S. & 3425' W. FROM NE COR. SEC. 19.

SCALE: 4" = 1 MILE

THE PURPOSE OF THIS MAP IS TO IDENTIFY THE LOCATION OF THE WATER RIGHT. IT IS NOT INTENDED TO PROVIDE INFORMATION RELATIVE TO THE LOCATION OF PROPERTY OWNERSHIP BOUNDARY LINES.

