

CLAIM OF BENEFICIAL USE

APPLICATION G-14589 PERMIT G-13453
 APPLICATION R-83524 PERMIT R-12505
 APPLICATION S-83523 PERMIT S-53431

IN THE NAME OF BURGUNDY HARVEST FARM, INC.
 TOWNSHIP 32 SOUTH, RANGE 15 WEST, W.M.
 CURRY COUNTY OREGON

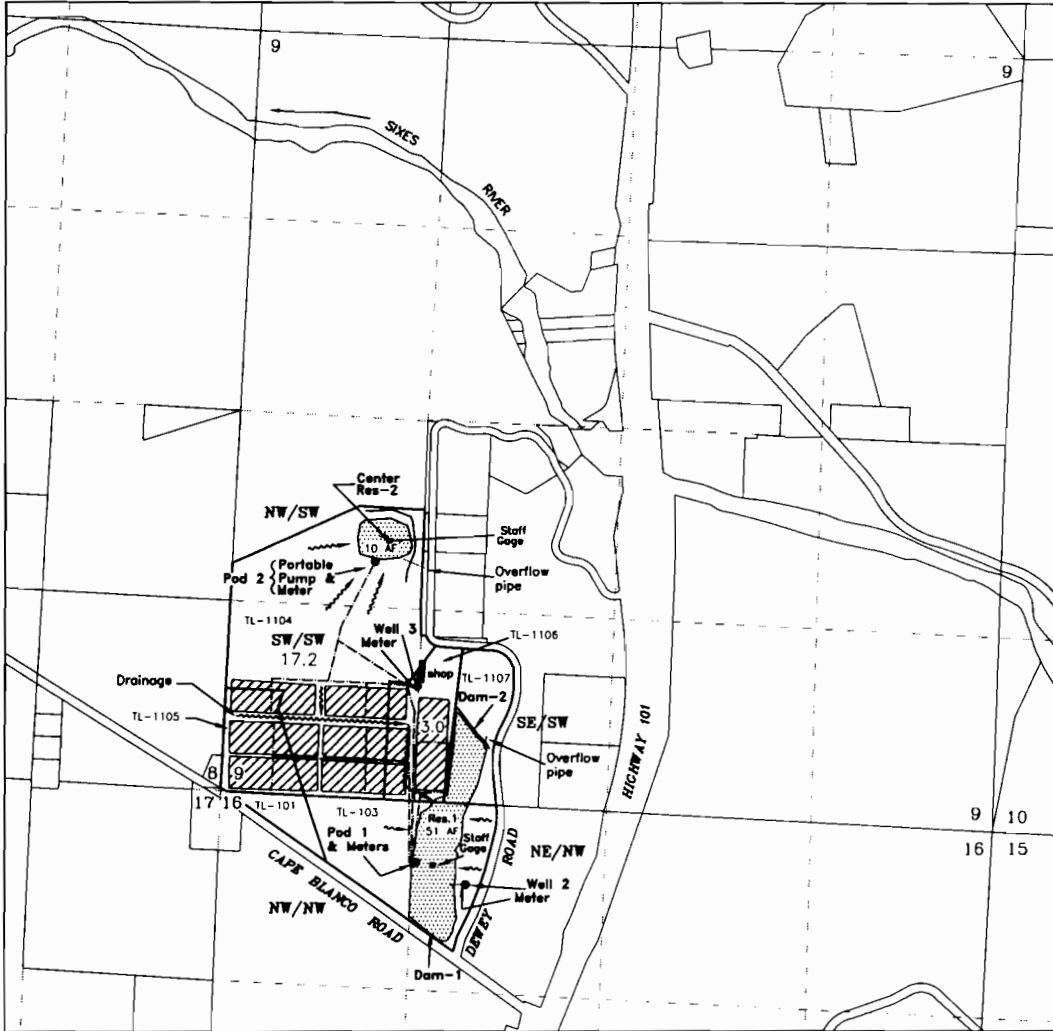

Dam-1	NE/NW Sec. 16	820 feet South & 1480 feet East
Dam-2	SE/SW Sec. 9	510 feet North & 1710 feet East
Center Res-2	NW/SW Sec. 9	1800 feet North & 1030 feet East
POD-1	NE/NW Sec. 16	420 feet South & 1350 feet East
POD-2	NW/SW Sec. 9	1620 feet North & 975 feet East
Well-2	NE/NW Sec. 16	560 feet South & 1700 feet East
Well-3	SW/SW Sec. 9	790 feet North & 1310 feet East

All from the SW corner of Section 9, T.32S, R.15W, W.M.

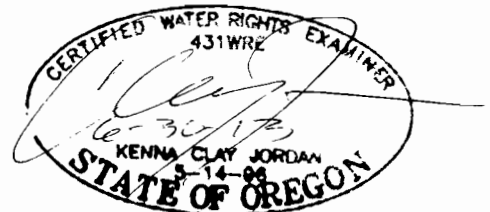

- Drainage
- R-12505 - 61.0 Acre-Feet
- G-13453 - 20.2 acres, Cranberry Operations
- S-53431 - 20.2 acres, Supplemental Cranberry Operations

Base map - Curry County GIS with 2005
 FSA aerial photo overlay & 8/2/2012
 Google aerial for assumed best fit

This map is not intended to provide legal dimensions
 or locations of property ownership lines

Mapped from field inspections
 July 20, 2010 & April 19, 2012

JORDAN ENGINEERING
 460 JORDAN LANE
 ROSEBURG, OR 97471
 (541) 673-1931

Drawn 9/6/2010 n.e.d.
 Revised (2) 12/13/2012 n.e.d.