

# FINAL PROOF SURVEY MAP

IN THE NAME OF DELMER C. AND SUSAN M. ROBISON

PERMIT R-4792  
31586

TRANSFER T-6668  
T-6669

SECTION 12, TOWNSHIP 30 SOUTH, RANGE 15 WEST, W.M.

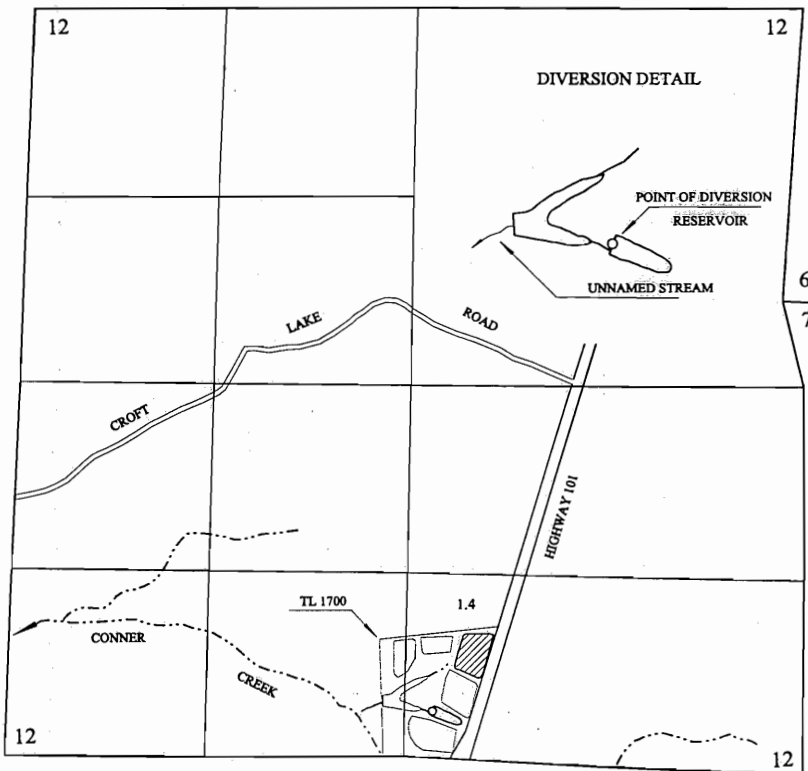

THE POINT OF DIVERSION IS LOCATED 310 FEET NORTH AND 200 FEET EAST FROM THE SOUTH QUARTER CORNER OF SECTION 12, BEING WITHIN THE SW $\frac{1}{4}$ SE $\frac{1}{4}$  OF SECTION 12, WITHIN SECTION 12, TOWNSHIP 30 SOUTH, RANGE 15 WEST, W.M.; COOS COUNTY.

**RECEIVED**

SEP 14 2000

WATER RESOURCES DEPT.  
SALEM, OREGON

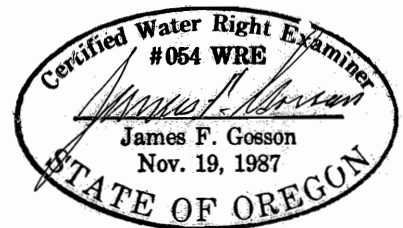

THE PURPOSE OF THIS MAP IS TO IDENTIFY THE LOCATION OF THE WATER RIGHT.  
IT IS NOT INTENDED TO PROVIDE INFORMATION RELATIVE TO THE LOCATION OF  
PROPERTY OWNERSHIP BOUNDARY LINES.