

CLAIM OF BENEFICIAL USE
TRANSFER T-6802
FOR JOHN & EDNA WILKEN
SURVEYED BY DUANE KIRBY
FEBRUARY 5, 2002
T24S,R7W,W.M.
SECTION 3
DOUGLAS COUNTY
SCALE 1" = 400'

POINT OF DIVERSION: 2210 FEET NORTH AND 1580 FEET WEST FROM THE SE CORNER, SECTION 3

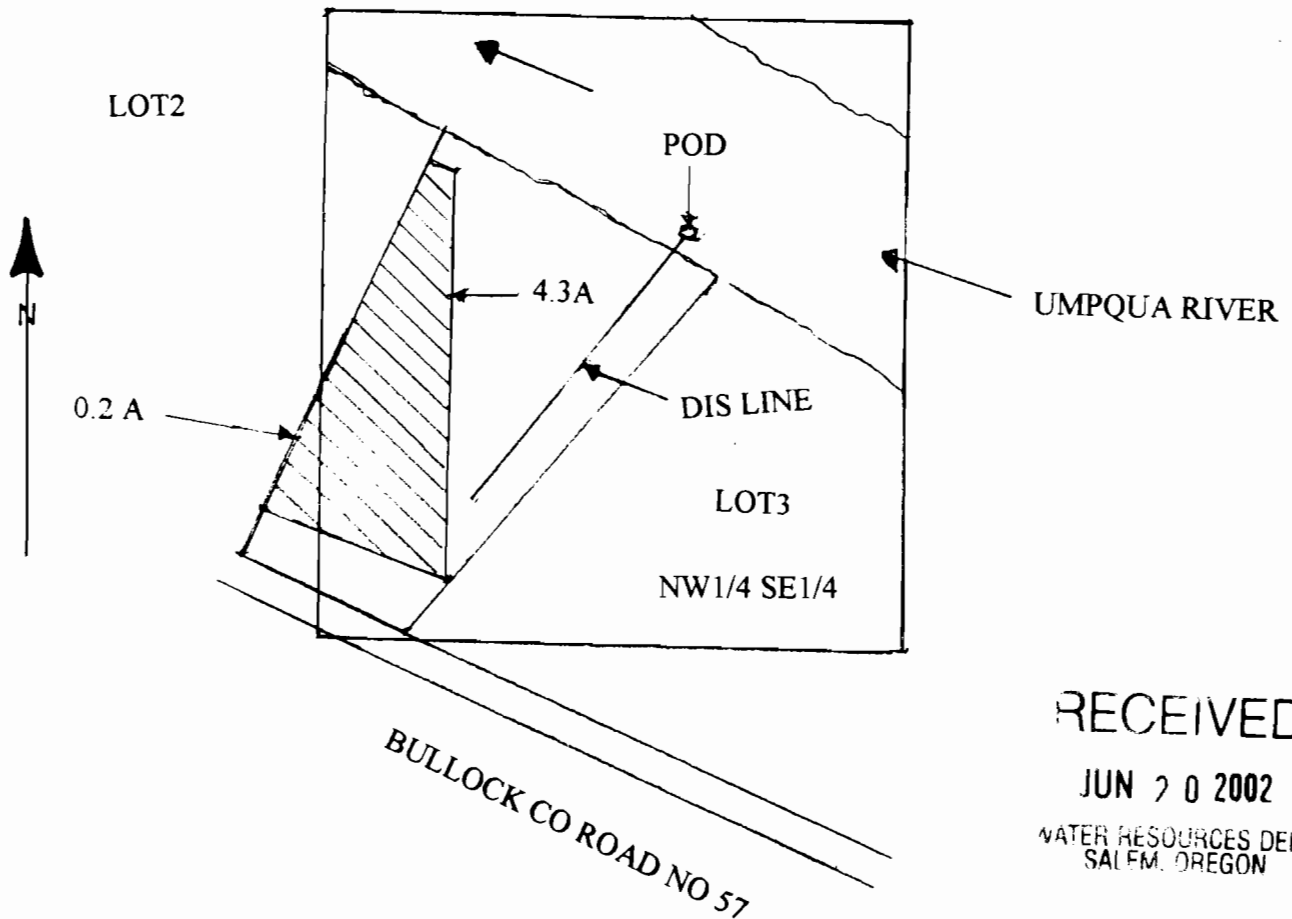

RECEIVED

JUN 20 2002

WATER RESOURCES DEPT
SALEM, OREGON

THE PURPOSE OF THIS MAP IS TO IDENTIFY THE LOCATION OF THE WATER RIGHT. IT IS NOT INTENDED TO PROVIDE INFORMATION RELATIVE TO THE LOCATION OF PROPERTY OWNERSHIP BOUNDARY LINES.

