

FINAL PROOF SURVEY MAP

IN THE NAME OF SEA WIND FARMS, INC.

SECTION 21, T 31 S, R 15 W, W.M.

PERMIT No. 46806

CERTIFICATE No. 67225

TRANSFER No. 7215

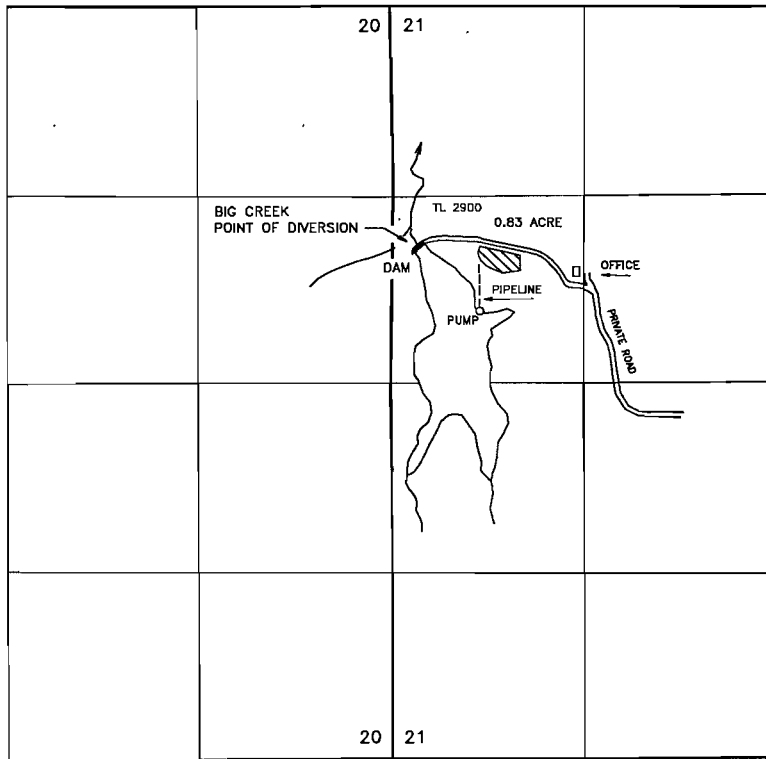

RECEIVED

SEP 03 1987

FOR YOUR RETAIN
IN DEPT. AGRIC.

THE AUTHORIZED POINT OF DIVERSION IS THE BIG CREEK DAM LOCATED 1,640 FEET SOUTH AND 200 FEET EAST FROM THE NORTHWEST CORNER OF SECTION 21, BEING WITHIN THE SW $\frac{1}{4}$ NW $\frac{1}{4}$ OF SECTION 21, TOWNSHIP 31 SOUTH, RANGE 15 WEST, W.M.; CURRY COUNTY.

THE RESERVOIR PUMP IS LOCATED 2,105 FEET SOUTH AND 605 FEET EAST FROM THE NORTHWEST CORNER OF SECTION 21, BEING WITHIN THE SW $\frac{1}{4}$ NW $\frac{1}{4}$ OF SECTION 21, TOWNSHIP 31 SOUTH, RANGE 15 WEST, W.M.; CURRY COUNTY.

THE PURPOSE OF THIS MAP IS TO IDENTIFY THE LOCATION OF THE WATER RIGHT. IT IS NOT INTENDED TO PROVIDE INFORMATION RELATIVE TO THE LOCATION OF PROPERTY OWNERSHIP BOUNDARY LINES.

