

T.9S., R.3W., W.M.

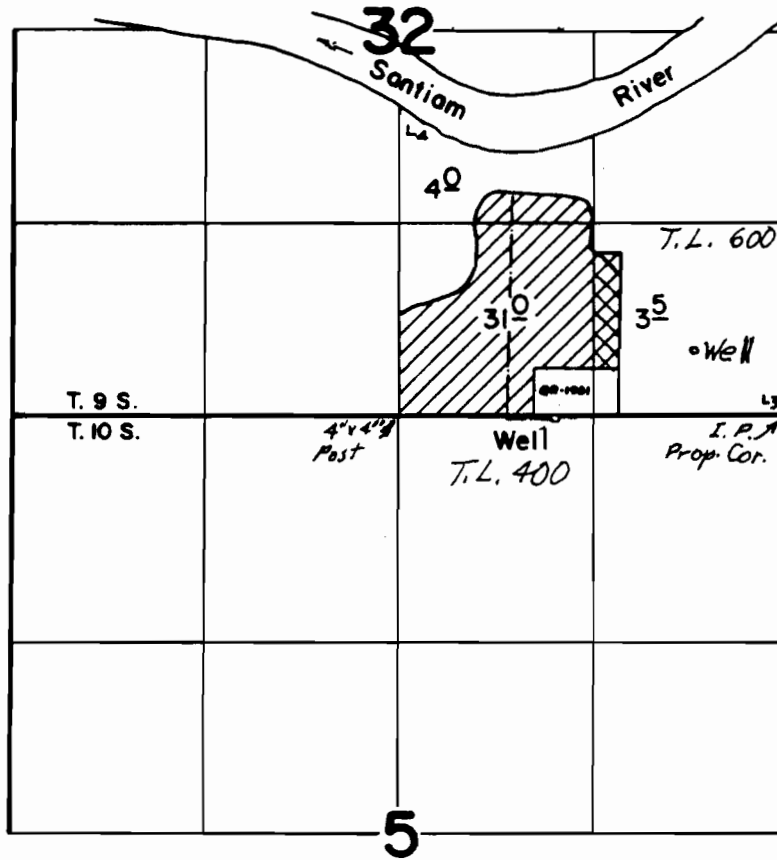

FROM: WELL LOC: 1580' W. & 20' S. FROM N.E. COR. SEC. 5
 TO: " " : 620' W & 440' N " " " " "

FINAL PROOF SURVEY UNDER

TRANSFER NO. T-7464
 Application No. Permit No.
 IN NAME OF

DWIGHT E. LAMBET

Surveyed DEC. 29 1999, by

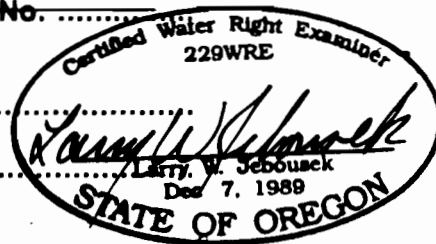

THIS MAP WAS PREPARED FOR THE PURPOSE OF IDENTIFYING THE LOCATION OF A WATER RIGHT ONLY AND IS NOT INTENDED TO PROVIDE LEGAL DIMENSIONS OR LOCATION OF PROPERTY OWNERSHIP LINES.