

T6N, R35E, S24, WM  
E1/2 of SW1/4  
Umatilla County

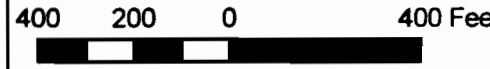

The purpose of this map is to identify the location of a water right. It is not intended to provide information regarding the location of property ownership boundary lines.

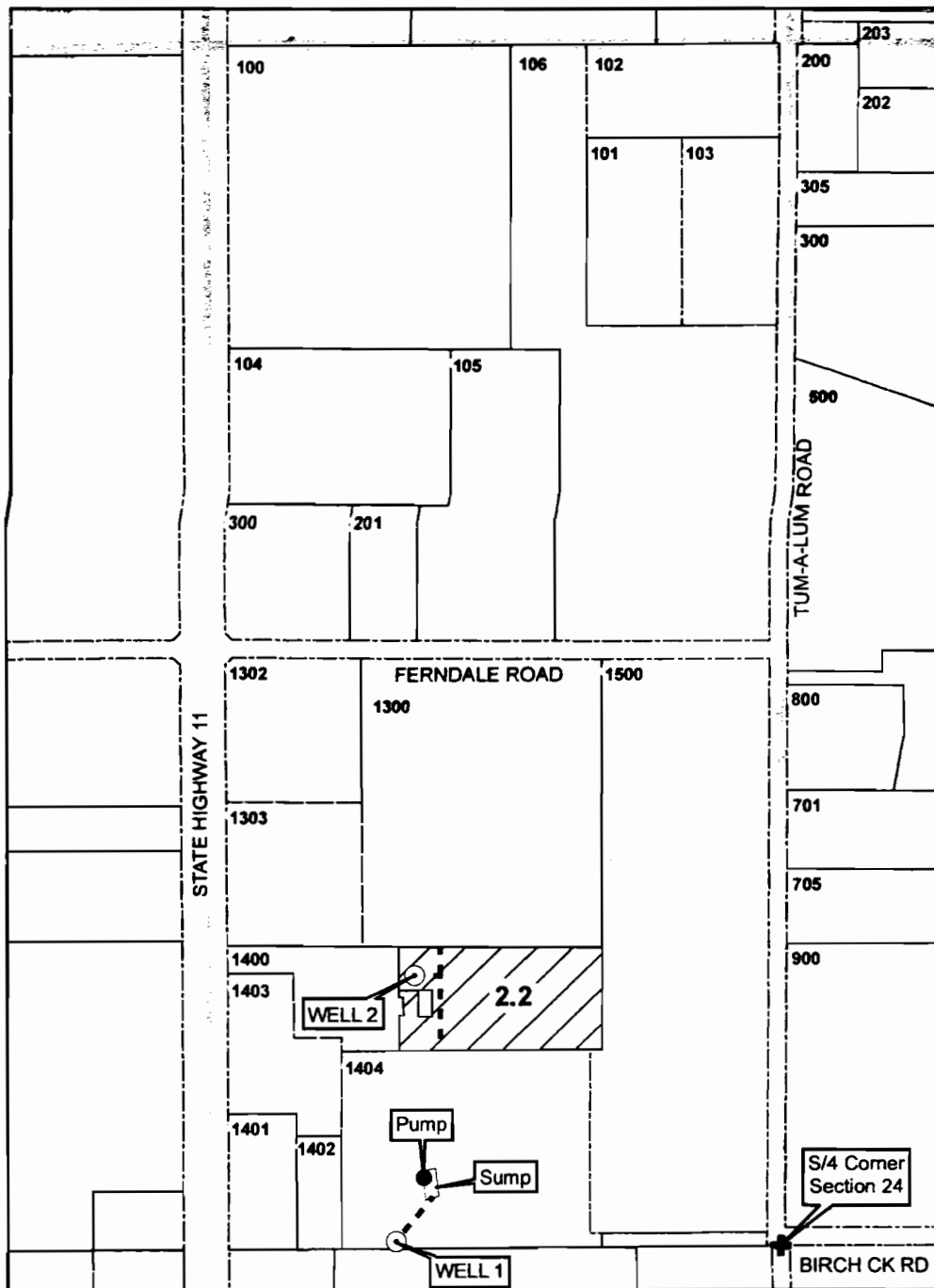

FOUNTAINHEAD  
1860 Blue Creek Road  
Walla Walla, WA 99362  
509.529.2646 phone

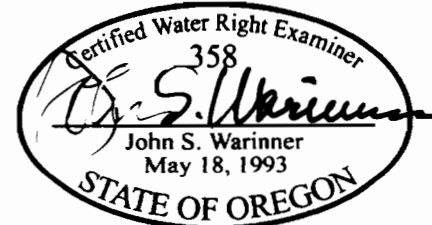

**CLAIM OF BENEFICIAL USE MAP**  
Transfer 8629

in the name of  
DANIEL HUMBERT

Revised 17 JUN 2008

⊙ **Authorized POA**

Well 1 (original well) is located in the SE/4 of SW/4, Section 24, T6N, R35E, WM, at a distance 0 feet N and 860 feet W from S/4 Corner of Section 24. Well log UMAT 4492.

Well 2 (new well) is located in the SE/4 of SW/4, Section 24, T6N, R35E, WM, at a distance 580 feet N and 830 feet W from S/4 Corner of Section 24. Well log UMAT 6050.

----- **Conveyance**

Buried mainlines (3-inch) distribute water from well throughout places of use.

 **Authorized POU**

Water beneficially used for irrigation of 2.2 acres (fruit orchard and grass) and for industrial use for gravel and asphalt processing in SE/4 of SW/4, Section 24, T6N, R35E, WM. Irrigation water applied with solid-set sprinkler systems.