

CLAIM OF BENEFICIAL USE
 FOR: CHRISTOPHER ARCHULETA
 LOURIE ARCHULETA
 BY: DUANE W. KIRBY
 DATE: SEPTEMBER 12, 2006
 T28S, R4W, W.M.
 SECTION 23
 APPLICATION TRANSFER NO T-9390
 SCALE : 1" = 1320'

RECEIVED

SEP 25 2008

WATER RESOURCES DEPT
 SALEM, OREGON

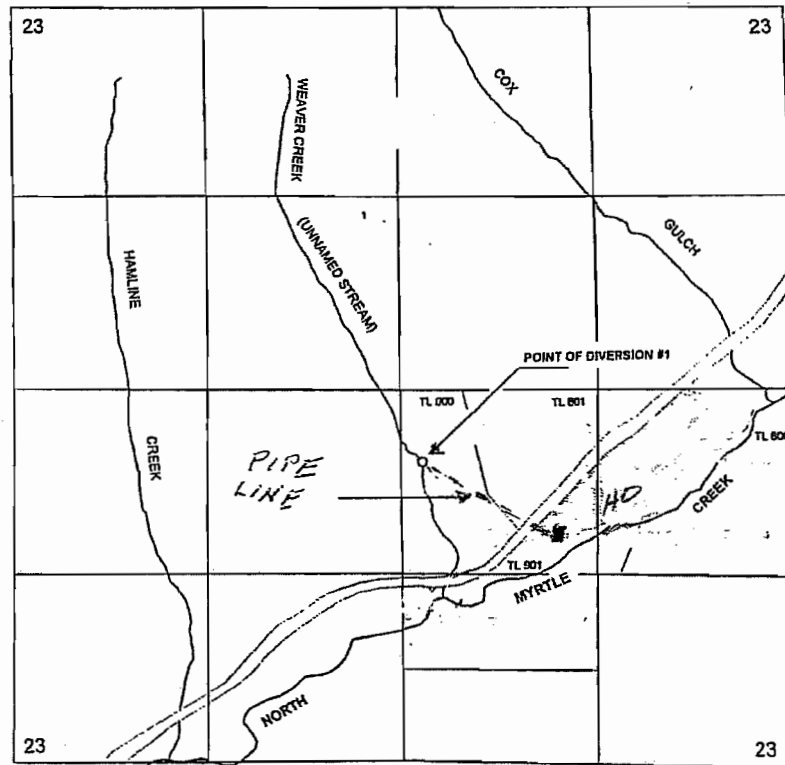

POD NO 1 450' S AND 2580' W
 FROM E ¼ CORNER, SECTION 23

THE PURPOSE OF THIS MAP IS TO
 IDENTIFY THE LOCATION OF THE
 WATER RIGHT. IT IS NOT INTENDED
 TO PROVIDE INFORMATION RELATIVE
 TO THE LOCATION OF PROPERTY
 OWNERSHIP BOUNDARY LINES.

