

RECEIVED

T. 16S. R. 4 W. W.M.

AUG 17 1999

WATER RESOURCES DEPT
SALEM, OREGON

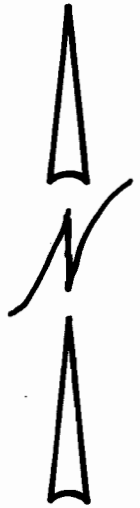
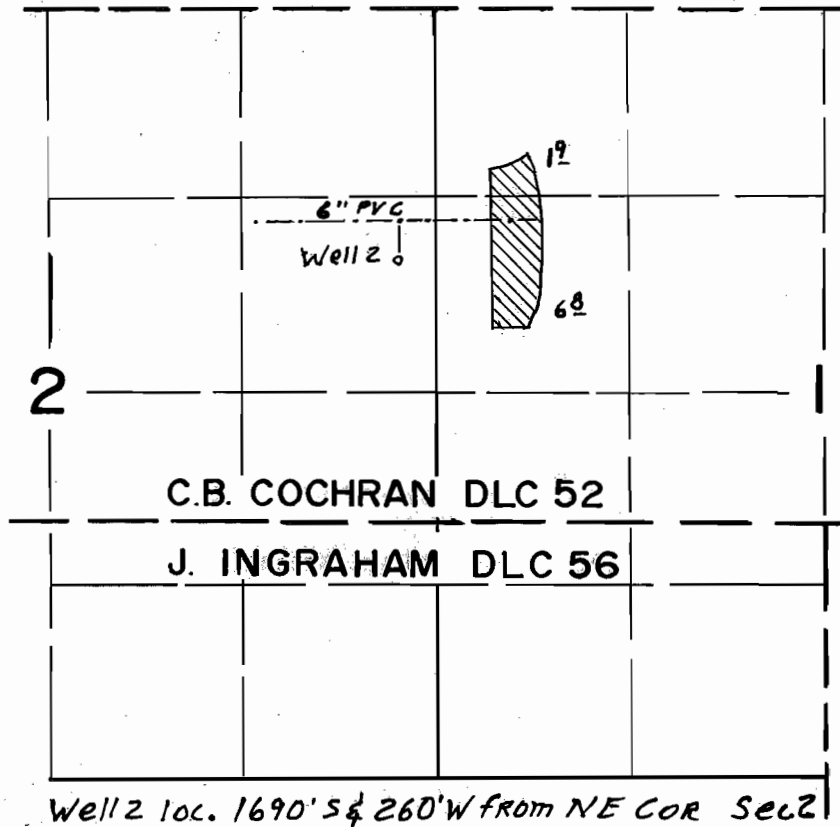

Scale
4" = 1 Mi.

FINAL PROOF SURVEY
UNDER

TRANSFER NO. T-7231

Application No. _____ Permit No. _____

IN NAME OF

HAYWORTH FARMS, INC.

Surveyed JUNE 9, 1999, by

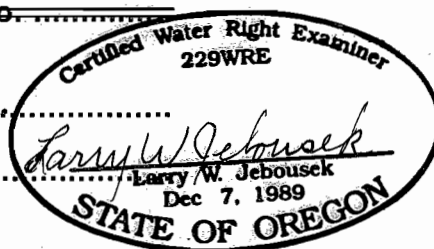

THIS MAP WAS PREPARED FOR THE PURPOSE OF IDENTIFYING THE LOCATION OF A WATER RIGHT ONLY AND IS NOT INTENDED TO PROVIDE LEGAL DIMENSIONS OR LOCATION OF PROPERTY OWNERSHIP LINES.