

# CLAIM OF BENEFICIAL USE

## TRANSFER T-11053

IN THE NAME OF: CAROLYN F. STRIPE

TOWNSHIP 35 SOUTH RANGE 6 WEST, W.M.

JOSEPHINE COUNTY OREGON

**RECEIVED**

OCT 11 2011

WATER RESOURCES DEPT  
SALEM, OREGON

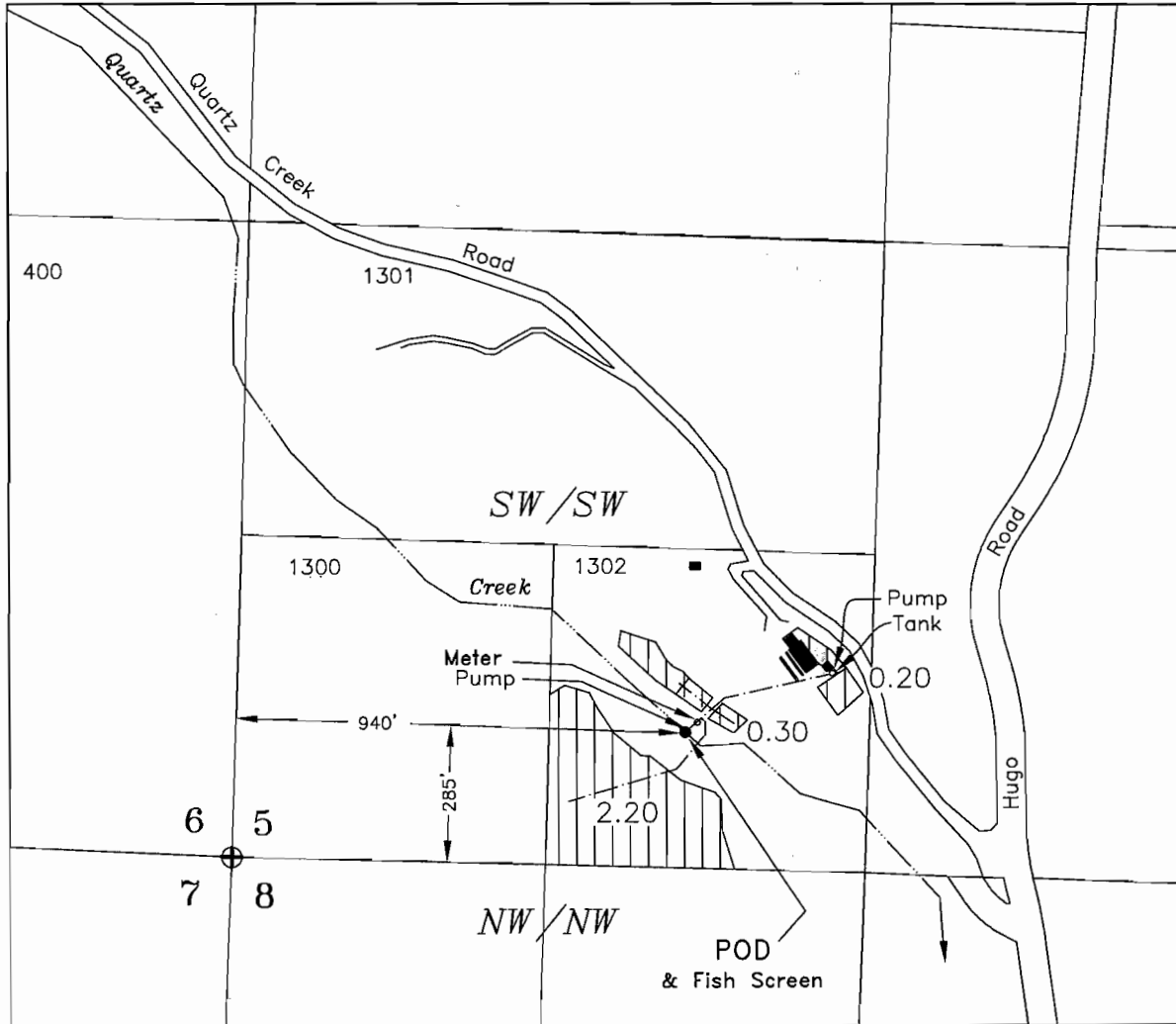

⊕ SW Corner Section 5



Irrigation - 2.7 acres

Base map from Josephine County GIS over 2005 FSA aerial photo for assumed best fit

Mapped from field inspection  
September 16 & 20, 2011

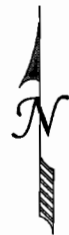
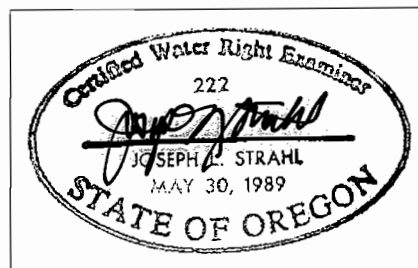

Scale  
1 inch = 400 feet

9/20/2011 n.e.d.

This map is not intended to provide legal dimensions or locations of property ownership lines