

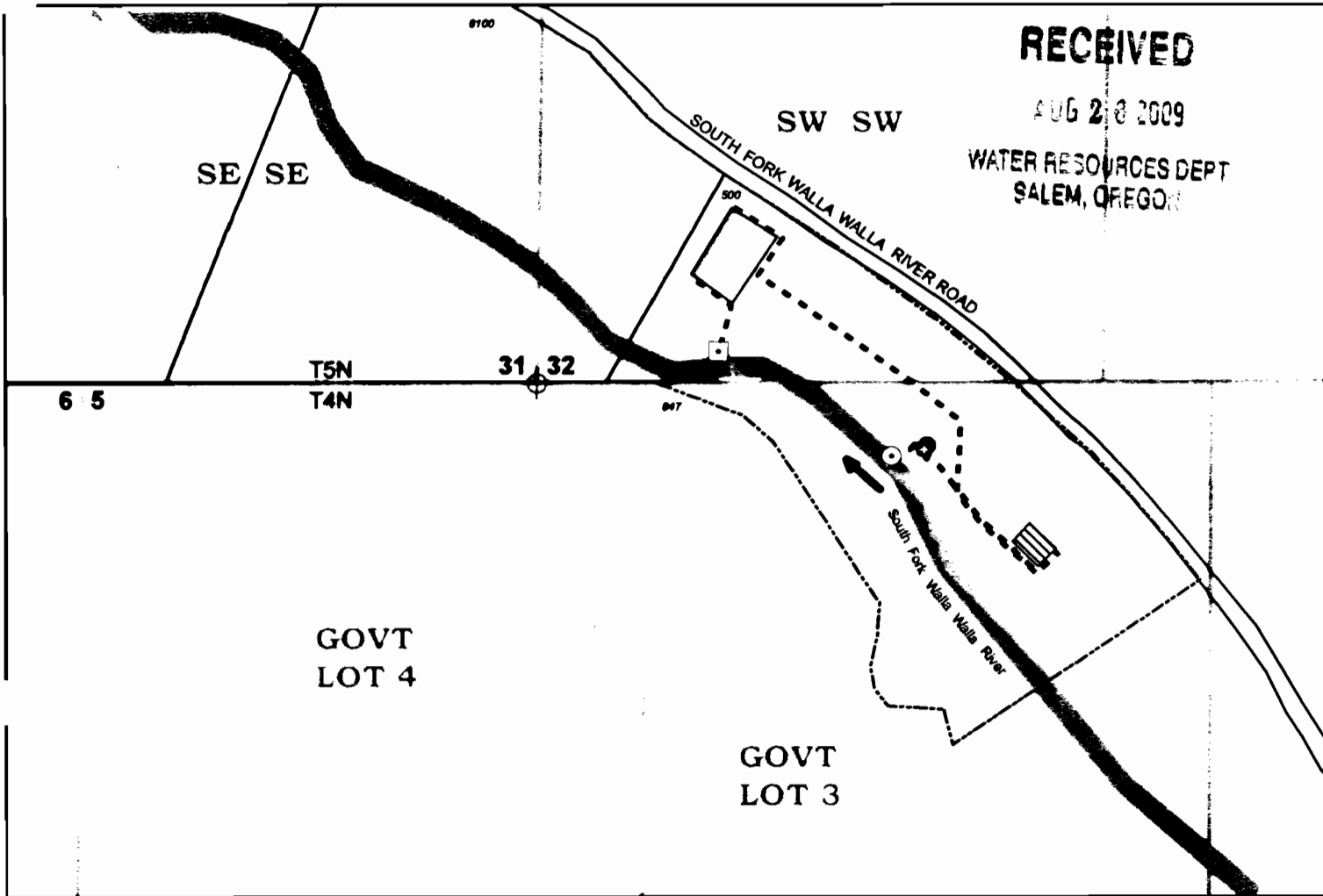

Section 5, T4N, R37E, WM
Section 32, T5N, R37E, WM
Umatilla County

1 inch = 400 feet

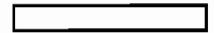

⊙ **Point of Diversion**

Headgate with fish screen located in NE/4 of NW/4 of Section 5, about 162 feet S and 837 feet E from SW Corner of Section 32.

⊙ **Pumps**

Two 200 horsepower turbine pumps located in building. One pump operated at a time.

--- **Conveyance**

Water conveyed from South Fork Walla Walla River to pump station via short reach of open ditch.

Water conveyed from pump station to rearing raceways via buried mainline (24-inch).

Water conveyed from rearing raceways to settling pond and outfall via buried mainline (24-inch).



Raceways

Used to hold/rear and spawn adult Spring Chinook salmon in NE/4 of NW/4 of Section 5.



Settling Pond

Used to treat water prior to discharge to river.



Weir and Outfall

Measurement weir at outfall to South Fork Walla Walla River.

The purpose of this map is to identify the location of a water right. It is not intended to provide information regarding the location of property ownership boundary

FOUNTAINHEAD
1204 Alvarado Terrace
Walla Walla, WA 99362
509.529.2646 phone

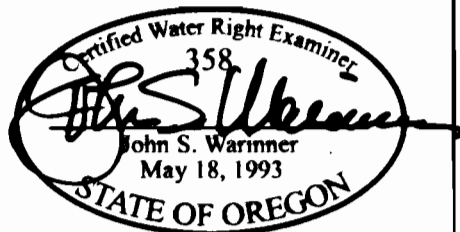

**CLAIM OF BENEFICIAL USE
Transfer 7483**

in the name of
BONNEVILLE POWER ADMIN

Revised 02 DEC 2008