

CLAIM OF BENEFICIAL USE MAP

TRANSFER T-10947

FOR

MEREDITH LOWRY
180 VAN NESS AVENUE
ASHLAND, OR 97520

RECEIVED BY OWRD

SEP 19 2012

SALEM OR

SITUATED IN
SECTIONS 4 & 9, TOWNSHIP 39 SOUTH, RANGE 1 EAST, W.M. JACKSON COUNTY, OREGON

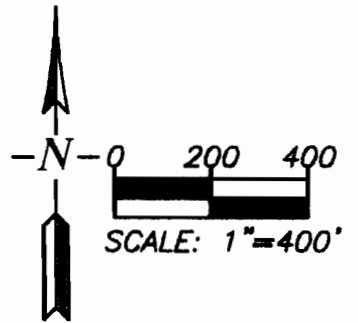
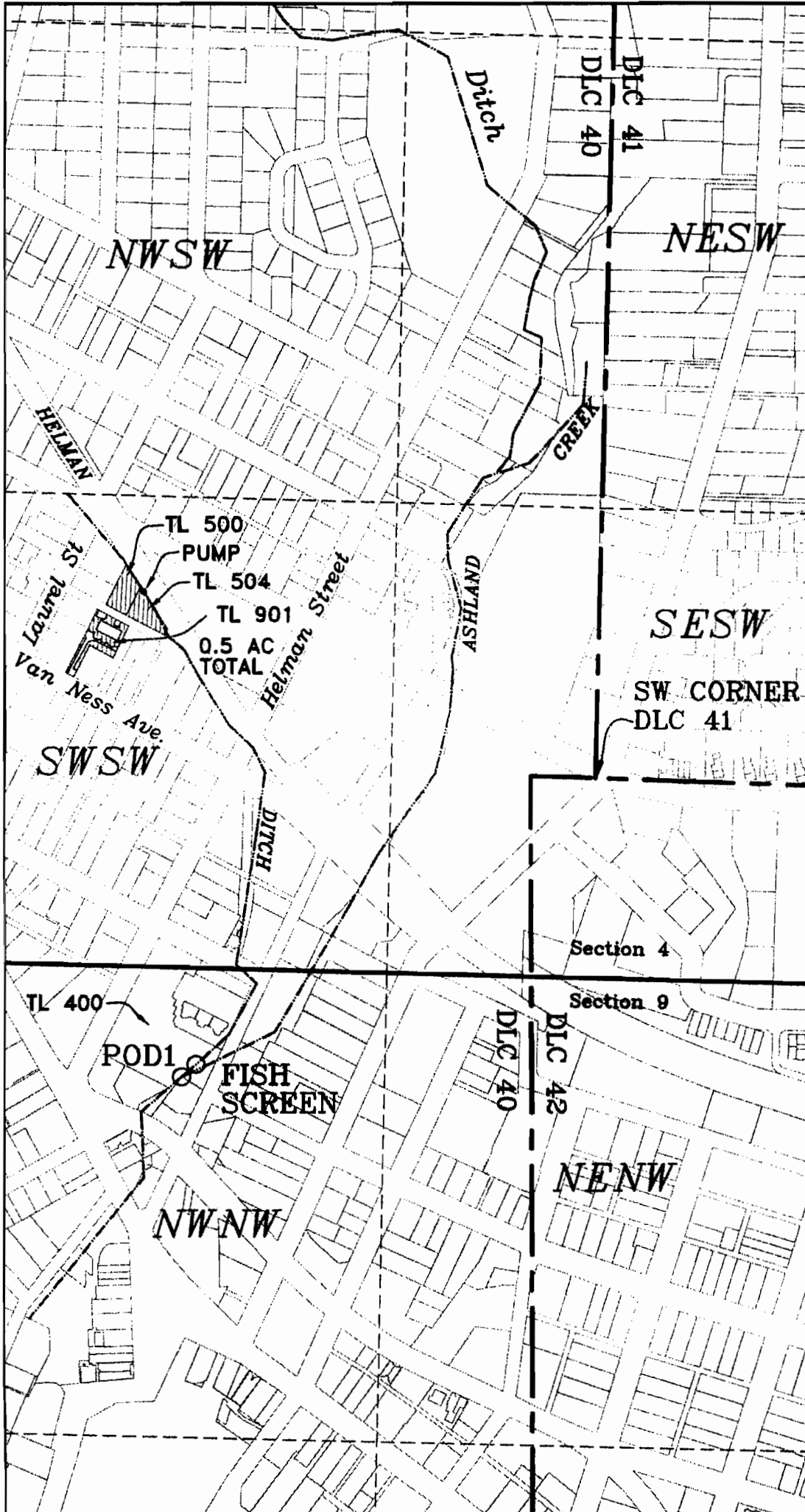

This map is not intended to provide legal dimensions or locations of property ownership lines

POD1- 850 feet south & 1200 feet west from the SW Corner DLC 41

Ditch location from POD to place of use is approximate

 Place of use
TL-500, 504 & 901
0.5 acres



RENEWS: 12/31/2012

Jackson County GIS data with 2010 aerial photo overlay used as base map

BLM online map used for location of DLC's and Government Lots

9/17/2012 EHM