

# Claim of Beneficial Use Map

Transfer T-10430

Township 5 & 6 North, Range 35 East (W.M.)

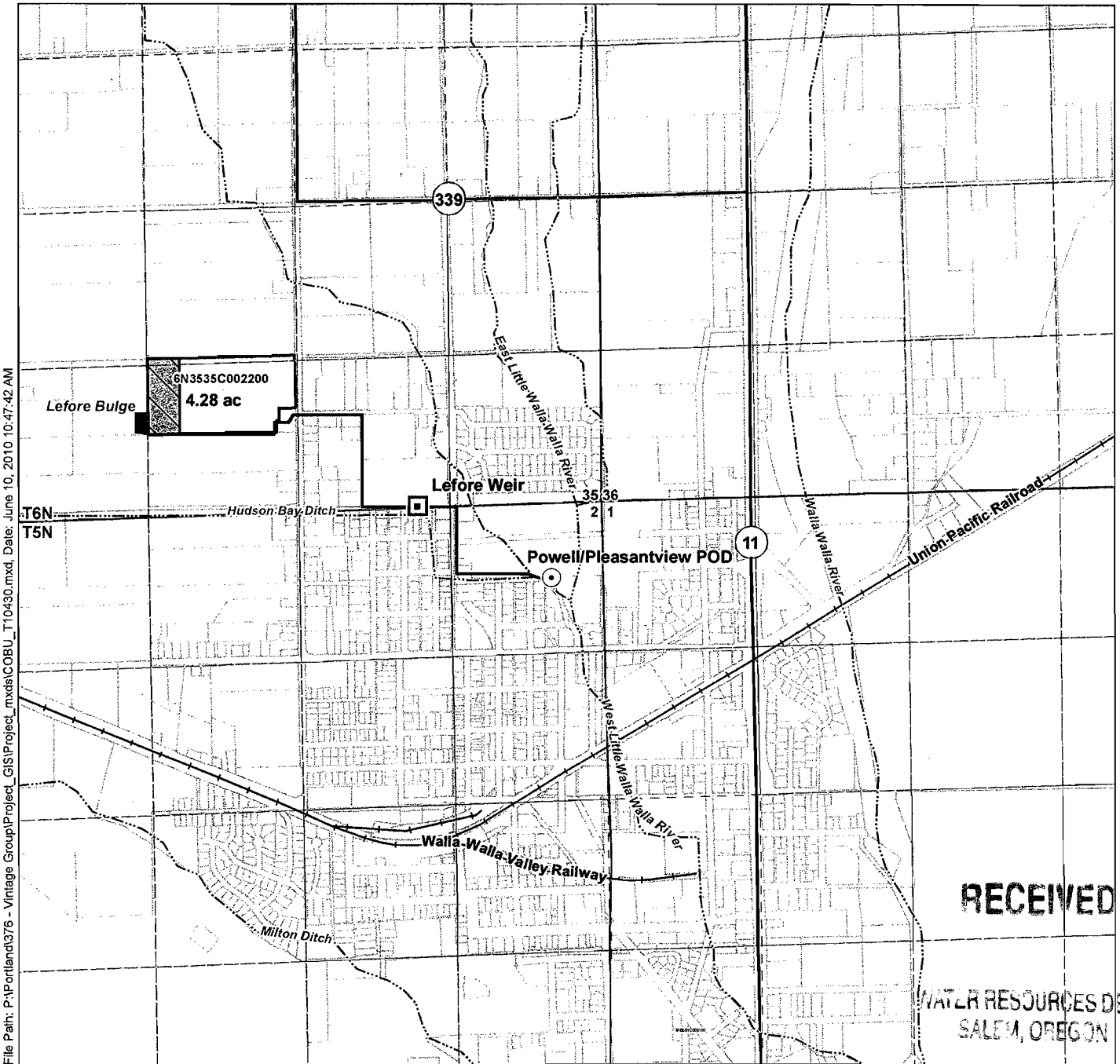

File Path: P:\Portland\376 - Vintage Group\Project\_GIS\Project\_mxd\COBU\_T10430.mxd, Date: June 10, 2010 10:47:42 AM

**RECEIVED**

WATER RESOURCES DEPT  
SALEM, OREGON

**LEGEND**

- ⊙ Point of Diversion (POD)
- ⊠ Point of Re-diversion
- ▨ Place of Use (POU)
- Pipeline
- ⊕ Taxlots (Vintage Group LLC)
- ⋯ Taxlots
- Major Roads
- Railroads
- ~ Watercourses

**Certified Water Rights Examiner Stamp**

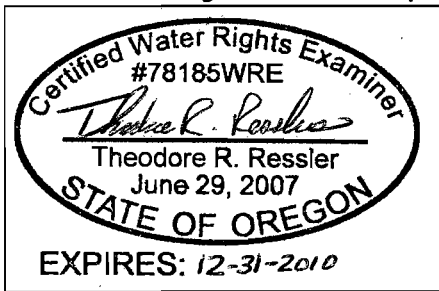

**Disclaimer**

This map was prepared for the purpose of identifying the location of a water right only and it is not intended to provide legal dimensions or location of property ownership lines.

**Map Notes**

Date: June 10, 2010  
Data Sources: Umatilla Co., ESRI  
Prepared By: GSI Water Solutions, Inc.

**POD Location Description**

Point of Diversion  
Located 650 feet South and 450 feet West from the NE corner of Section 2, Township 5 North, Range 35 East (W.M.)

