

# T. 7 S., R. 19 E., W.M.

ALUMINUM ROD 

THE NEW POINT OF DIVERSION IS 1362 FEET SOUTH AND 3028 FEET EAST OF THE NW CORNER OF SECTION 32.

THE OLD POINT OF DIVERSION IS 1687 FEET SOUTH AND 3074 FEET EAST OF THE NW CORNER OF SECTION 32.

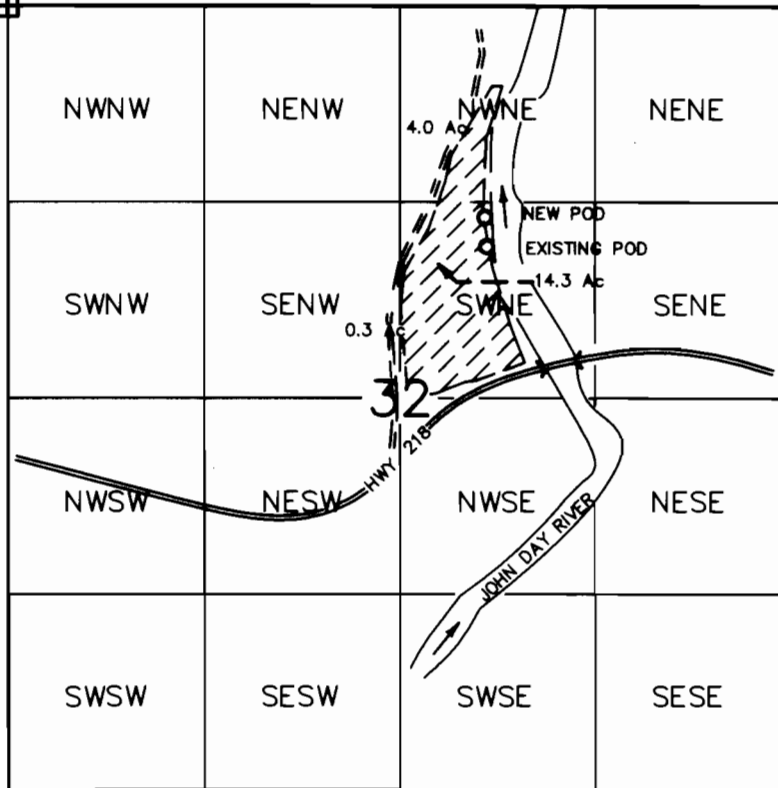

1" = 1320'

**RECEIVED**  
**MAY 15 2000**  
**WATER RIGHTS DIV.**  
**SALAS, OREGON**

## FINAL PROOF MAP

IN NAME OF

UNITED STATES BUREAU OF LAND MANAGEMENT

TRANSFER T-7963

 AUTHORIZED PLACE OF USE

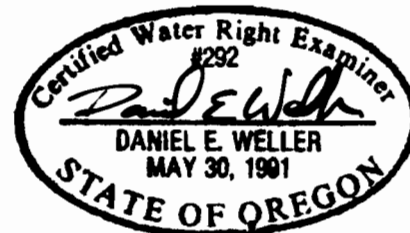

SURVEYED: FEBRUARY 23, 2000

THE PURPOSE OF THIS MAP IS FOR IDENTIFYING THE LOCATION OF THE WATER RIGHT ONLY AND IS NOT INTENDED TO PROVIDE LEGAL DIMENSIONS OR LOCATION OF PROPERTY OWNERSHIP LINES.

U.S. BUREAU OF LAND MANAGEMENT-OSO  
 BRANCH OF CADASTRAL SURVEY

DWG: CLARNO

EXECUTED BY:  
 DANIEL E. WELLER, PLS, CWRE  
 P.O. BOX 2965  
 PORTLAND, OREGON 97208