

RECEIVED

T.4S., R.1E., W.M

NOV 19 2011
PLAT 1507

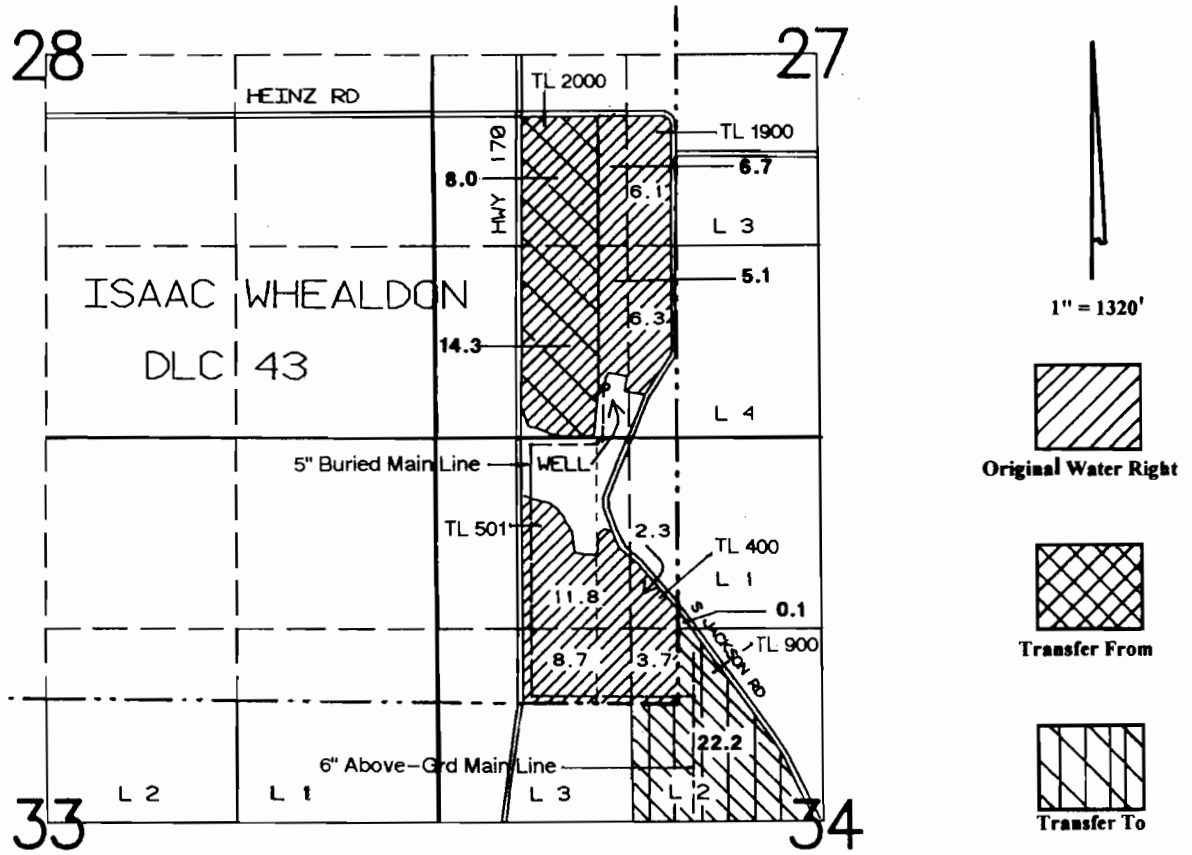

Well is located 340°N & 1170°E from the SW corner Section 27.

Final Proof Survey

In the Name of the

James C. Brown--Carol M. Brown Leroy L. Brown--Cynthia Brown

Transfer #: T-8555

Surveyed on October 6, 2011 by JM Schuette

This Map was Prepared for the Purpose of Identifying the Location of a Water Right Only and is Not Intended to Provide Legal Dimensions or Location of Property Ownership Lines.

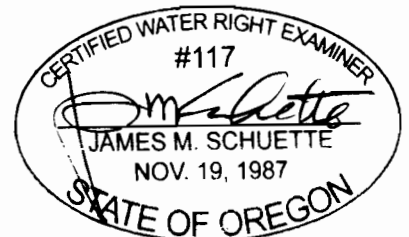

EXPIRES: 6/30/2012