

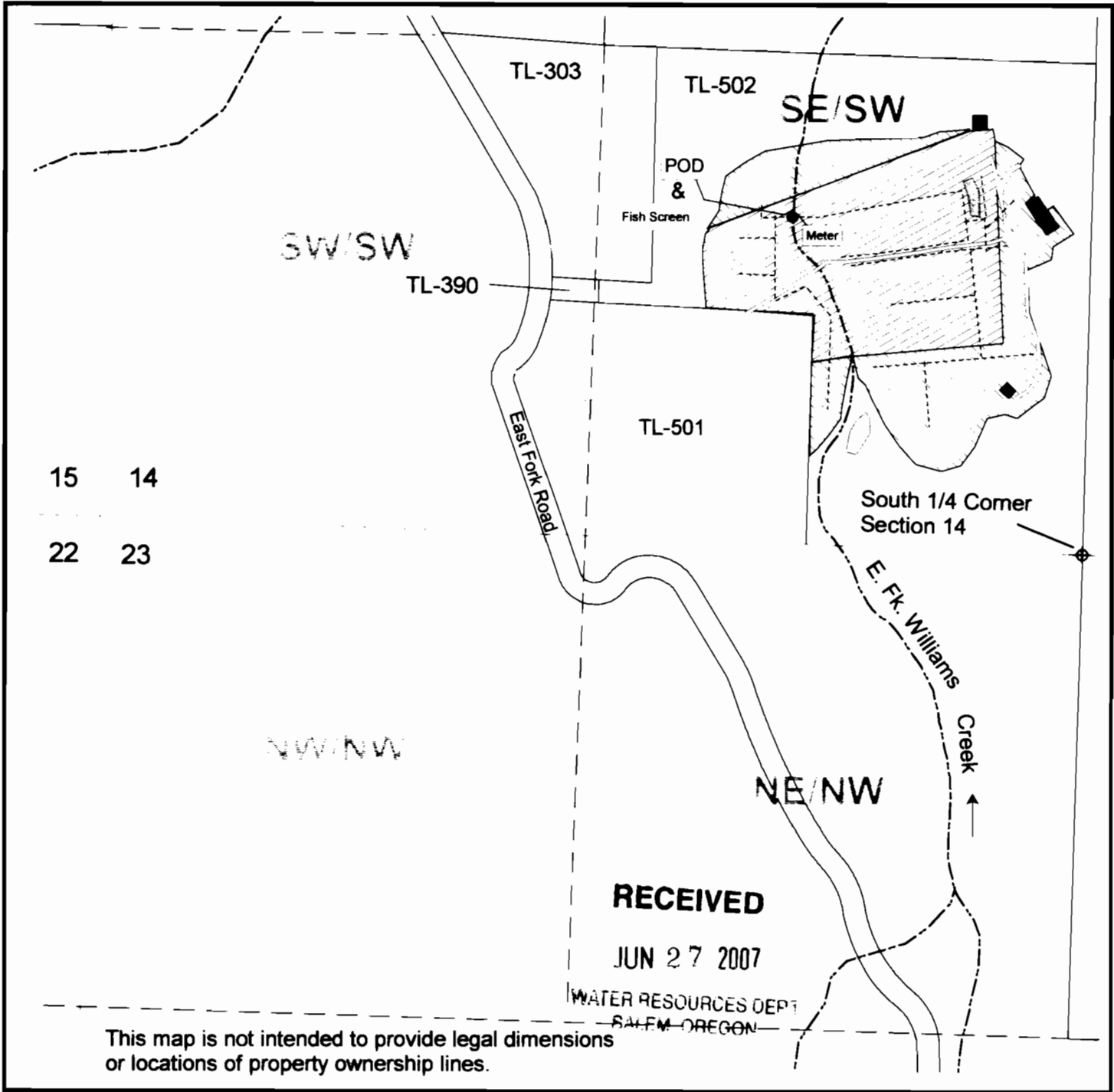

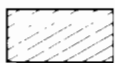

**Township 39 S. Range 5 W., W.M.
Josephine County**

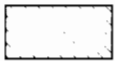

POD - 885 ft. N. & 805 ft. W. from the S 1/4 Corner Section 14

Scale: 1" = 400'

-  **C-16331 - 8.0 acres**
-  **C-32960 - 5.7 acres**
-  **Buildings**
-  **Pond**
-  **3 inch Mainline**

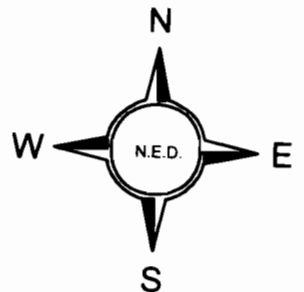

**Claim of Beneficial Use
for Harold J. Farver T-10147**

June 18 2007