

CLAIM OF BENEFICIAL USE MAP

UNDER APPLICATION R-85419 ; PERMIT R-13799

SW1/4 NW1/4 SEC 13 T 15S R 44E W.M.

U.S.G.S. QUAD - HUNTINGTON, OREG. - 7 1/2'

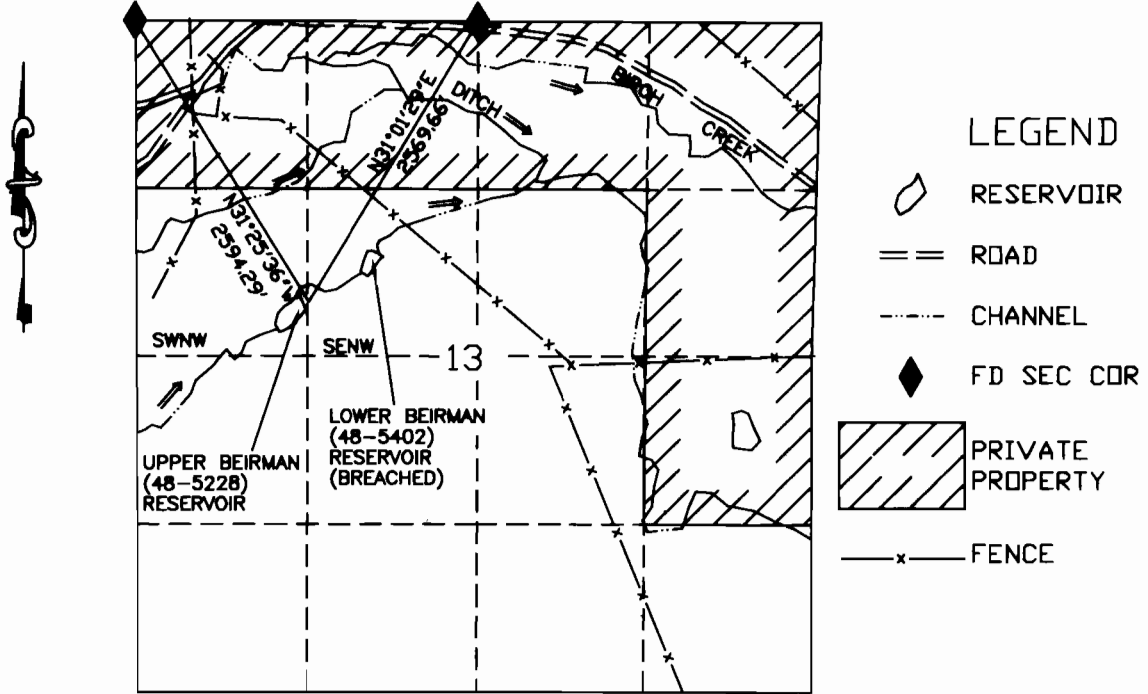

UPPER BEIRMAN (48-5229) RESERVOIR

MAP 15S44E
TAX LOT 100

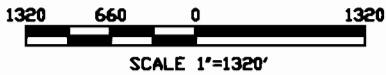

I, Charles E. Joy, Administrative Officer, Vale BLM agree to the findings of the CWRE and do submit this site report and map as my Claim of Beneficial Use of the water as provided under the terms and conditions of my Permit R-13799

Charles E. Joy



THIS MAP IS FOR THE PURPOSE OF LOCATING A WATER RIGHT AND IS NOT INTENDED TO PROVIDE LEGAL DIMENSIONS FOR LOCATION OF PROPERTY BOUNDARIES.

ACADEMIC DVG FILE BEIRMAN-BENE

UNITED STATES DEPARTMENT OF THE INTERIOR BUREAU OF LAND MANAGEMENT DIVISION OF OPERATIONS VALE DISTRICT	
UPPER BEIRMAN (48-5229) RESERVOIR	
DESIGNED:	<i>David R. Peterson</i>
REVIEWED:	<i>Charles E. Joy</i>
APPROVED:	<i>Charles E. Joy</i> ADMIN OPERATIONS AND FIELD SERVICES
DRAWN: CG	SCALE: 1"=1320'
DATE: 09/04/07	SHEET 1 OF 1
DRAWING NO. DR-03-9172.45-704	

RECEIVED

MAY 05 2008

WATER RESOURCES DEPT
SALEM, OREGON