

T11S R26E W.M.

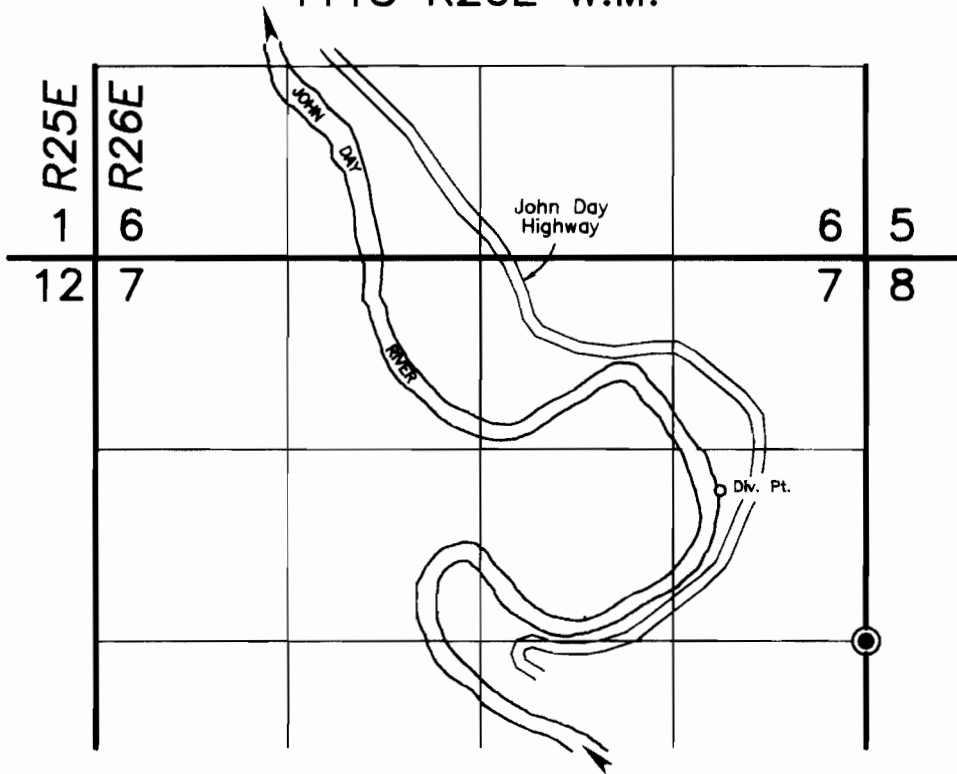

SCALE 1" = 1320'

Div. Pt. is 1040' N. and 1000' W. of the E1/4 cor. Sec. 7.

**FINAL PROOF SURVEY
UNDER**

TRANSFER NO. 7195
SPECIAL ORDER VOL. 51, PG.'S 1248-1250

IN NAME OF

KERRY LANE LOWE

SURVEYED SEPTEMBER 3, 1999

BY ROBERT D. BAGETT

NOTE: The preparation of this map was for the purpose of identifying the location of the proposed water right and has no intent to provide dimensions or location of property ownership lines. Location information shown hereon was furnished by the applicant.

