

FINAL PROOF MAP

TO SHOW WATER RIGHTS AND
POINTS OF APPROPRIATION
FOR APPLICATION G-16257
ANDY ROOT

RECEIVED

DEC 30 2011

TOWNSHIP 23 SOUTH, RANGE 32 EAST, SECTION 18, W.M.
TAX LOT: 2500 HARNEY COUNTY, OREGON

WATER RESOURCES DEPT
SALEM, OREGON

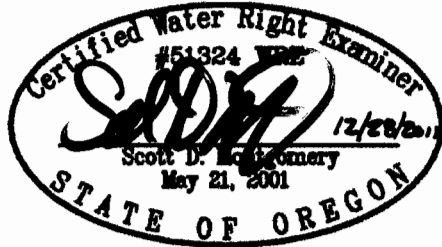

RENEWAL DATE: 12/31/2012

THIS MAP IS FOR THE PURPOSE OF LOCATING A WATER
RIGHT ONLY AND HAS NO INTENT TO PROVIDE LEGAL
DIMENSIONS OR THE LOCATION OF PROPERTY LINES

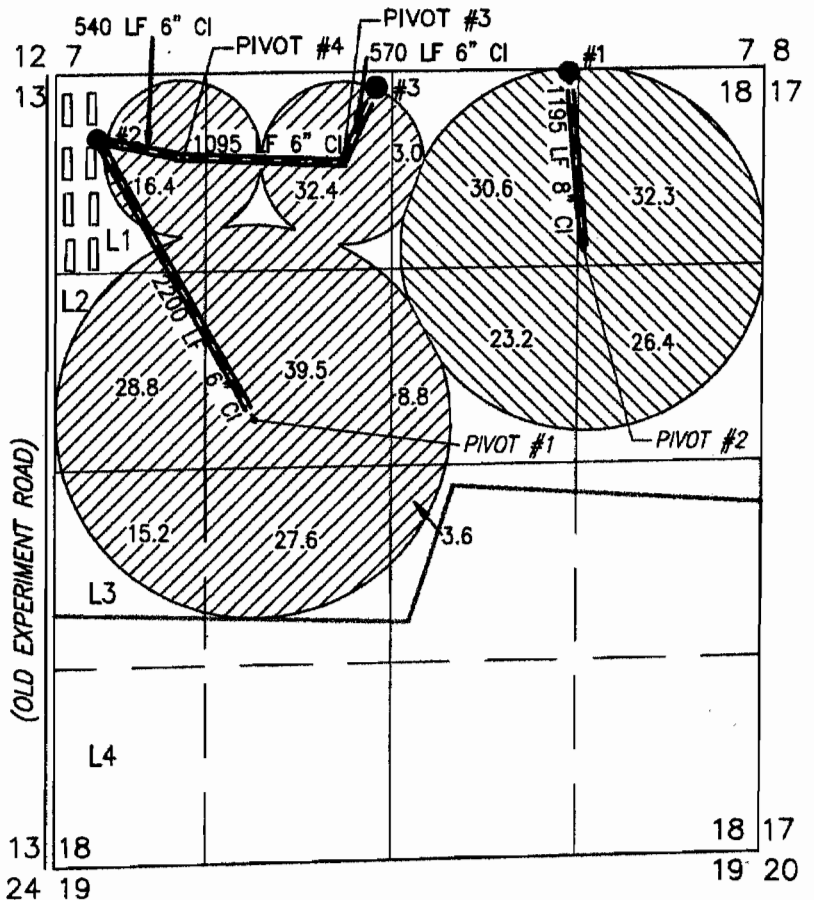

- #1
WELL #1 (HARN 50927) PERMIT: G-15942
50' SOUTH & 3520' EAST FROM THE NW
CORNER SECTION 18
- #2
WELL #2 (HARN 51150) PERMIT: G-15942
410' SOUTH & 300' EAST FROM THE NW
CORNER SECTION 18.
- #3
WELL #3 (HARN 51157) PERMIT: G-15942
140' SOUTH & 2200' EAST FROM THE NW
CORNER SECTION 18.

— BURIED 6 OR 8 INCH STEEL PIPE —

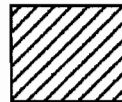

175.3 ACRES PRIMARY IRRIGATION FROM
WELLS 2 & 3, G-15942, AS SHOWN



112.5 ACRES PRIMARY IRRIGATION
FROM WELL 1, G-15942, AS SHOWN

PREPARED FOR:
ANDY ROOT
524 HIGHWAY 20 N
HINES, OR 97738

PREPARED BY:
 ALL POINTS ENGINEERING AND SURVEYING, INC.
P.O. BOX 767 (CRR) TERREBONNE, OR 97760
(541) 548-5833 www.APEandS.com