

SECTION 18, T.13S., R.27E.

RECEIVED

APR 25 2012

WATER RESOURCES DEPT.  
SALEM, OREGON

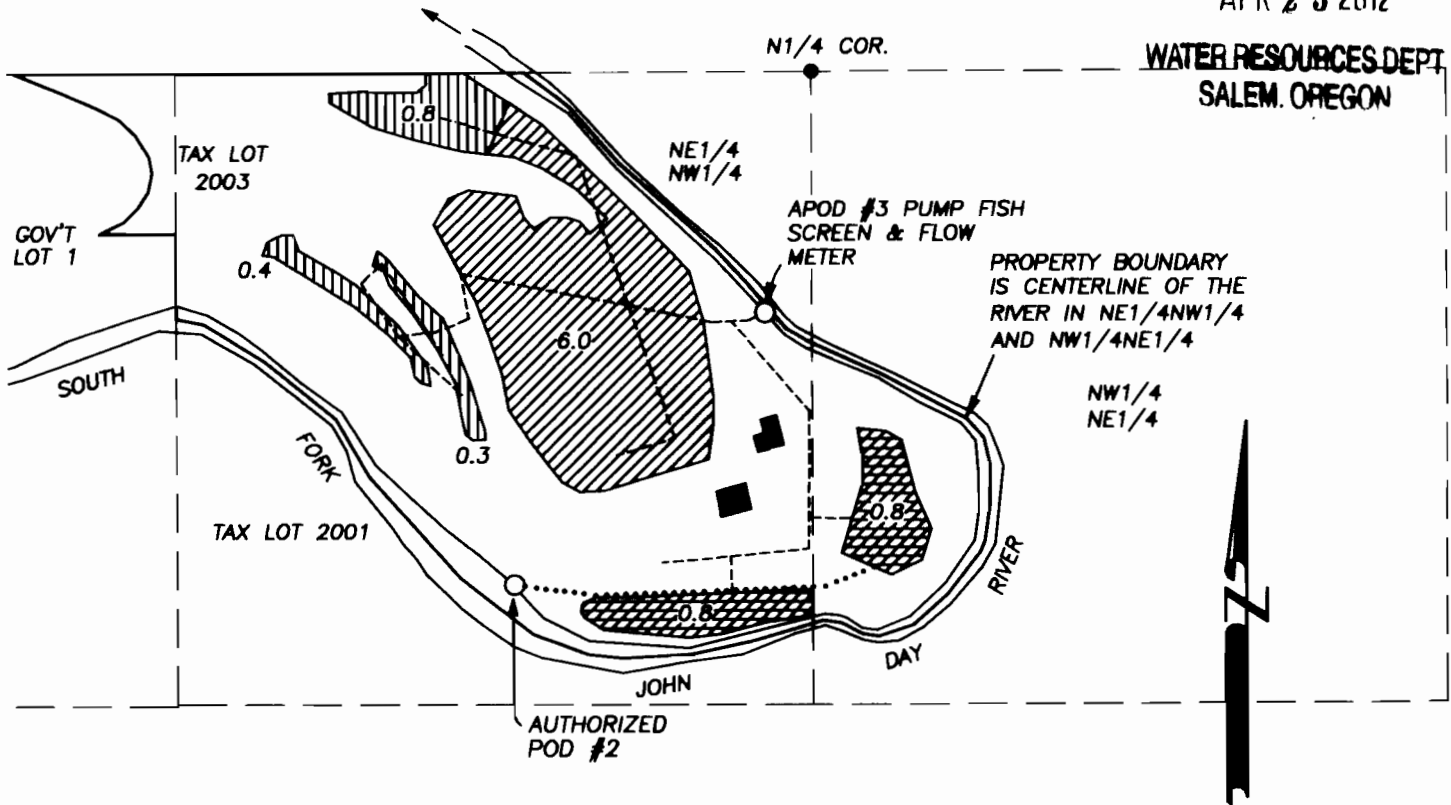

ORIGINAL POD #1 C52983: 1200' SOUTH AND 2650' EAST OF NW CORNER SEC. 24, T.13S., R.26E., W.M.

AUTHORIZED POD #2 C52983: 1090' SOUTH AND 1970' EAST OF NW CORNER SEC. 18.





AUTHORIZED POD #2 C64069: 1070' SOUTH AND 620' WEST OF N1/4 CORNER SEC. 18.

ADDITIONAL POD #3 IS 500' SOUTH & 100' WEST OF THE N1/4 CORNER SECTION 18, T.13S., R.27E., W.M.

NOTE: CENTERLINE RIVER IS PROPERTY BOUNDARY

SCALE: 1" = 400'

FINAL PROOF SURVEY  
UNDER  
APPLICATION NO. T-10982  
PERMIT NO. SPECIAL ORDER  
VOL. 81, PAGE 302  
IN NAME OF  
ARNOLD L. & JO E. JOHNSON

-  PLACE OF USE APOD#3
-  PLACE OF USE APOD#3
-  PLACE OF USE AUTH. POD#2
-  MAINLINE
-  FLEX LINE

SEC. 24, T.13S., R.26E.

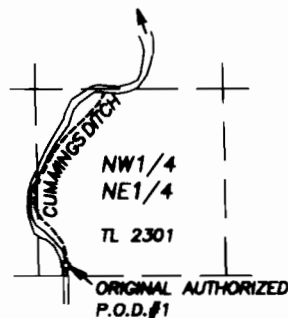

SCALE: 1" = 1320'

PREPARED BY:

ROBERT BAGETT  
217 N. CANYON BLVD.  
JOHN DAY, OREGON  
(541) 575-1251

NOVEMBER 10, 2010

REVISED  
APRIL 9, 2012

NOTE: THE PREPARATION OF THIS MAP WAS FOR THE PURPOSE OF IDENTIFYING THE LOCATION OF THE PROPOSED WATER RIGHT AND HAS NO INTENT TO PROVIDE DIMENSIONS OR LOCATION OF PROPERTY OWNERSHIP LINES.

