

2" A.C.
MON. BOX

FINAL PROOF SURVEY AND CLAIM OF
BENEFICIAL USE MAP FOR CITY OF
PRINEVILLE, CROOK COUNTY AND
CROOK COUNTY PARKS AND
RECREATION DISTRICT IN THE N1/2 OF
SECTION 6, T.15S., R.16E., W.M.,
CROOK COUNTY, OREGON

LEGEND



WATER ON
C. 2778-PRIMARY
C. 68395-SUPPLEMENTAL

- POINT OF DIVERSION
WEST 3220' & SOUTH 1575'
FROM NE CORNER SECTION 6
- × PUMP STATION

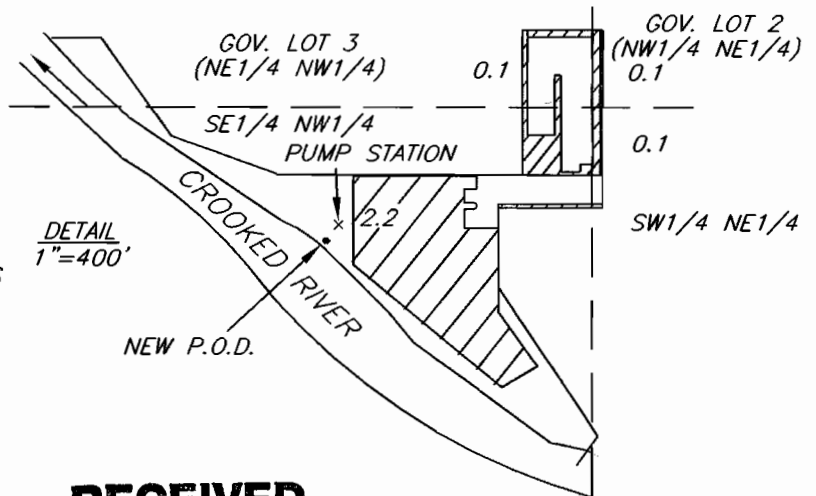

SURVEY NOTE

THE PREPARATION OF THIS MAP IS
FOR THE PURPOSE OF IDENTIFYING
THE LOCATION OF THE WATER RIGHT
ONLY AND HAS NO INTENT TO
PROVIDE DIMENSIONS OR LOCATIONS
OF PROPERTY OWNERSHIP LINES.

RECEIVED

FEB 10 2003

WATER RESOURCES DEPT.
SALEM, OREGON

DRG. NO. 02-2365.DWG

ARMSTRONG SURVEYING
& ENGINEERING, INC.
378 NE SECOND ST.
PRINEVILLE, OR 97554
(541) 447-7791

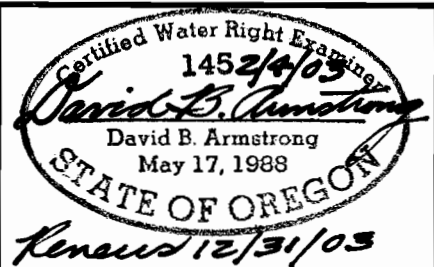

SCALE: 1"=1320'

DATE: FEBRUARY 3, 2003

W.O. 02-2365