

# T.6S. R.1W. Section 24, W.M.

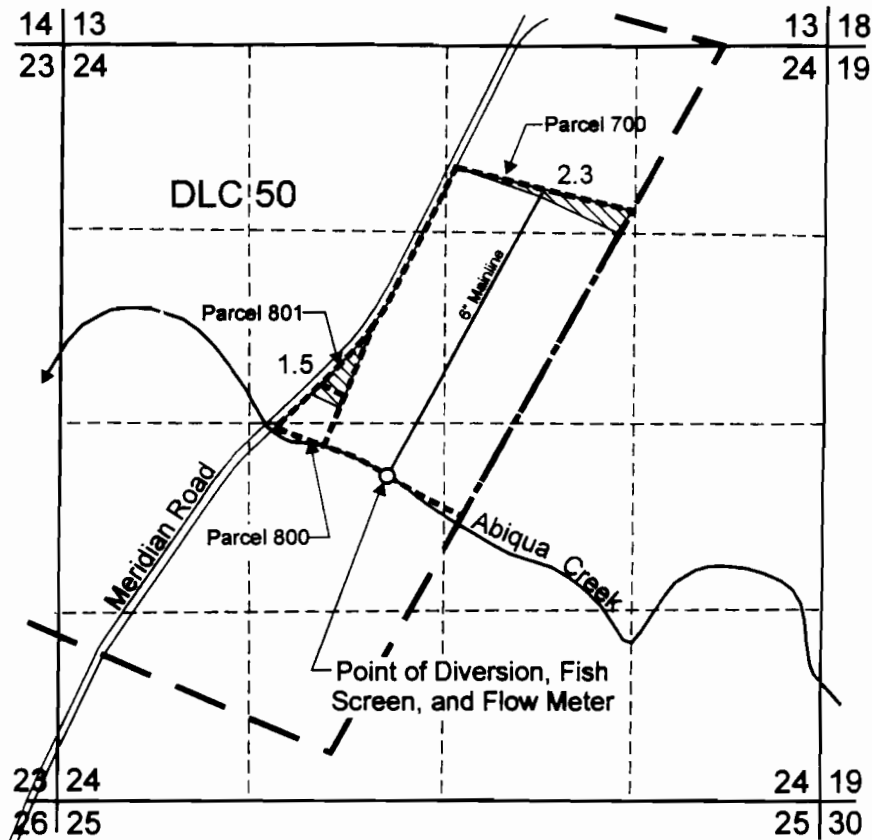

Point of Diversion is located 2,980 feet south and 3,030 feet west from the NE corner, Section 24.

 Area (3.8 Acres) irrigated under Transfer 8196.

 Tax lot boundary

**RECEIVED**

**DEC 20 2007**

WATER RESOURCES DEPT  
SALEM, OREGON

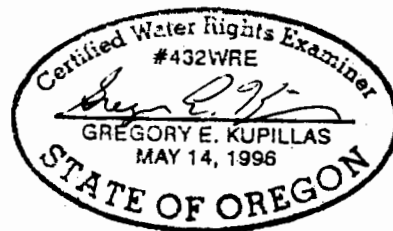

EXPIRATION DATE: 6/30/09

Scale: 1" = 1,320'

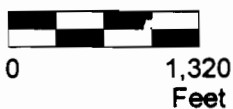

This map was prepared for the purpose of identifying the location of a water right only and is not intended to provide legal dimensions or location of property ownership lines.



Pacific Hydro-Geology Inc.

Claim of Beneficial Use Map  
Transfer 8196  
Paul Kraemer  
Tax Map 6 1W 24, Parcels 700, 800, and 801

12/2007