

SECTION 13 & 14, T.4S., R.5W., W.M.

YAMHILL COUNTY, OREGON

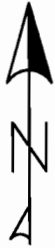

SCALE: 1"=400'

MAP BASE:
ODWR CERT. MAPS
ASSESSORS MAP
FIELD SURVEY
FOR RESEVOIR

RESERVOIR POD IS
S 16°18'48" E
995.34' FROM NW
COR. SECTION 13,
T4S, R5W, WM TO
☉ DAM AT CONDUIT

ALL IN WILLIAM
DAWSON DLC 43

— · — MAIN LINE

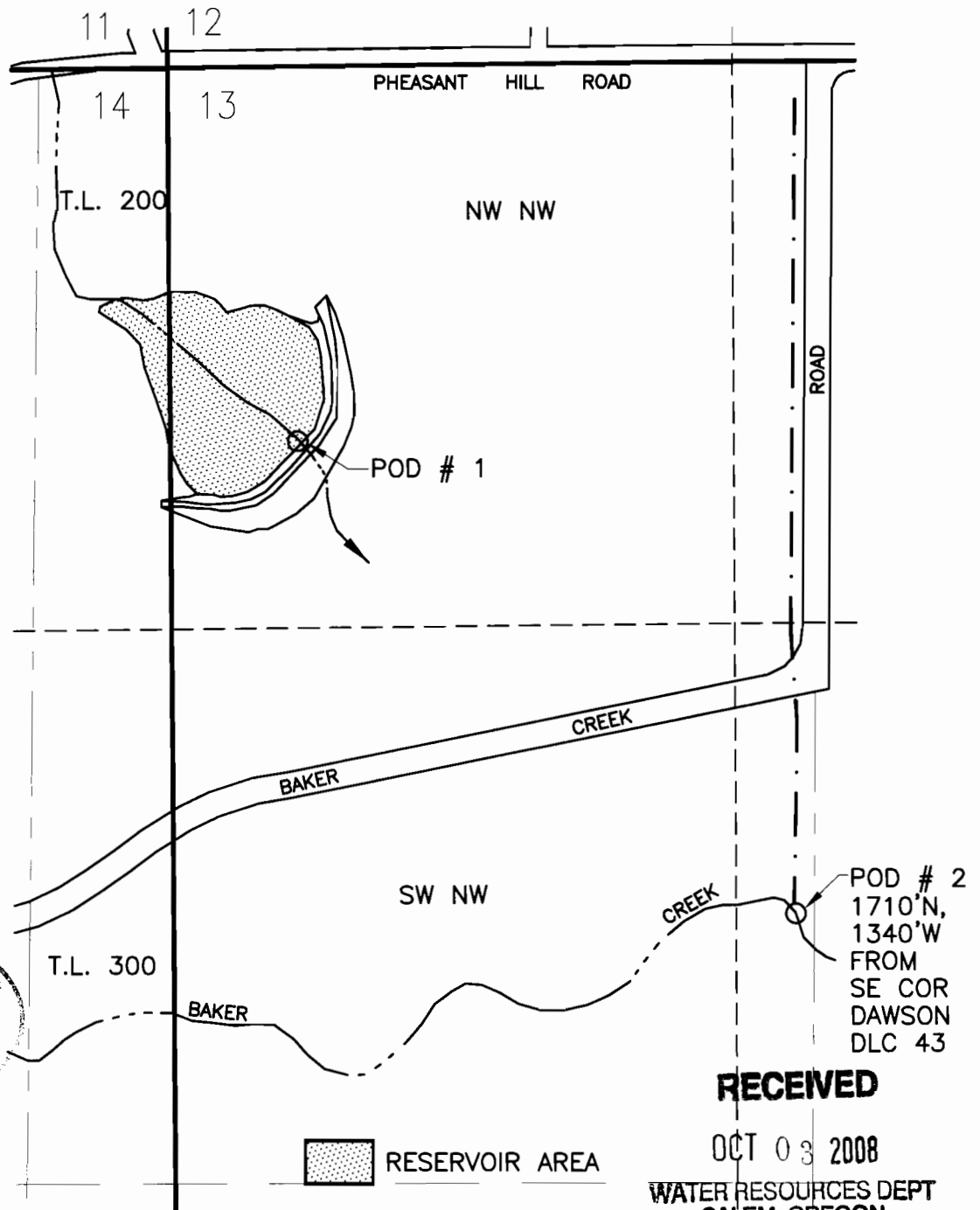
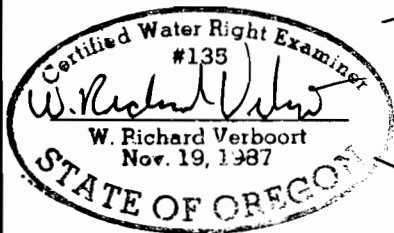

RECEIVED

OCT 03 2008

WATER RESOURCES DEPT
SALEM, OREGON

PREPERATION OF THIS MAP IS FOR THE
PURPOSE OF IDENTIFYING THE LOCATION OF
THE WATER RIGHT ONLY. THERE IS NO INTENT
TO PROVIDE DIMENSIONS OR LOCATION OF
PROPERTY OWNERSHIP LINES.

CLAIM OF BENEFICIAL USE MAP
SURVEYED 09-23-08



Project: 305-2-027-A
By: W. R. Verboort, P.E.
Date: 09-23-08

WADE & PATRICIA MILLER

13945 PHEASANT HILL ROAD
McMINNVILLE, OR 97128