

T.39S., R.2W., W.M.

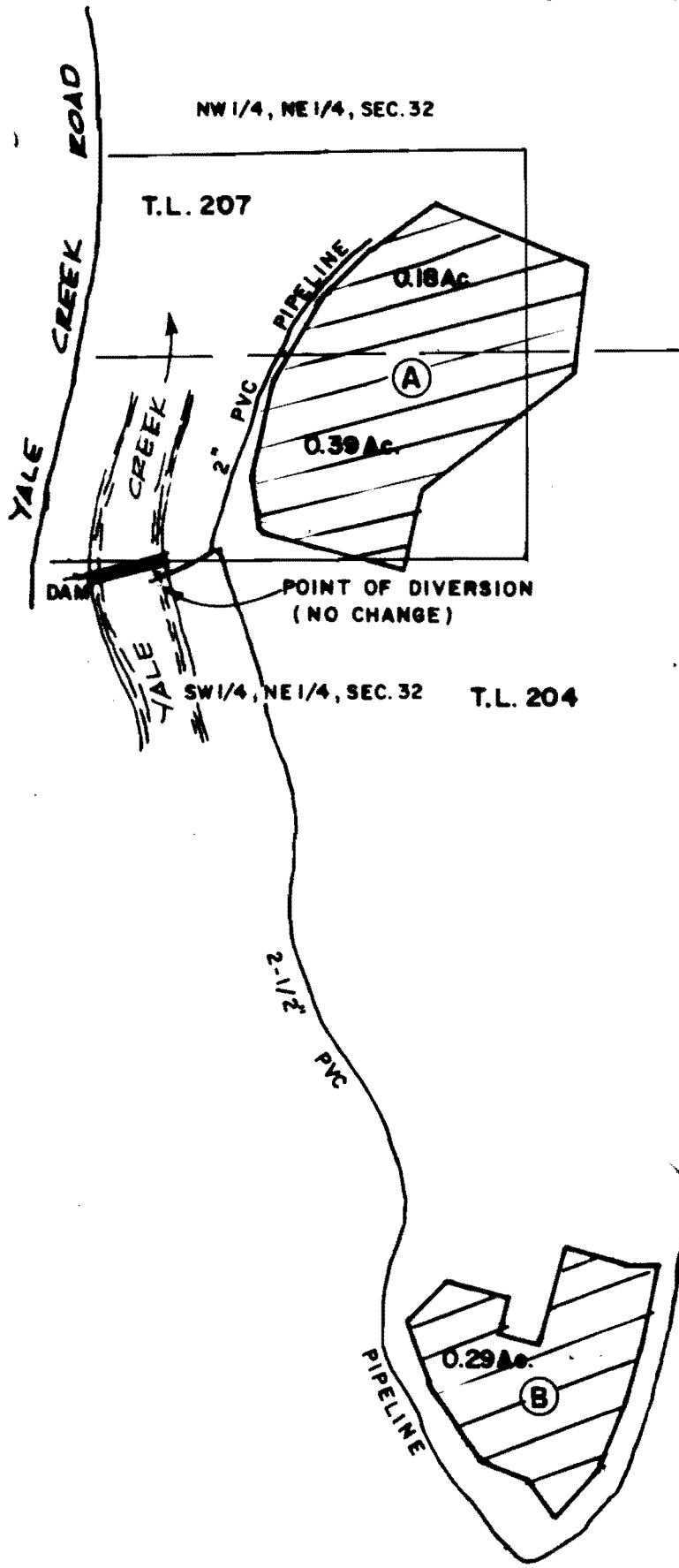

SCALE: 1"=100'

NE 1/16 COR.
SEC. 32

RECEIVED

SEP 20 2004

WATER RESOURCES DEPT
SALEM, OREGON

E. LINE W 1/2 NE 1/4, SECTION 32
2" PVC PIPELINE TO 10,000 GAL ST. TANK
FOR FIRE PROTECTION

TRACTS A B
ARE NEW TRANSFERRED
IRRIGATION

Certified Water Right Examiner
025
Mark E. Boyden
Mark E. Boyden
Nov. 18, 1987
STATE OF OREGON
EXPIRES 12/31/05

WATER RIGHT FINAL PROOF

T.39S., R.2W., W.M.

Change in place of use
Re: Transfer 8765

THOMAS W. & FAITH RUSSELL
995 YALE CREEK RD.
JACKSONVILLE, OR.
97530-934

RECEIVED

SEP 20 2004

WATER RESOURCES DEPT.
SALEM OREGON



29

Scale: 1" = 1000'

REVISED

Aug. 31, 2004

0.86AC
TRANSFERRED FROM

F&BC
1/4 Cor.

KATHY L. DEAN
INS # 99-41390
TAX LOTS 701, 301 & 302

POD BRIDGE No. 502
Ditch (West Side
Yale Creek)

EXISTING DITCH, PIPELINE
FLUME

5/8" Pin

POD RILEY-PHILLIPS DITCH
EAST SIDE OF YALE CREEK
S1433.6' W316' FROM NE
COR. W 1/2 NE 1/4 SEC. 32

See Sheet 2 for Detail

0.18AC. NW-NE
0.39AC SW-NE
0.29AC SW-NE
TRANSFERRED TO

F.S.
11252

TL 207

THOMAS W. RUSSELL &
FAITH RUSSELL
INS # 95-34212 TAX LOTS
204 & 207

TL 204

32

POD GARRISON DITCH
(WEST SIDE OF YALE CREEK)

NOTE: CERTIFICATE SHOULD HAVE LISTED
THE POB IN THE SW 1/4 OF THE
NE 1/4 SEC 32 FOR THE RILEY-PHILLIPS DITCH

