

# T.4S. R.2W., W.M.

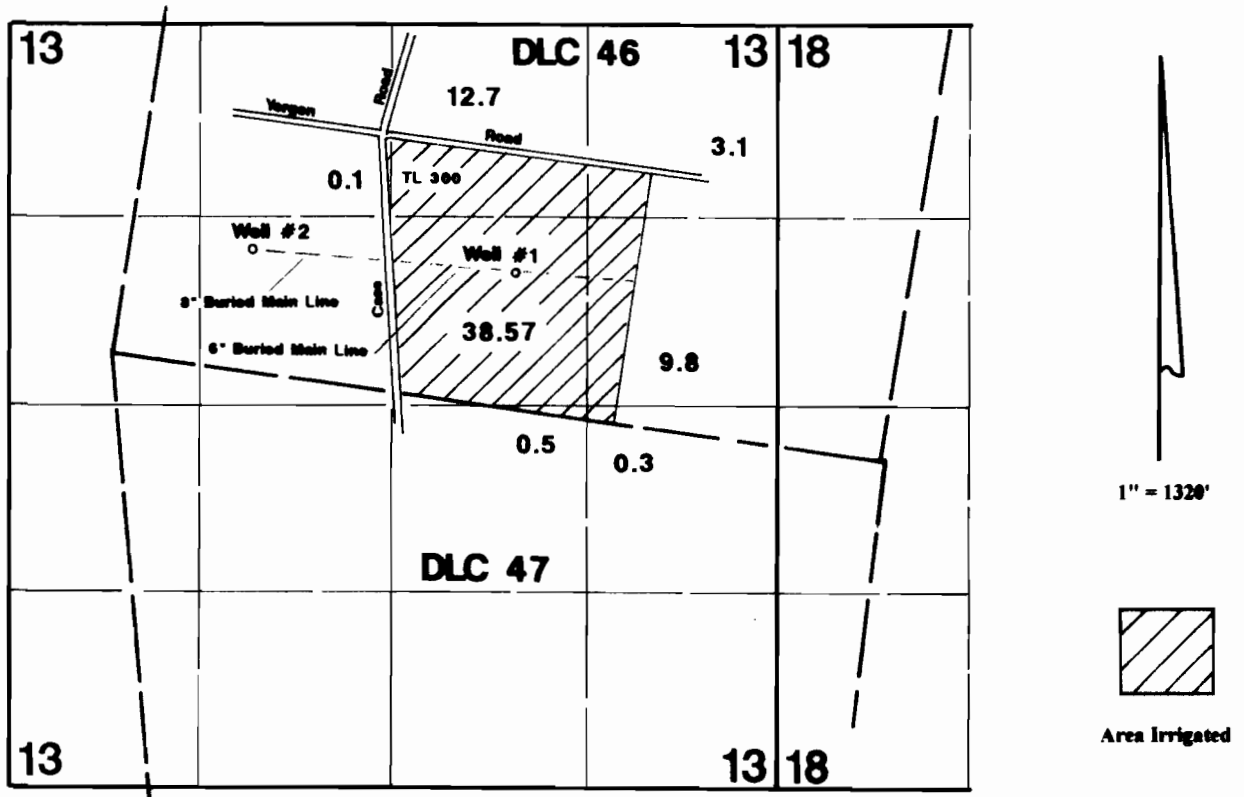
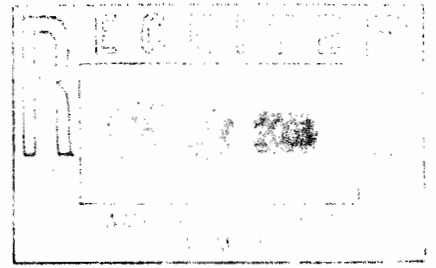

Well #1 is located 1280'N & 2510'W from the SE corner DLC 46.  
Well #2 (add'l POA) is located 676'N & 976'E from the SW corner of DLC 41.

## Final Proof Survey

Transfer #: T-8542

In Name Of

### Mike & Jean Ryan

Surveyed on September 16, 2003 by JM Schuette

This Map Was Prepared For The Purpose Of Identifying The Location Of A Water Right Only And Is Not Intended To Provide Legal Dimensions Or Location Of Property Ownership Lines.

