

T.12S., R.9E., W.M.
JEFFERSON COUNTY, OREGON
FINAL PROOF SURVEY

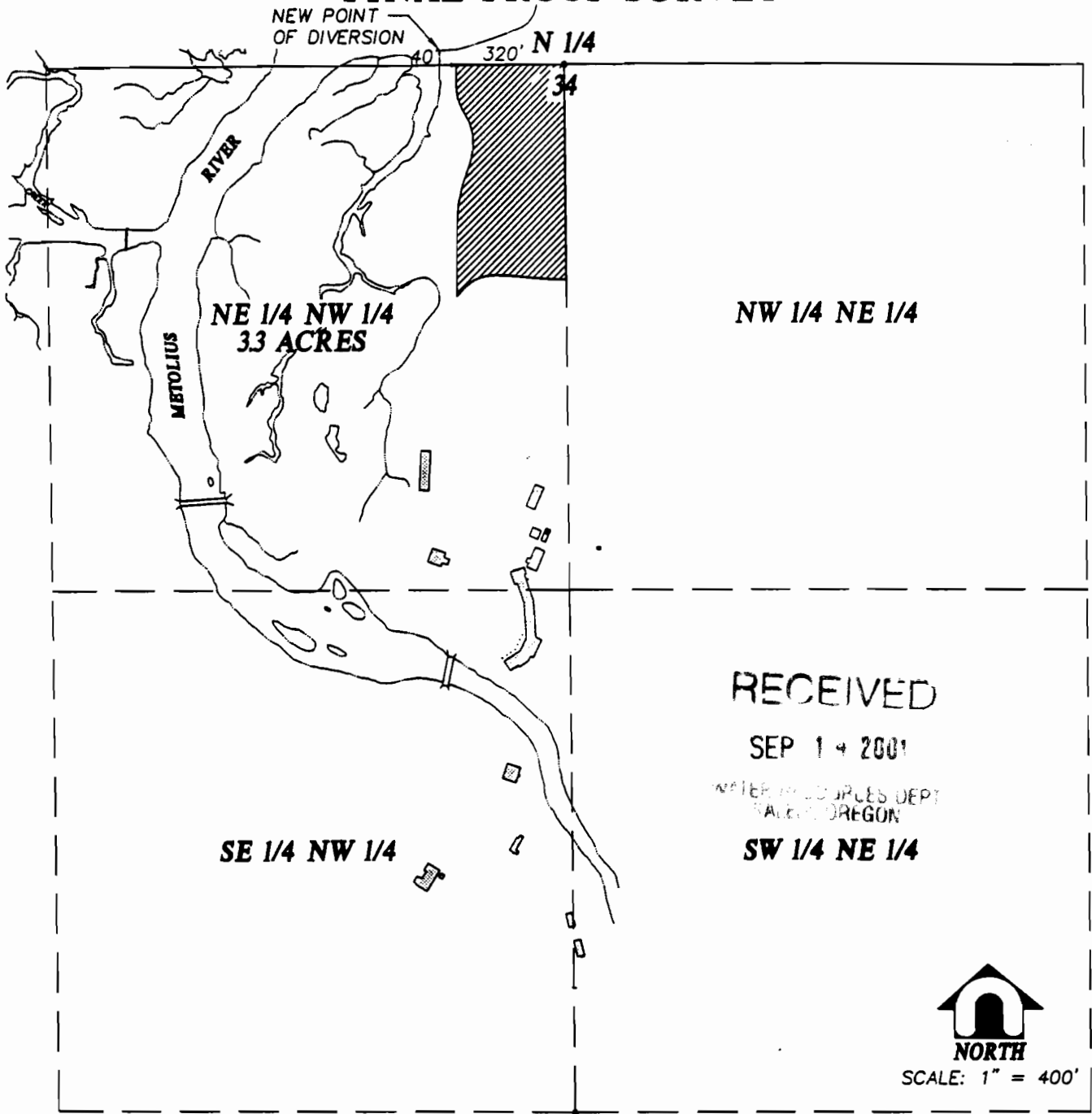

NORTH
 SCALE: 1" = 400'

LEGEND:

- STRUCTURE
- TOTAL IRRIGATED AREA
(3.3 ACRES) DIGITIZED FROM
AERIAL PHOTO

THIS MAP IS FOR THE PURPOSE OF LOCATING
 A WATER RIGHT AND IS NOT INTENDED TO
 PROVIDE LEGAL DIMENSIONS FOR PROPERTY
 BOUNDARIES.

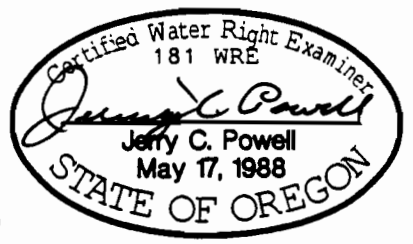

RENEWS 12-31-2002



**DAVID EVANS
 AND ASSOCIATES, INC.**
 709 NW Wall Street, Suite 102
 Bend, Oregon 97701 (541) 389-7614

**FINAL PROOF SURVEY
 FOR METOLIUS L.L.C.**
 LOCATED IN THE
 N 1/2 OF SEC. 34, T.12S., R.9E., W.M.
 JEFFERSON COUNTY, OREGON

scale 1" = 400' design
 date 9/04/01 drawn JHL
 file HOTM0005 - HOTM5WTR.DWG