

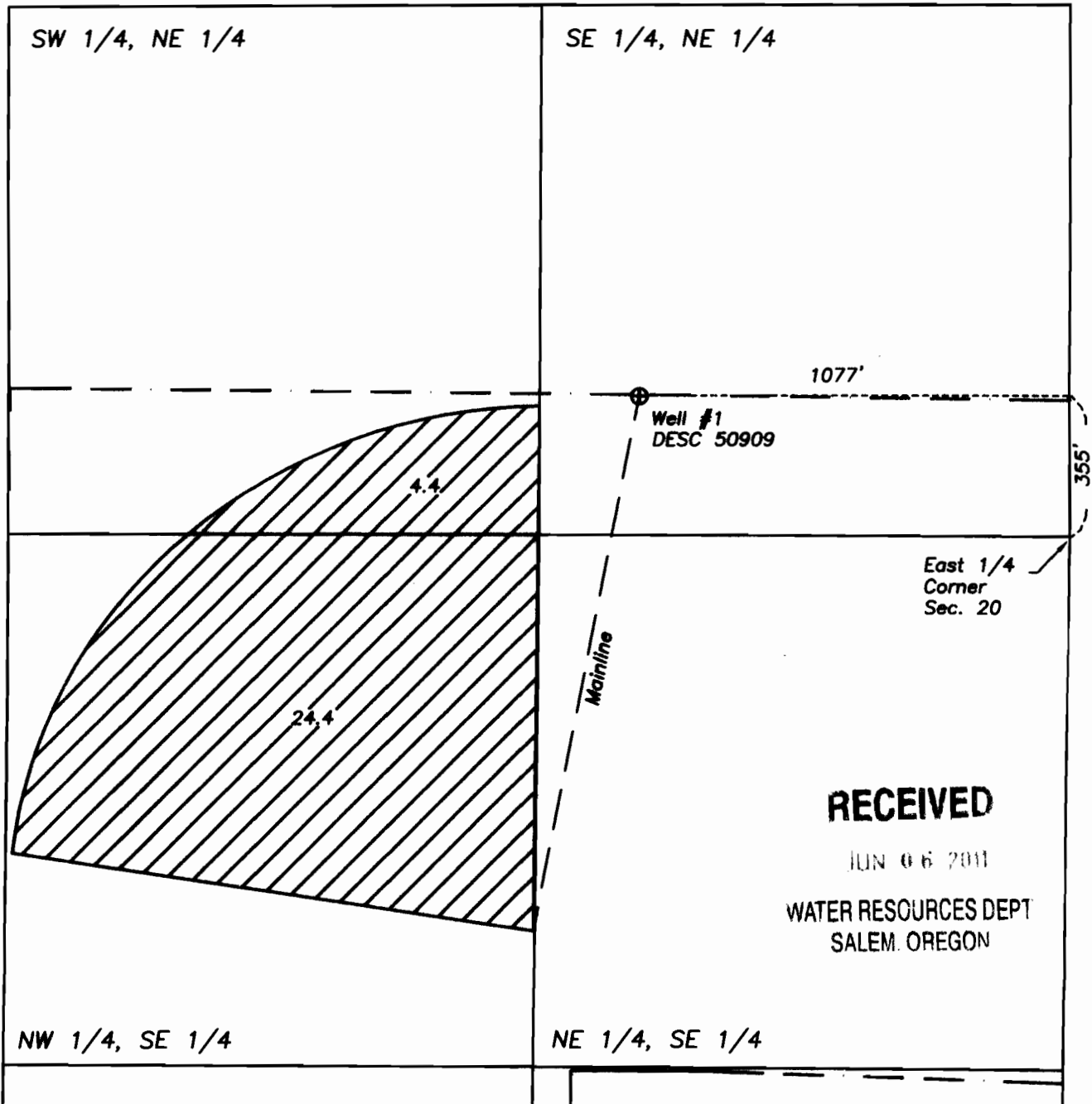



Claim of Beneficial Use
Transfer T-8026
Gorham and Robin Nichols



Tax Lot 200, Map 14-12-20
 T14S, R12E, Section 20
 Deschutes County, OR



Legend

-  Water beneficially used under T-8026 (Priority date 12/15/1976)
-  Tax lot boundary
-  Well

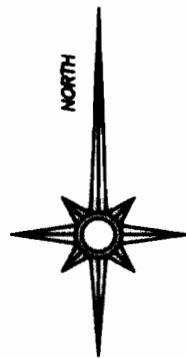

THIS MAP IS FOR THE PURPOSE OF IDENTIFYING THE LOCATION OF THE WATER RIGHT. IT IS NOT INTENDED TO PROVIDE LEGAL DIMENSIONS OR LOCATIONS OF PROPERTY OWNERSHIP LINES.