

**RECEIVED**

JUL 30 1996

WATER RESOURCES DEPT.  
SALEM, OREGON

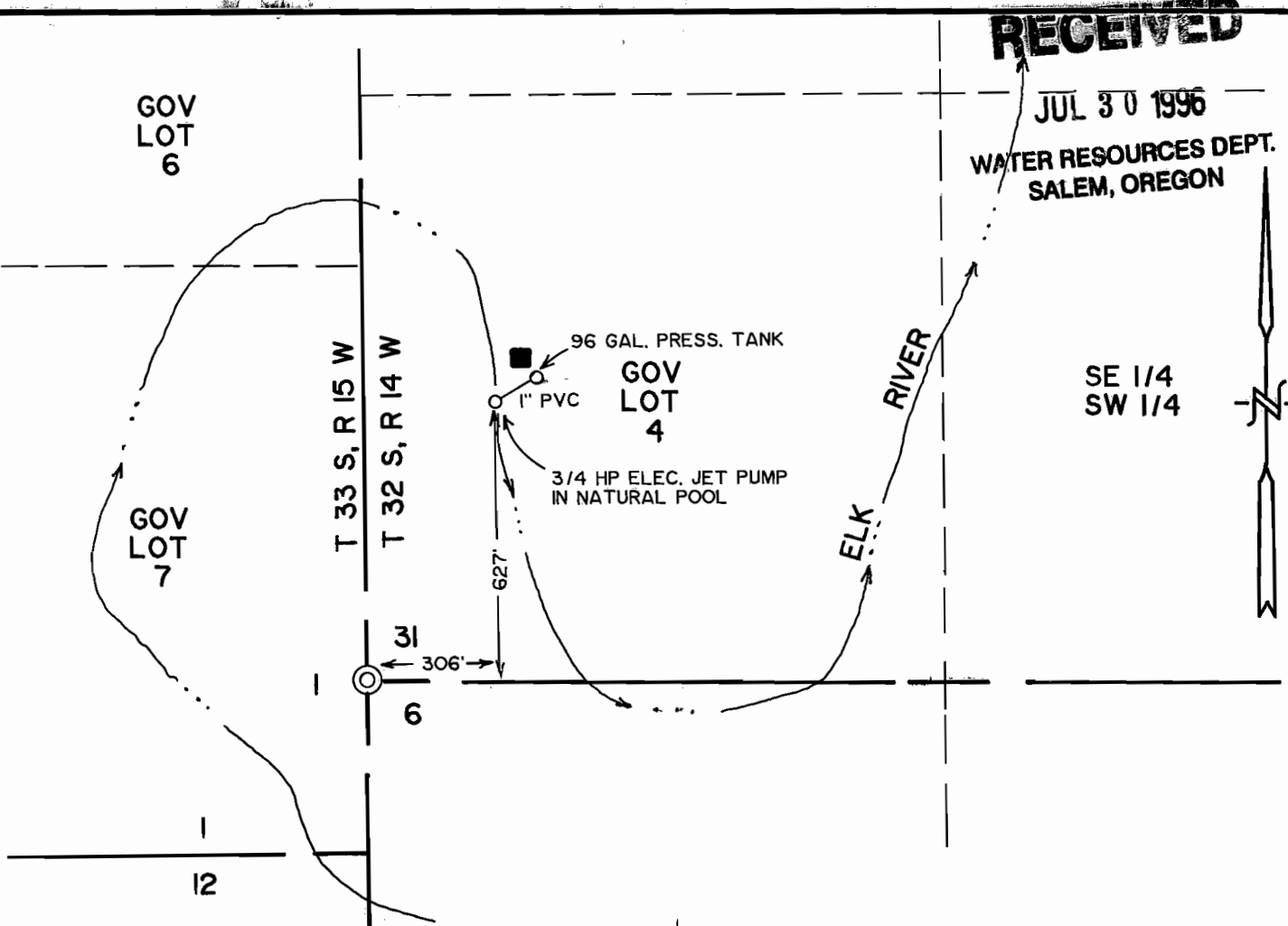

THE PREPARATION OF THIS MAP WAS FOR THE PURPOSE OF IDENTIFYING THE LOCATION OF THE PROPOSED WATER RIGHT AND HAS NO INTENT TO PROVIDE DEMENSIONS OR LOCATION OF PROPERTY LINES.

T 32 S, R 14 <sup>W</sup>/~~S~~, W.M.  
SECTION 31  
**FINAL PROOF SURVEY**

UNDER

APPLICATION #73299 PERMIT #52236

IN THE NAME OF

**BENNETT & JEAN CORAZZA**

SURVEYED JULY 18, 1996, BY H.J. NEWHOUSE

SCALE 1" = 400'

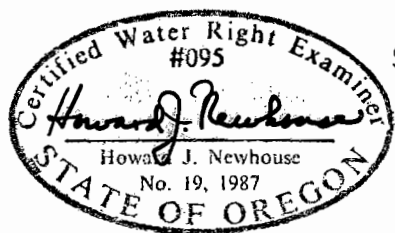

AC WRD 7/23/13