

T.7S. R.1W., W.M.

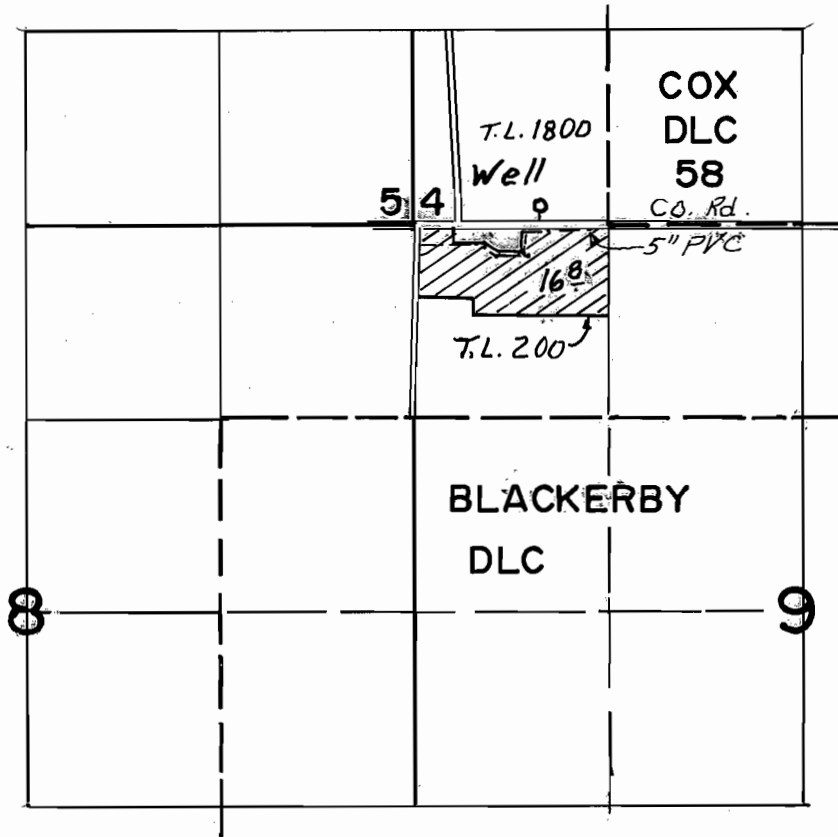

4" = 1 Mi.

WELL LOC. 130' N & 465' W FROM SW COR DLC 58

FINAL PROOF SURVEY UNDER

RECEIVED

SEP 05 2000

WATER RESOURCES DEPT.
SALEM, OREGON

TRANSFER NO. T-7658

Application No. Permit No.

IN NAME OF

HARRY & DELORIS KLOPFENSTEIN

Surveyed AUG. 5, 2000, by

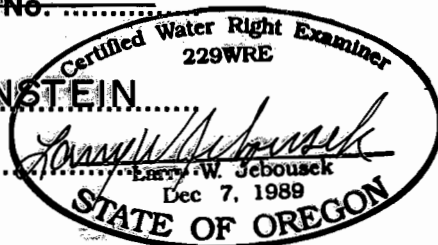

THIS MAP WAS PREPARED FOR THE PURPOSE OF IDENTIFYING THE LOCATION OF A WATER RIGHT ONLY AND IS NOT INTENDED TO PROVIDE LEGAL DIMENSIONS OR LOCATION OF PROPERTY OWNERSHIP LINES.