

# CLAIM OF BENEFICIAL USE

APPLICATION G-14589      PERMIT G-13453  
 APPLICATION R-83524      PERMIT R-12505  
 APPLICATION S-83523      PERMIT S-53431

IN THE NAME OF BURGUNDY HARVEST FARM, INC.  
 TOWNSHIP 32 SOUTH, RANGE 15 WEST, W.M.  
 CURRY COUNTY OREGON

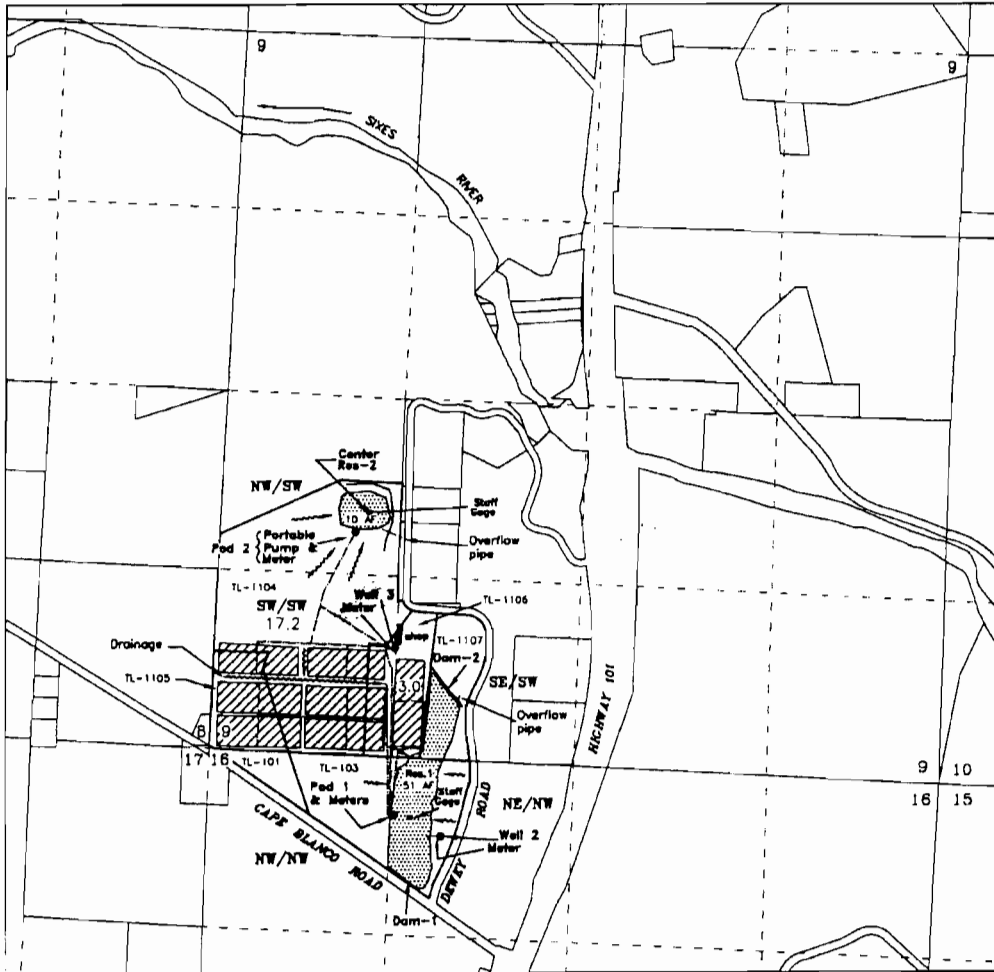

RECEIVED BY OVER...

DEC 18 2012

SALEM, OR

NORTH

Scale  
1 inch = 1320 feet

Dam-1	NE/NW Sec. 16	820 feet South & 1480 feet East
Dam-2	SE/SW Sec. 9	510 feet North & 1710 feet East
Center Res-2	NW/SW Sec. 9	1800 feet North & 1030 feet East
POD-1	NE/NW Sec. 16	420 feet South & 1350 feet East
POD-2	NW/SW Sec. 9	1620 feet North & 975 feet East
Well-2	NE/NW Sec. 16	560 feet South & 1700 feet East
Well-3	SW/SW Sec. 9	790 feet North & 1310 feet East

All from the SW corner of Section 9, T.32S, R.15W, W.M.

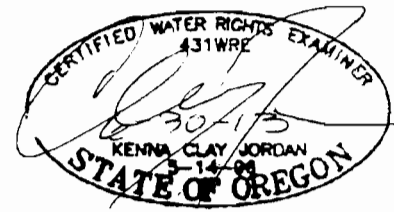

- Drainage
- R-12505 - 61.0 Acre-Feet
- G-13453 - 20.2 acres, Cranberry Operations
- S-53431 - 20.2 acres, Supplemental Cranberry Operations

Mapped from field inspections  
July 20, 2010 & April 19, 2012

JORDAN ENGINEERING  
450 JORDAN LANE  
ROSEBURG, OR 97471  
(541) 673-1931

Base map - Curry County GIS with 2005  
FSA aerial photo overlay & 8/2/2012  
Google aerial for assumed best fit

This map is not intended to provide legal dimensions  
or locations of property ownership lines

Drawn 9/8/2010 n.e.d.  
Revised (2) 12/13/2012 n.e.d.