

Claim of Beneficial Use Map

Transfer T-10430

Township 5 & 6 North, Range 35 East (W.M.)

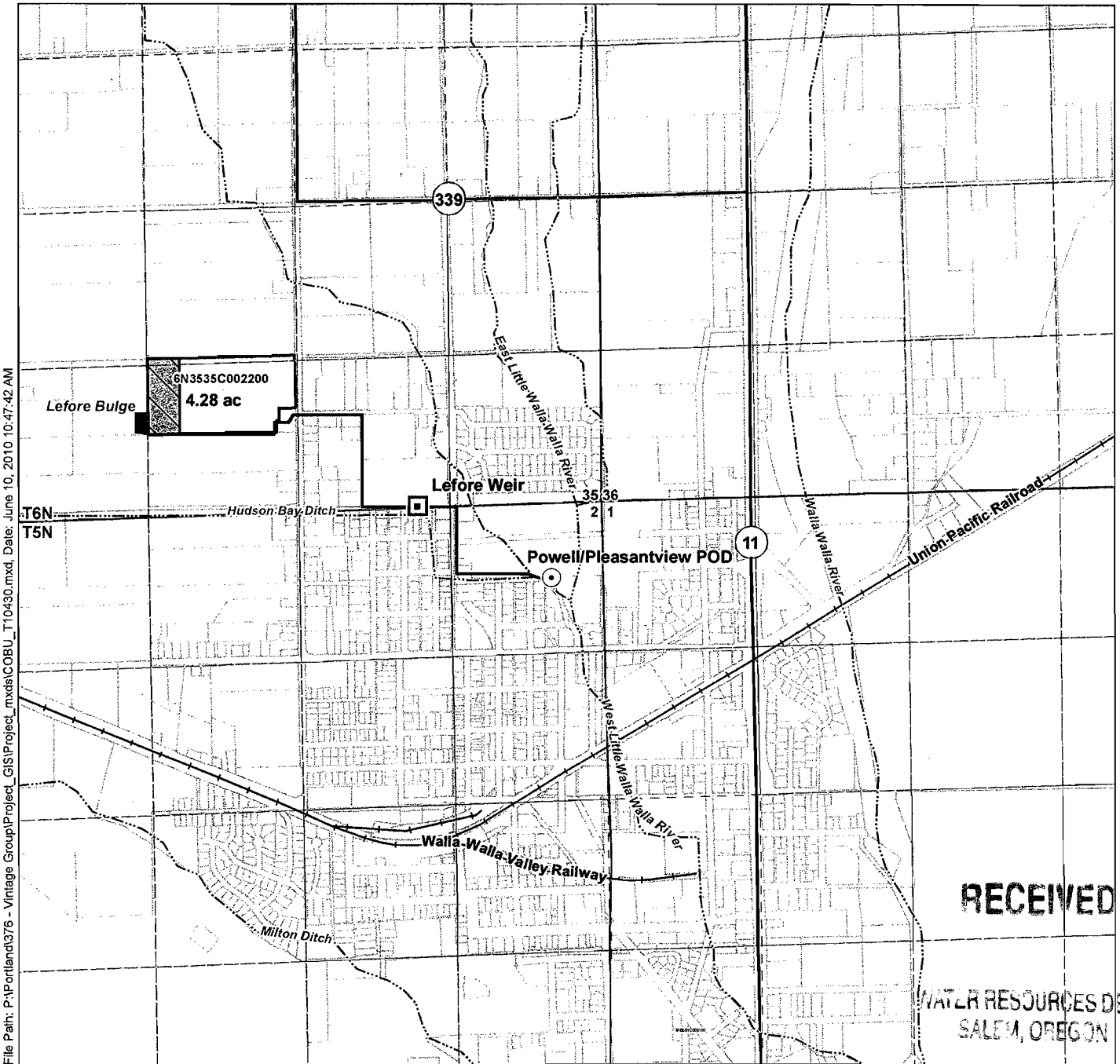

File Path: P:\Portland\376 - Vintage Group\Project_GIS\Project_mxd\COBU_T10430.mxd, Date: June 10, 2010 10:47:42 AM

RECEIVED

WATER RESOURCES DEPT
SALEM, OREGON

LEGEND

- ⊙ Point of Diversion (POD)
- ⊠ Point of Re-diversion
- ▨ Place of Use (POU)
- Pipeline
- ⊕ Taxlots (Vintage Group LLC)
- ⋯ Taxlots
- Major Roads
- Railroads
- ~ Watercourses

Certified Water Rights Examiner Stamp

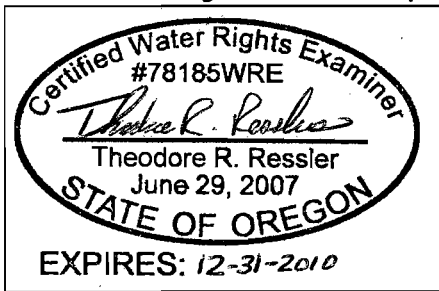

Disclaimer

This map was prepared for the purpose of identifying the location of a water right only and it is not intended to provide legal dimensions or location of property ownership lines.

Map Notes

Date: June 10, 2010
Data Sources: Umatilla Co., ESRI
Prepared By: GSI Water Solutions, Inc.

POD Location Description

Point of Diversion
Located 650 feet South and 450 feet West from the NE corner of Section 2, Township 5 North, Range 35 East (W.M.)

