

POD 1 is 2730' South and 2620' West of the NE Cor. Sec. 35.
 POD 2 is 2460' South and 2350' West of the NE Cor. Sec. 35.
 POD 3 is 820' North and 730' West of the NE Cor. Sec. 35.
 POD is in SW1/4NE1/4 Sec. 35 T.10S., R.20E., W.M., C-10948
 The existing ditches shown are from Final Proof Survey for C-10948

**FINAL PROOF SURVEY
 UNDER**

TRANSFER NO. T-8238
 SPECIAL ORDER VOL. 55, PG.'S 1216-1219

IN NAME OF
THOMAS E. & MARY T. NORTON

SURVEYED SEPTEMBER 8, 2004
 BY ROBERT D. BAGETT

 PLACE OF USE

● FD. U.S. DEPT. OF INTERIOR MONUMENT

() TAX LOT NO.

MAP REVISED DECEMBER 16, 2004

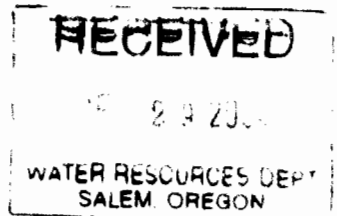

NOTE: The preparation of this map was for the purpose of identifying the location of the proposed water right and has no intent to provide dimensions or location of property ownership lines.

CLAIM OF BENEFICIAL USE MAP



Tax Lot 200 - T-8238

Located in SW-NE & NW-SE of Section 9,
T.11S., R.20E., W.M. - Wheeler County, Oregon

NOTES

1. This map was prepared for the purpose of identifying the location of water rights only and is not intended to provide legal dimensions or locations of property ownership lines.

LEGEND

-  T-1897 Area
-  T-1889 Area

RECEIVED

DEC 10 2018

OWRD

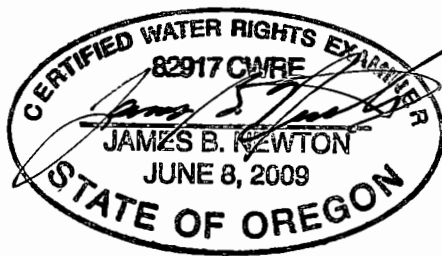

EXPIRES:
RENEWS: 4/1/2019

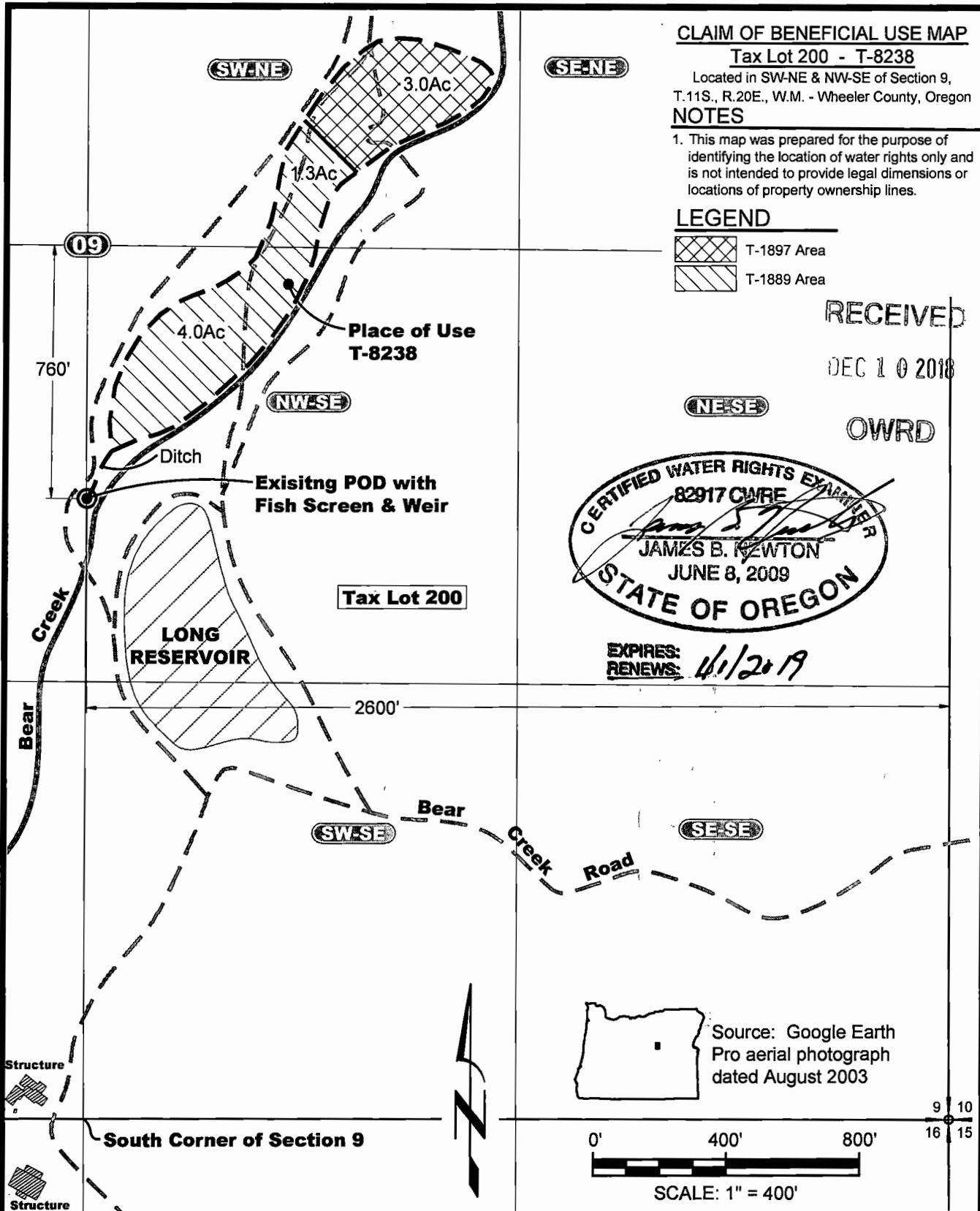

Source: Google Earth
Pro aerial photograph
dated August 2003

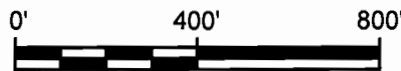

SCALE: 1" = 400'

9 10
16 15



CASCADE
GEOENGINEERING
360.907.4162
cascadegoengineering.com

Place of Use Map
T-8238 - Terry Long
Wheeler County, Oregon

DESIGNED BY:
J. Newton

DRAWN BY:
R2D

DATE:
NOV 2018

PROJECT NO.
CG-1000-102

FIGURE 2