

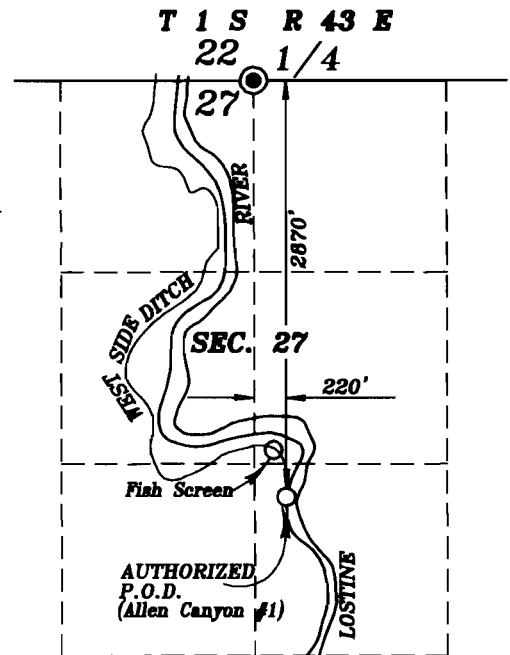

SCALE: 1"=1320'

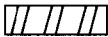

 Lands with Primary rights from Wallowa River Decree and supplemental rights under Certificate 65175 requesting a change of place of use.

 Lands with Primary rights from Wallowa Decree, to receive supplemental rights from Certificate 65175.

----- Existing mainline

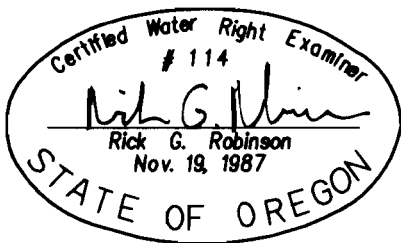

May 11, 2012

FINAL PROOF MAP OF A
CHANGE OF PLACE OF USE
FOR
ROYCE HORTON

BY
BAGETT - GRIFFITH & BLACKMAN
2006 ADAMS AVENUE
LAGRANDE, OREGON 97850

RECEIVED

APPLICATION NO. T-11218

PERMIT NUMBER _____

NOTE: The preparation of this map was for the purpose of identifying the location of water rights and has no intent to provide dimensions or location of property ownership lines. Location information shown hereon was furnished by the applicant.

WATER RESOURCES DEPT
SALEM, OREGON