

CLAIM OF BENEFICIAL USE MAP  
 TRANSFER: T-8499  
 FOR  
 WAYNE LEEHMANN/24 RANCH, INC.

SECTION 10, TOWNSHIP 31 SOUTH  
 RANGE 16 EAST, W.M., LAKE COUNTY, OREGON

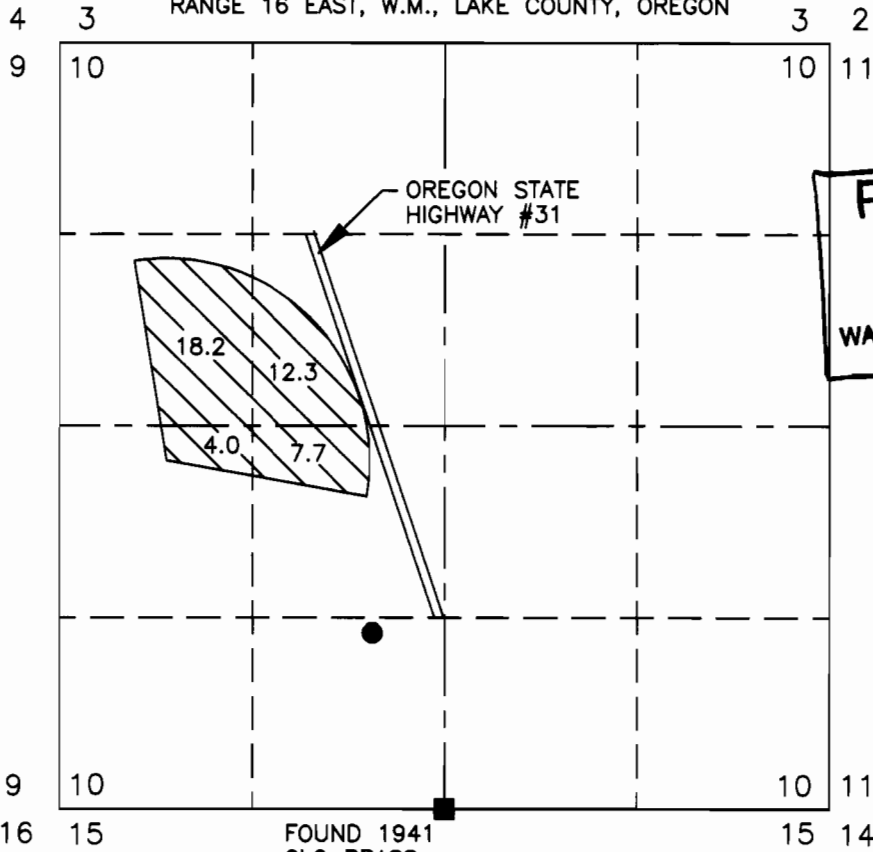

**RECEIVED**  
 DEC 06 2004  
 WATER RESOURCES DEPT  
 SALEM, OREGON

N  
 N  
 SCALE 1" = 1320'

FOUND 1941  
 GLO BRASS  
 CAP.

CERTIFIED WATER RIGHTS EXAMINER  
 #47698WRE  
*Rodney F. Callaghan*  
 RODNEY F. CALLAGHAN  
 MAY 21, 2001  
 STATE OF OREGON  
 RE-NEW: 12/31/03

LEGEND

● POINT OF APPROPRIATION, EXISTING WELL, LOCATED IN THE SE1/4 OF THE SW1/4 OF SECTION 10, 1216 FEET NORTH AND 494 FEET WEST FROM THE SOUTH 1/4 CORNER OF SECTION 10.



42.2 ACRES BEING IRRIGATED FROM THE POINT OF APPROPRIATION AS SHOWN.

THIS MAP IS FOR THE PURPOSE OF LOCATING A WATER RIGHT AND HAS NO INTENT TO PROVIDE LEGAL DIMENSIONS OR THE LOCATION OF PROPERTY LINES.

PREPARED FOR: WAYNE LEEHMANN/24 RANCH, INC.  
 50615 HIGHWAY 31  
 SUMMER LAKE, OR 97640

PREPARED BY:  
**CLS**  
 CALLAGHAN LAND SURVEYING  
 427 SOUTH H STREET  
 LAKEVIEW, OR 97630  
 (541) 947-5841

DATE: 8/27/2003 DRAWING: 200353