

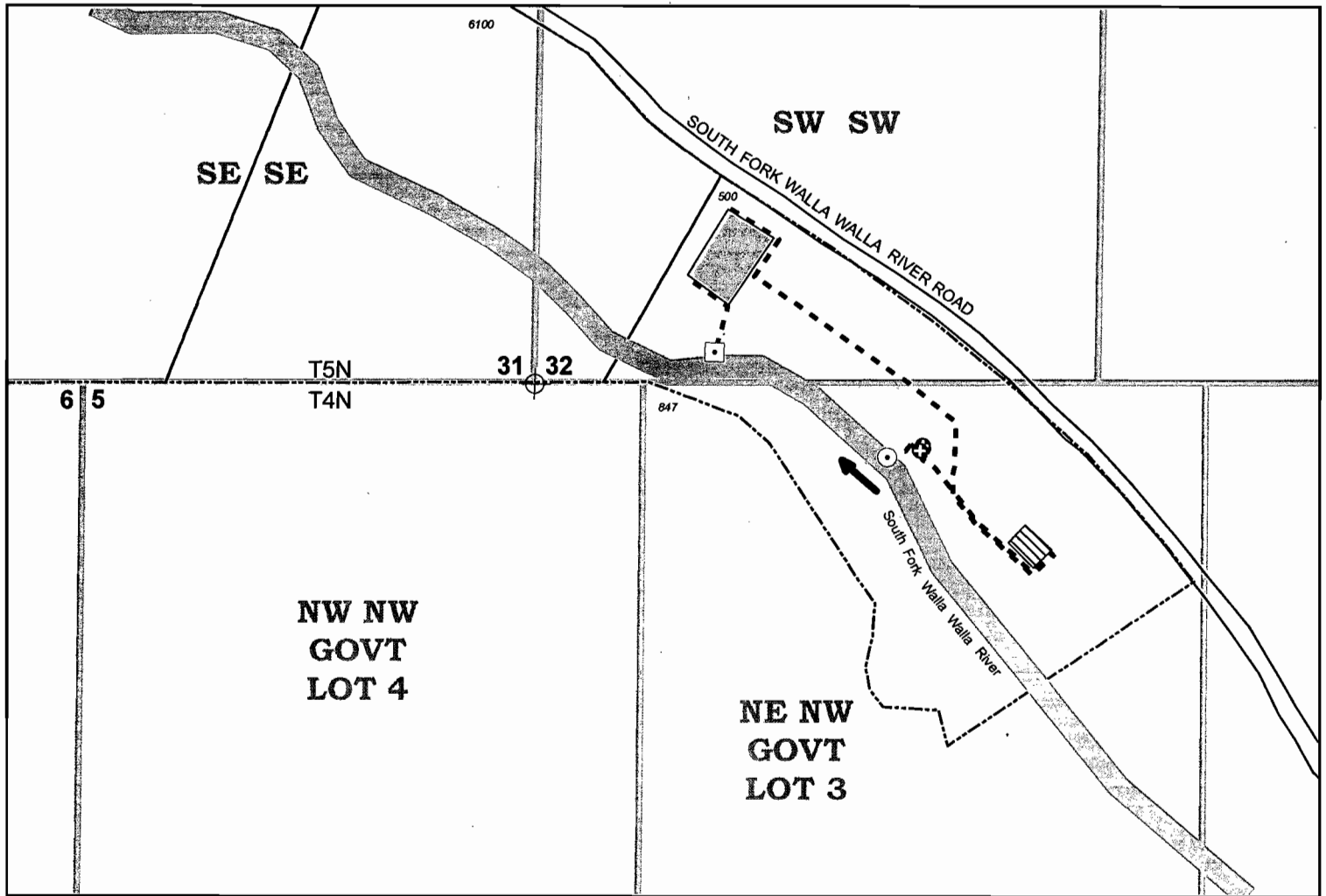

**Section 5, T4N, R37E, WM
Section 32, T5N, R37E, WM
Umatilla County**

1 inch = 400 feet



⊙ **Point of Diversion**

Headgate with fish screen located in NE/4 of NW/4 of Section 5, about 165 feet S and 830 feet E from SW Corner of Section 32.

⊕ **Pumps**

Two 200 horsepower turbine pumps located in building. One pump operated at a time.

--- **Conveyance**

Water conveyed from South Fork Walla Walla River to pump station via short reach of open ditch.

Water conveyed from pump station to rearing raceways via buried mainline (24-inch).

Water conveyed from rearing raceways to settling pond and outfall via buried mainline (24-inch).

 **Raceways**

Used to hold/rear and spawn adult Spring Chinook salmon in NE/4 of NW/4 of Section 5.

 **Settling Pond**

Used to treat water prior to discharge to river.

 **Weir and Outfall**
Measurement weir at outfall to South Fork Walla Walla River.

The purpose of this map is to identify the location of a water right. It is not intended to provide information regarding the location of property ownership boundary

FOUNTAINHEAD
1204 Alvarado Terrace
Walla Walla, WA 99362
509.529.2646 phone

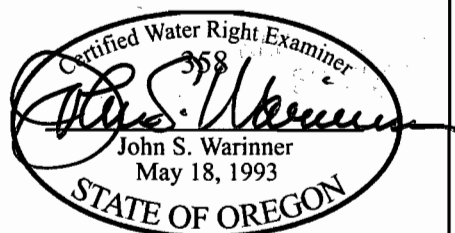

**CLAIM OF BENEFICIAL USE
Transfer 10019**

in the name of
CTUIR

Revised 28 OCT 2010