

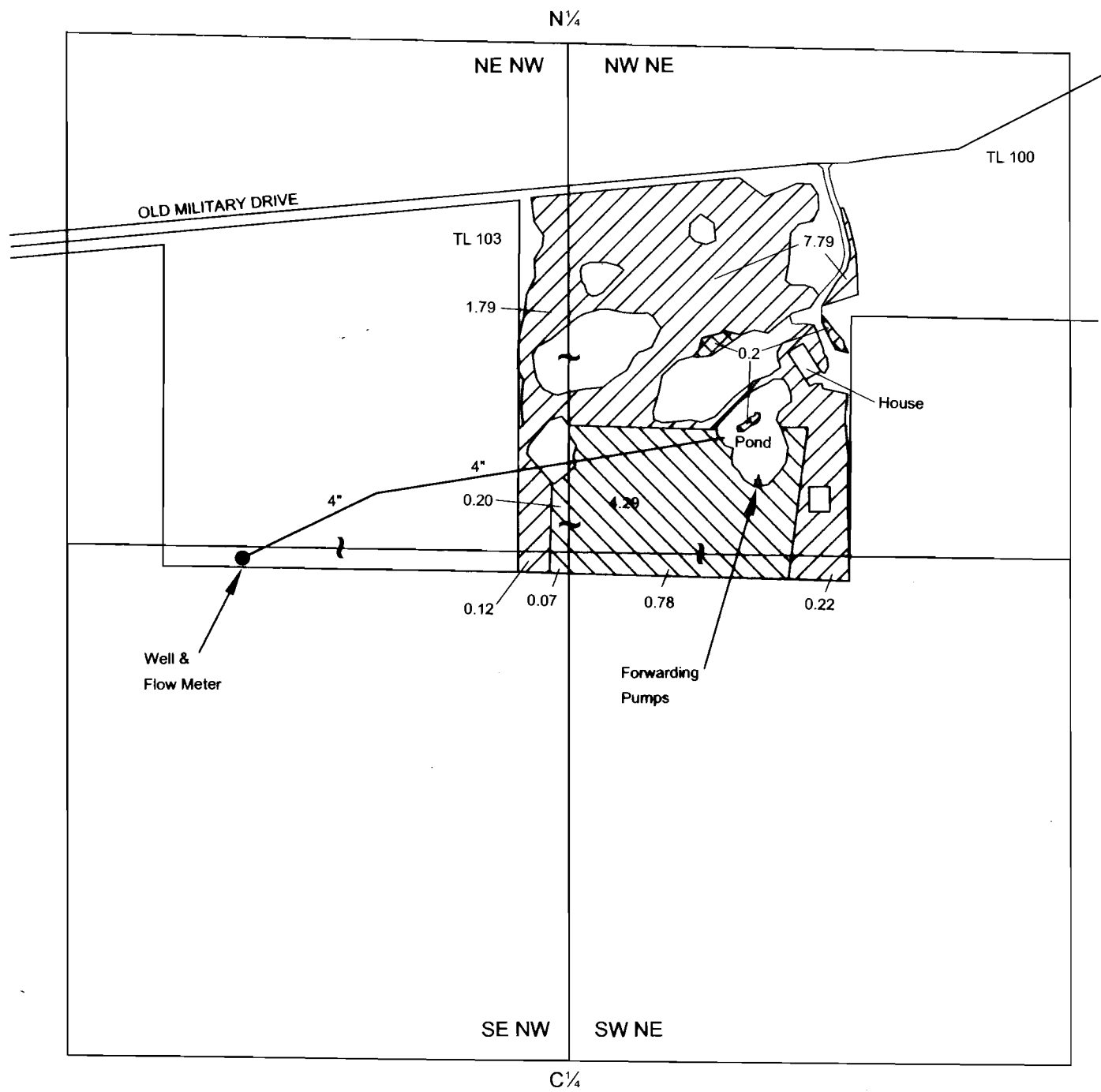



COB MAP # 0631

T14S, R10E, W.M.  
 Section 35  
 Deschutes County  
 Transfer T-104489  
 Claim of Beneficial Use Map  
 Dr. Craig Stephenson Property



EXPLANATION:

-  - 9.92 Acres  
Priority Date: January 16, 1985
-  - 5.34 Acres  
Priority Date: January 16, 1985
-  - 0.2 Acres  
Excess Irrigation
-  - Point of Appropriation (Well)

Well located 1380 ft S and 860 ft W from N 1/4 corner of Section 35

Site inspection conducted September 7 and 8, 2011

WRD mapping waiver obtained for not showing irrigation mainlines

RECEIVED  
 NOV 08 2011

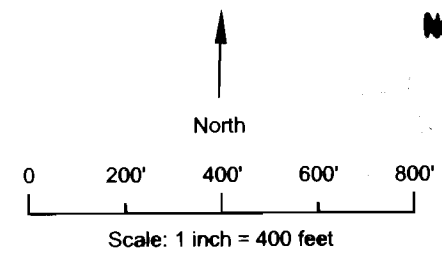

October 18, 2011

THIS MAP IS NOT INTENDED TO  
 PROVIDE LEGAL DIMENSIONS OR  
 LOCATIONS OF PROPERTY  
 OWNERSHIP LINES.

Figure 1

**SKOOKUM**  
 WATER ASSOCIATES, INC  
 P.O. Box 80174  
 Portland, OR 97280  
 (503) 319-8926

0631