

# FINAL PROOF SURVEY MAP IN THE NAME OF LINDLEY AND LOIS STANTON

**PERMIT 34988**

**T - 8645**

SECTION 24, TOWNSHIP 28 SOUTH, RANGE 4 WEST, W.M.

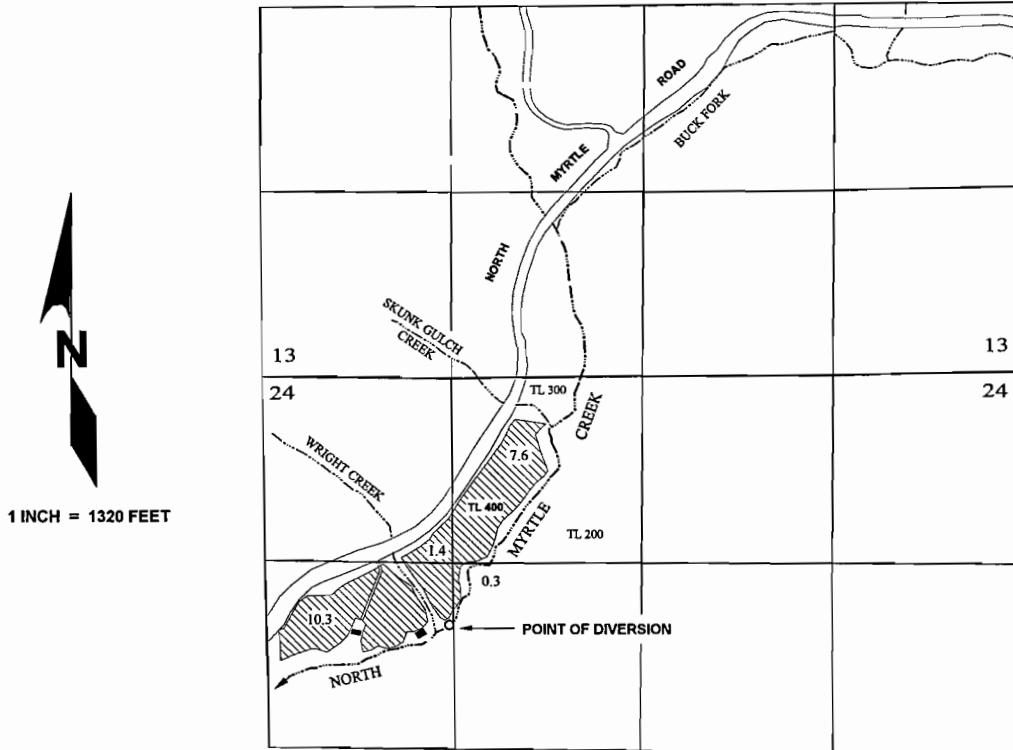

THE POINT OF DIVERSION IS LOCATED 1240 FEET NORTH AND 840 FEET EAST FROM THE WEST QUARTER CORNER OF SECTION 24; BEING WITHIN THE SW<sup>1</sup>/<sub>4</sub> NW<sup>1</sup>/<sub>4</sub> OF SECTION 24, TOWNSHIP 28 SOUTH, RANGE 4 WEST, W.M.; DOUGLAS COUNTY.

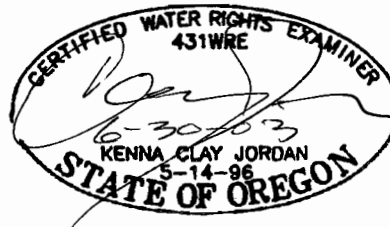

**RECEIVED**

MAY 21 2003

WATER RESOURCES DEPT.  
SALEM, OREGON

THE PURPOSE OF THIS MAP IS TO IDENTIFY THE LOCATION OF THE WATER RIGHT. IT IS NOT INTENDED TO PROVIDE INFORMATION RELATIVE TO THE LOCATION OF PROPERTY OWNERSHIP BOUNDARY LINES.