

T.4 & 5S., R.3W., W.M.

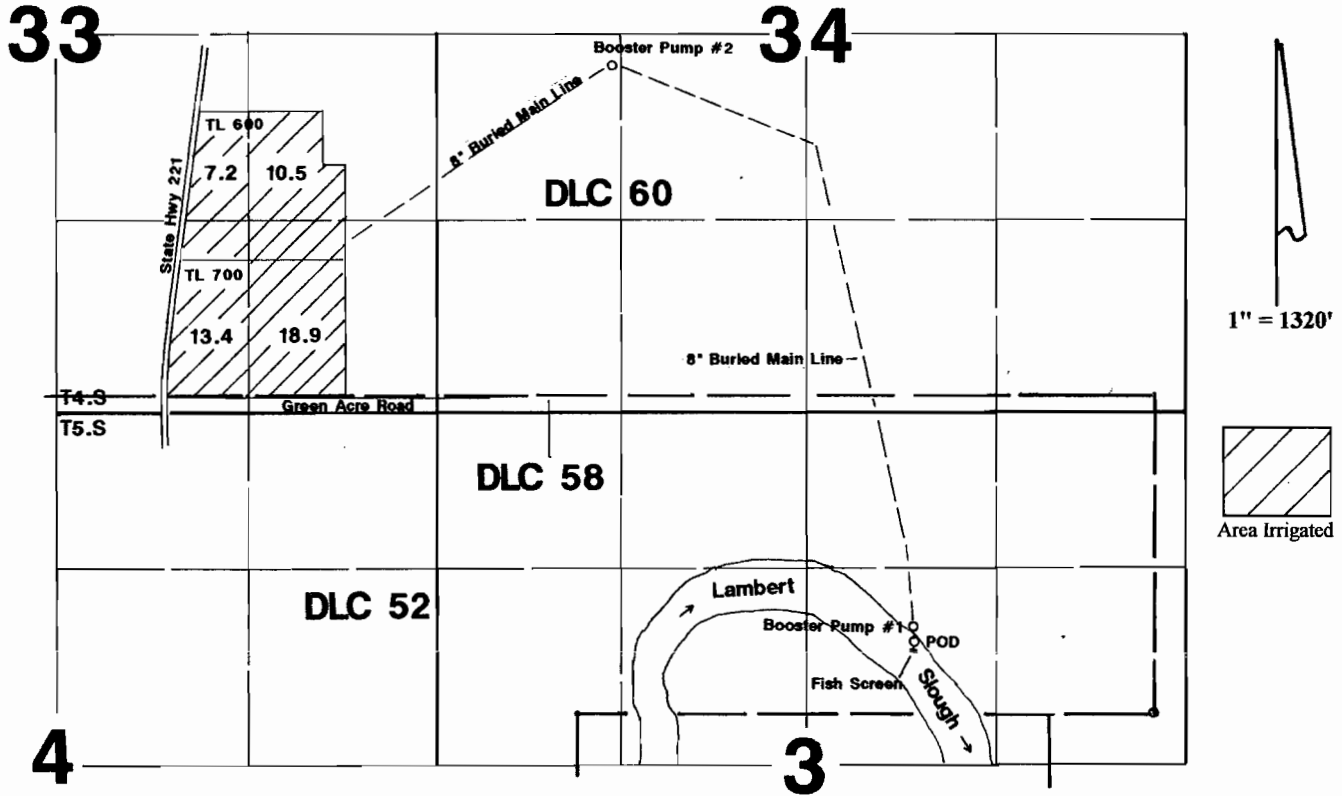

POD is located 505'N & 1645'W from the easterly SE corner of DLC 52.

RECEIVED

DEC 19 2008

WATER RESOURCES DEPT
SALEM, OREGON

Final Proof Survey

In the Name of

Arie & Patricia Slegers

Transfer #: T-9860

Surveyed on August 18, 2008 by JM Schuette

This Map was Prepared for the Purpose of Identifying the Location of a Water Right Only and is Not Intended to Provide Legal Dimensions or Location of Property Ownership Lines.

