

# FINAL PROOF SURVEY MAP IN THE NAME OF ART AND LINDA LUND

PERMIT 34988

TRANSFER T - 8684

SECTIONS 13 & 24, TOWNSHIP 28 SOUTH, RANGE 4 WEST, W.M.

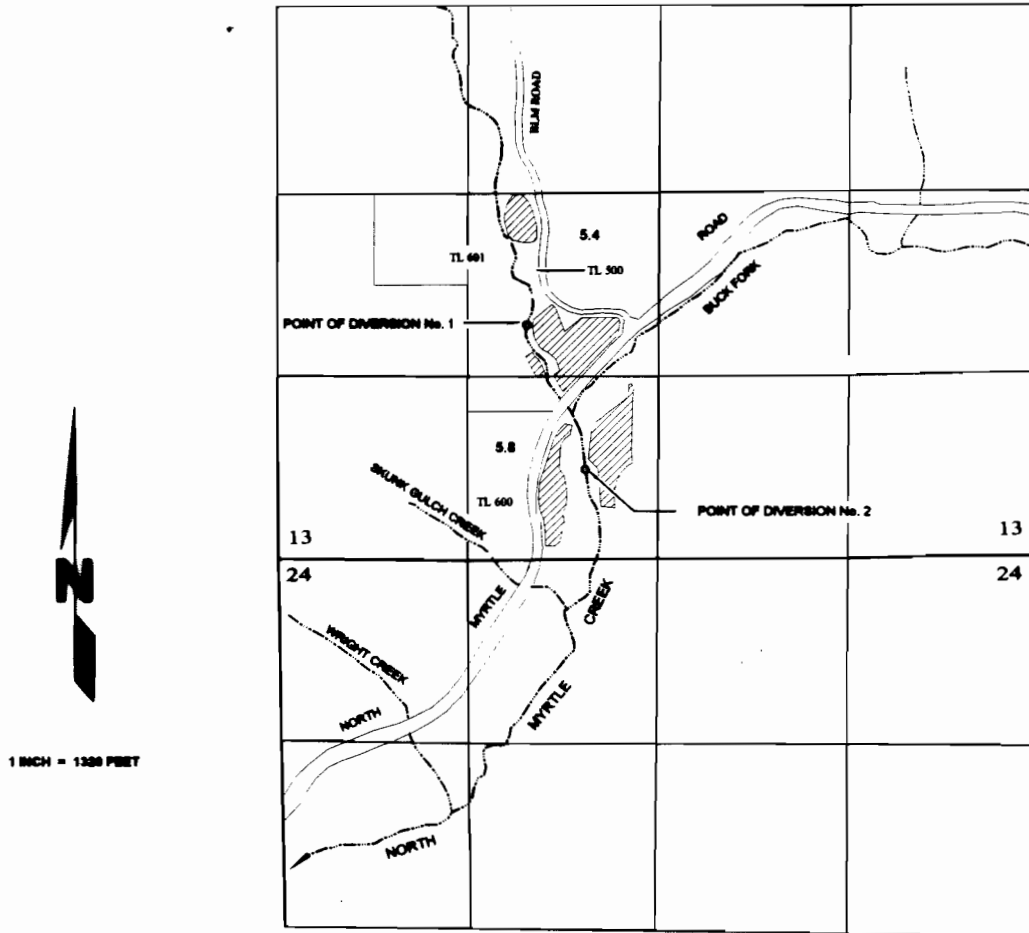

THE POINTS OF DIVERSION ARE LOCATED AS FOLLOWS:

P.O.D. No. 1: 1630 FEET NORTH AND 1706 FEET EAST; BEING WITHIN THE NE<sup>1</sup>/<sub>4</sub> SW<sup>1</sup>/<sub>4</sub> OF SECTION 13; and  
P.O.D. No. 2: 620 FEET NORTH AND 2100 FEET EAST; BEING WITHIN THE SE<sup>1</sup>/<sub>4</sub> SW<sup>1</sup>/<sub>4</sub> OF SECTION 13; BOTH  
FROM THE SOUTHWEST CORNER OF SECTION 13 AND WITHIN SECTION 13, TOWNSHIP 28 SOUTH, RANGE  
4 WEST, W.M.; DOUGLAS COUNTY.

**RECEIVED**

SEP 24 2003

WATER RESOURCES DEPT.  
SALEM, OREGON

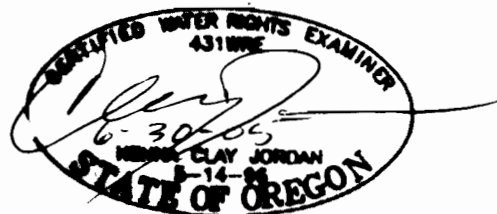

THE PURPOSE OF THIS MAP IS TO IDENTIFY THE LOCATION OF THE WATER RIGHT.  
IT IS NOT INTENDED TO PROVIDE INFORMATION RELATIVE TO THE LOCATION OF  
PROPERTY OWNERSHIP BOUNDARY LINES.