

T. 17 S., R. 2 W., W.M.

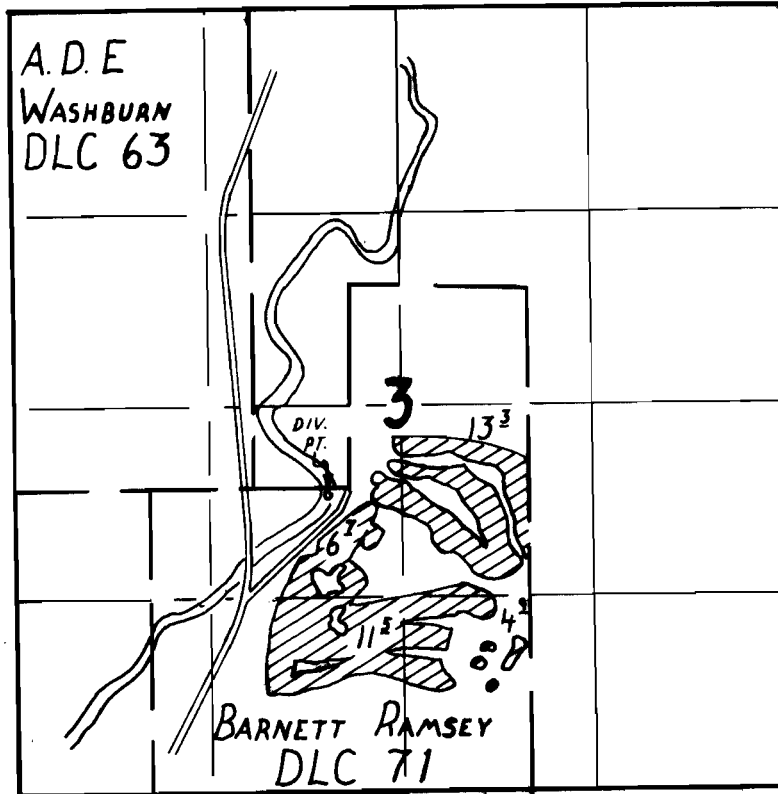

THE DIVERSION POINT IS LOCATED 60 FT. E. & 150 FT. W. FROM THE BESTLY INT. COR. DLC 71

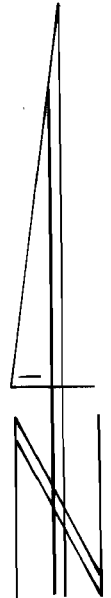

1" = 1320'

FINAL PROOF SURVEY

UNDER

Application No. 65818 Permit No. 47707
IN NAME OF

SPRINGFIELD COUNTRY CLUB

Surveyed MAY 18, 1992, by R.W. Klassen

T.17S. R.2W. Section 3, W.M.

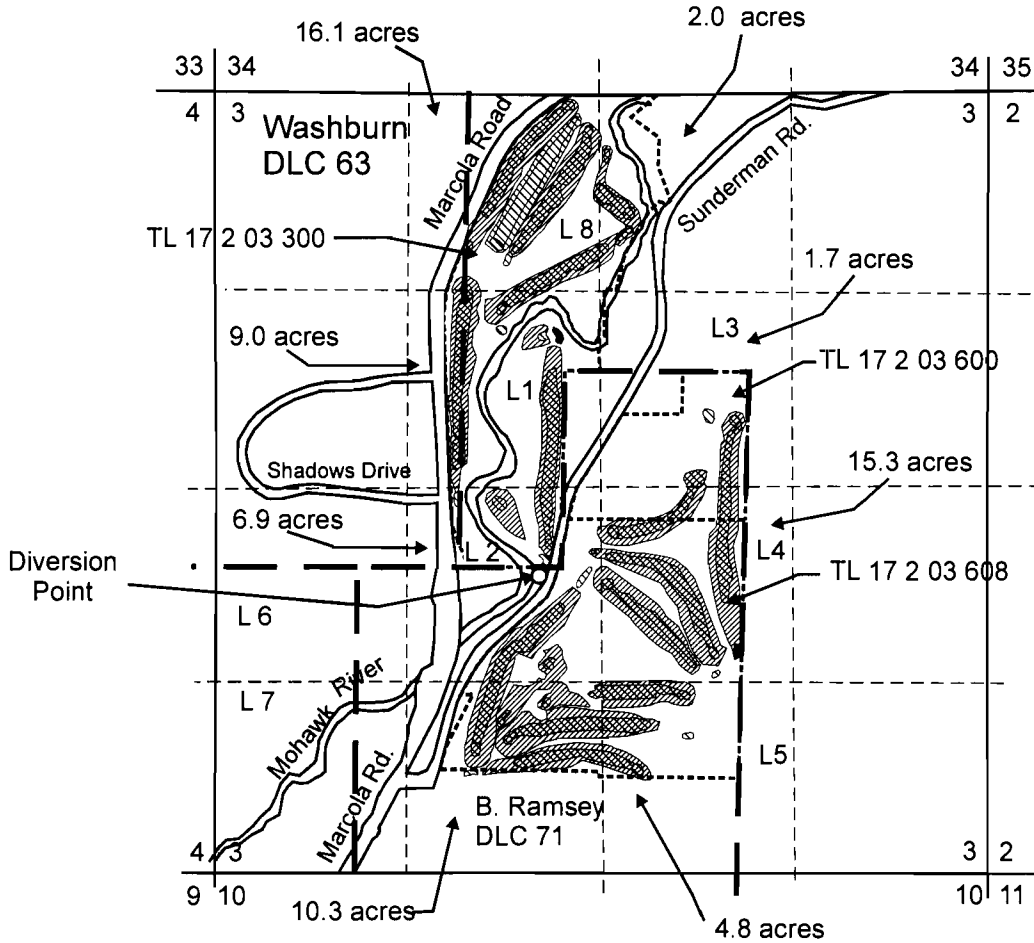

Authorized point of diversion is located 60 feet south and 150 feet west from the southeasterly interior corner of DLC 71.

 "To" areas (29.7 acres), Application S-32520, Permit S-25691, Certificate-29982

 "To" areas (36.4 acres), Application S-65818, Permit S-47707, Certificate 82065

----- Tax Lot Boundary

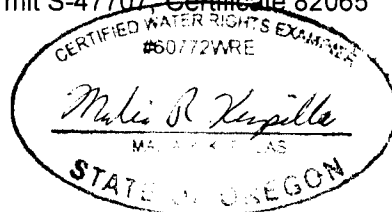

NOV 23 2009

Scale: 1" = 1,320'

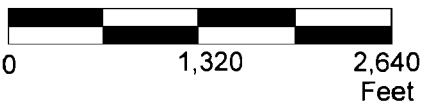

EXPIRATION DATE: _____
 This map was prepared for the purpose of identifying the location of a water right only and is not intended to provide legal dimensions or location of property ownership lines.

Combined map showing all areas to be irrigated under this transfer

Pacific Hydro-Geology Inc.

Springfield Country Club
 T.17S. R.2W. Sec. 3, W.M.

9/2009

T 10981

SPCC WR Master.cdr

T.17S. R.2W. Section 3, W.M.

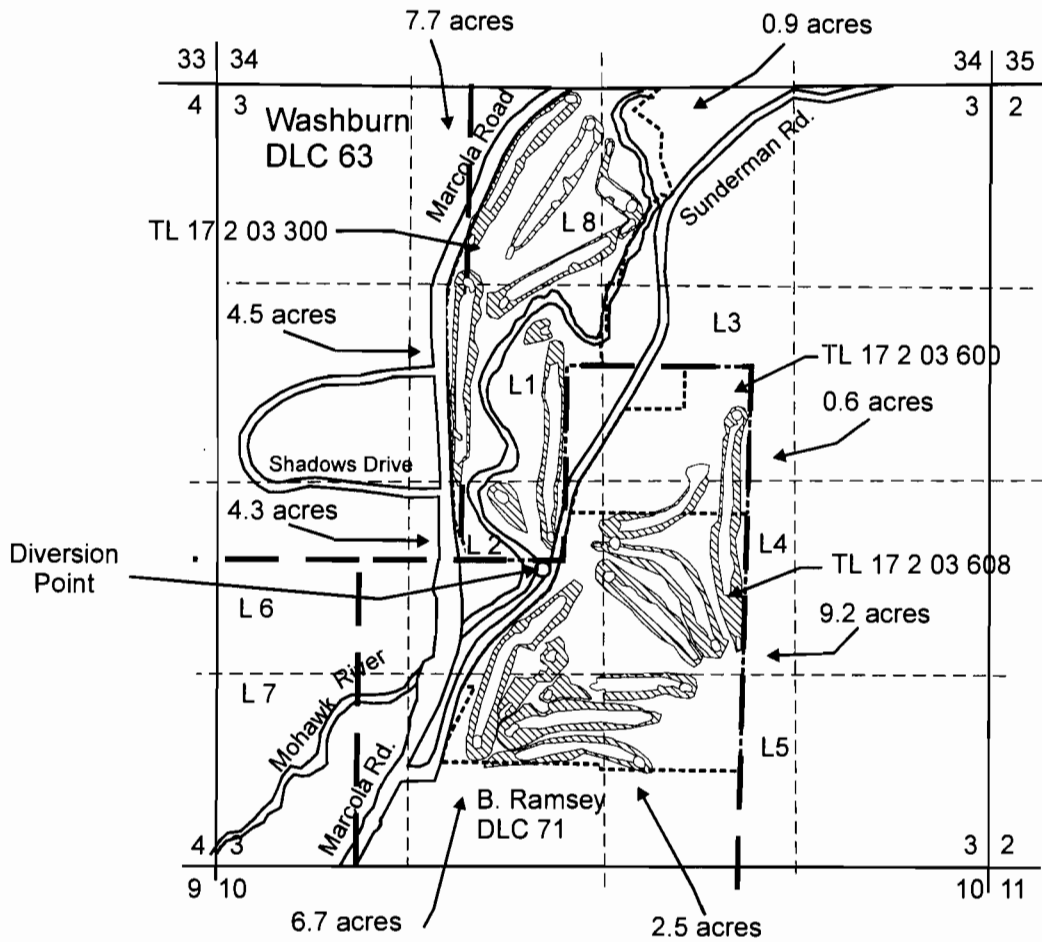

Authorized point of diversion is located 60 feet south and 150 feet west from the southeasterly interior corner of DLC 71.



"To" areas (36.4 acres), Application S-65818, Permit S-47707, Certificate 82065

----- Tax Lot Boundary

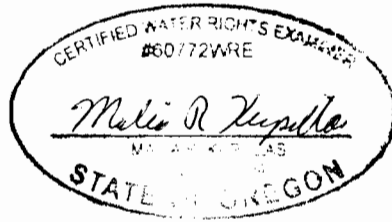

EXPIRATION DATE

This map was prepared for the purpose of identifying the location of a water right only and is not intended to provide legal dimensions or location of property ownership lines.



NOV 23 2009

Scale: 1" = 1,320'

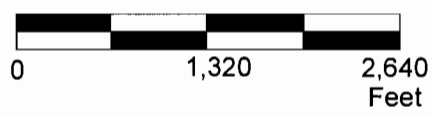

T 10981

Pacific Hydro-Geology Inc.

"To" map showing areas where water is to be applied under this transfer

Springfield Country Club
T.17S. R.2W. Sec. 3, W.M.

9/2009

SPCC WR Master.cdr

T.17S. R.2W. Section 3, W.M.

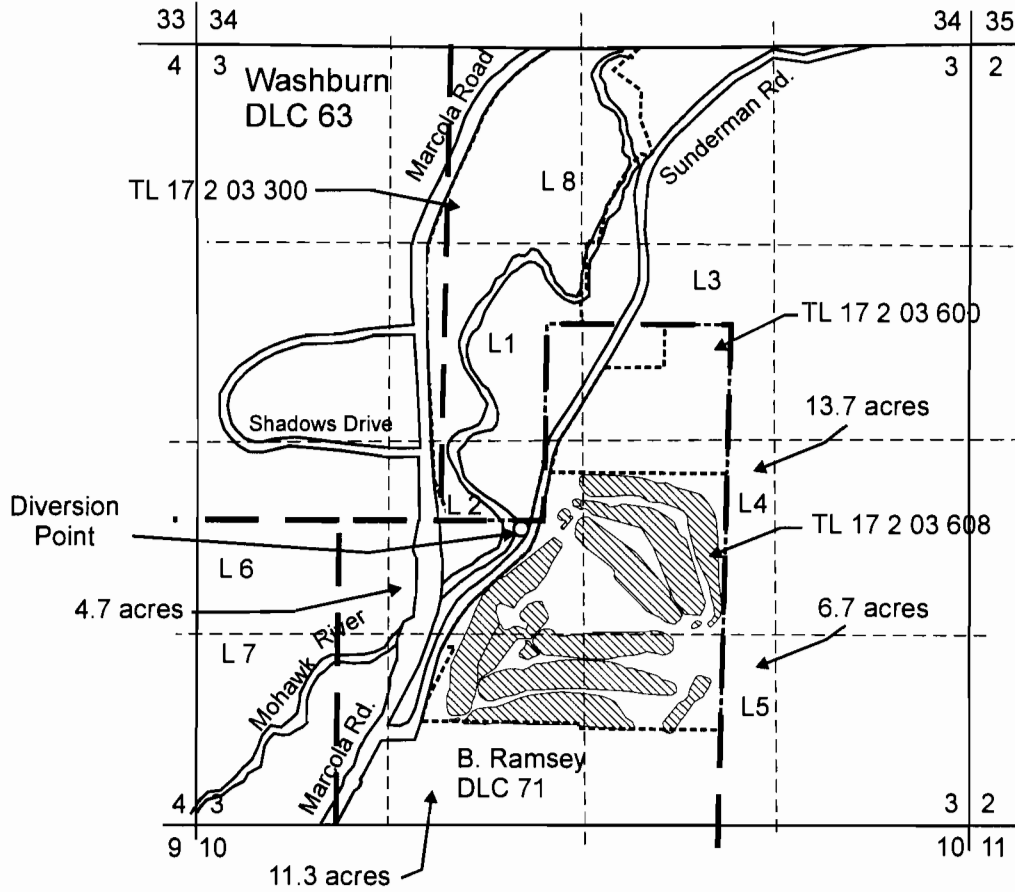

Authorized point of diversion is located 60 feet south and 150 feet west from the southeasterly interior corner of DLC 71.



"From" areas (36.4 acres), Application S-65818, Permit S-47707, Certificate 82065

----- Tax Lot Boundary

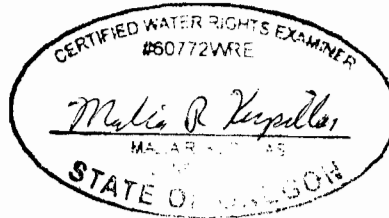

EXPIRATION DATE

NOV 23 2009

Scale: 1" = 1,320'

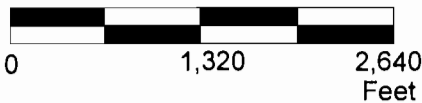

T 10981

This map was prepared for the purpose of identifying the location of a water right only and is not intended to provide legal dimensions or location of property ownership lines.

"From" map showing areas where water is applied under this transfer

Pacific Hydro-Geology Inc.

Springfield Country Club
T.17S. R.2W. Sec. 3, W.M.

9/2009

SPCC WR Master.cdr

T.17S. R.2W. Section 3, W.M.

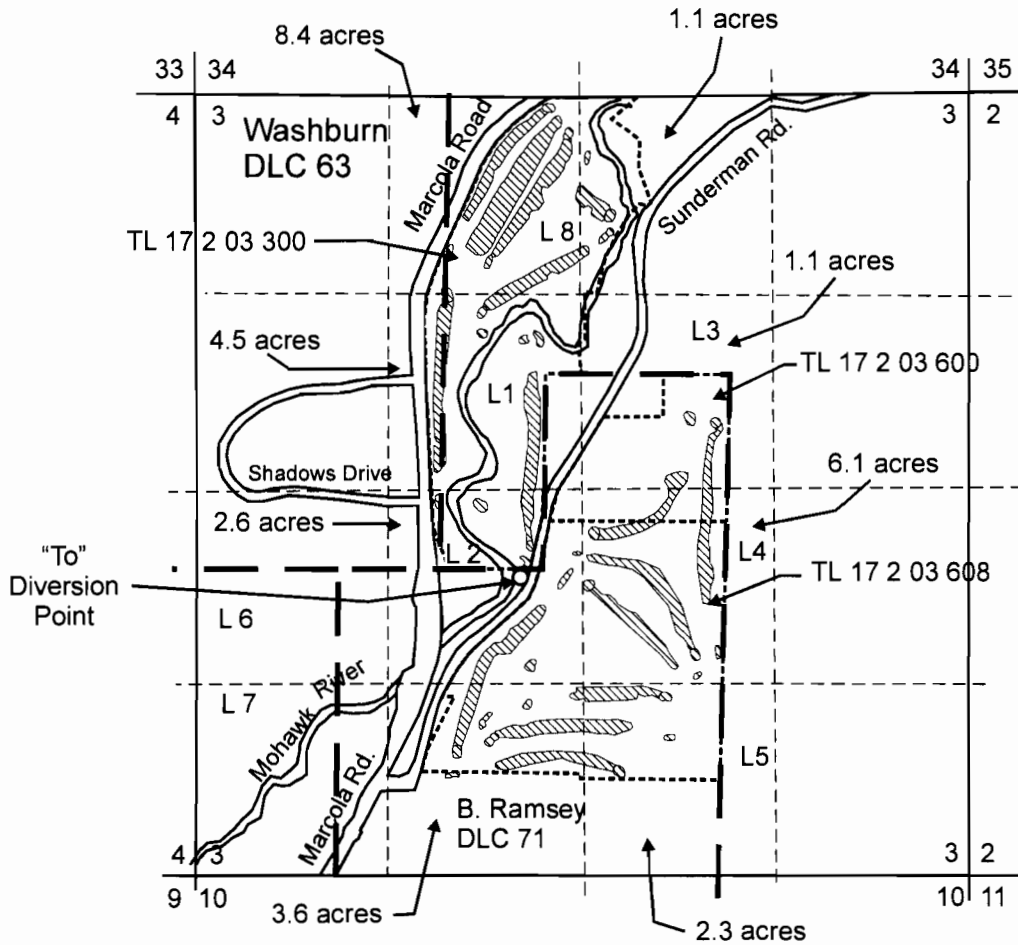

"To" Diversion Point (as authorized in Application S-65818, Permit S-47707, Certificate 82065) is located 60 feet south and 150 feet west from the southeasterly interior corner, DLC 71.

 "To" areas (29.7 acres), Application S-32520, Permit S-25691, Certificate 29982

----- Tax Lot Boundary

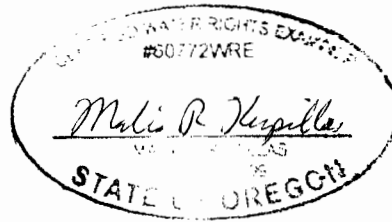

EXPIRATION DATE

This map was prepared for the purpose of identifying the location of a water right only and is not intended to provide legal dimensions or location of property ownership lines.



NOV 23 2009

Scale: 1" = 1,320'

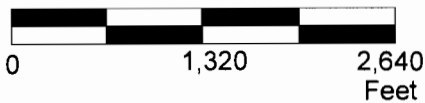

T 10981

Pacific Hydro-Geology Inc.

"To" Map showing areas where water is to be applied under this transfer

Springfield Country Club
T.17S. R.2W. Sec. 3, W.M.

9/2009

SPCC WR Master.cdr

T.17S. R.2W. Section 3, W.M.

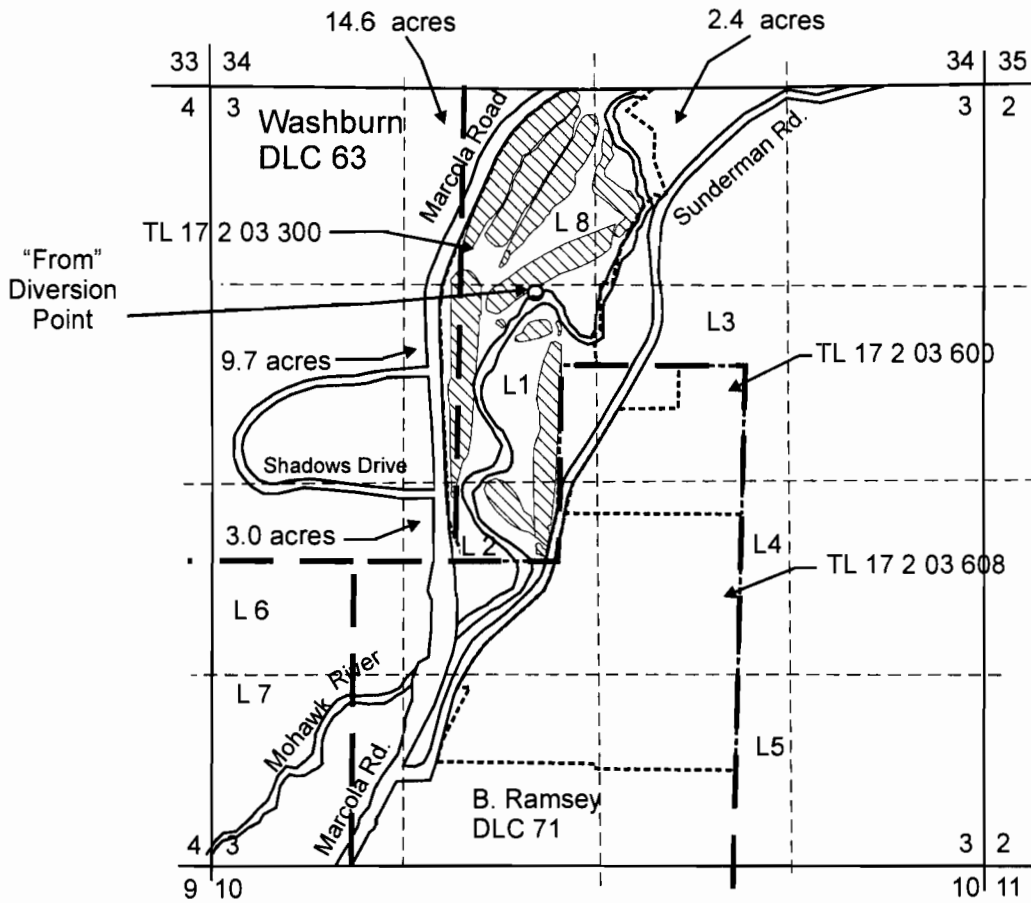

Authorized point of diversion is located 495 feet north and 175 feet west from the NNW Corner, B. Ramsey DLC 71.

 "From" area (29.7 acres), Application S-32520, Permit S-25691, Certificate 29982

 Tax Lot Boundary

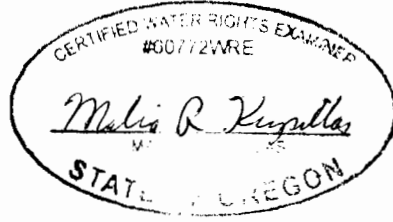

NOV 23 2009

Scale: 1" = 1,320'

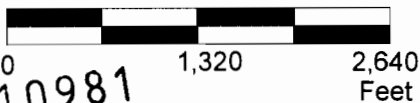

10981

EXPIRATION DATE

This map was prepared for the purpose of identifying the location of a water right only and is not intended to provide legal dimensions or location of property ownership lines.



"From" Map showing areas where water is applied under this transfer

Pacific Hydro-Geology Inc.

Springfield Country Club
T.17S. R.2W. Sec. 3, W.M.

9/2009

SPCC WR Master.pdf