

SW1/4 SW1/4

T.36S.,R.1W.,W.M.





RECEIVED

APR 26 1999

WATER RESOURCES DEPT.
SALEM, OREGON



SCALE 1" = 400'

-  = T-7662 (EPID)
-  = Cert. 75427 (No change from Permit No. 15987)
-  = Cert. 72476 (No change from Permit No. 17621)
-  = T-7661

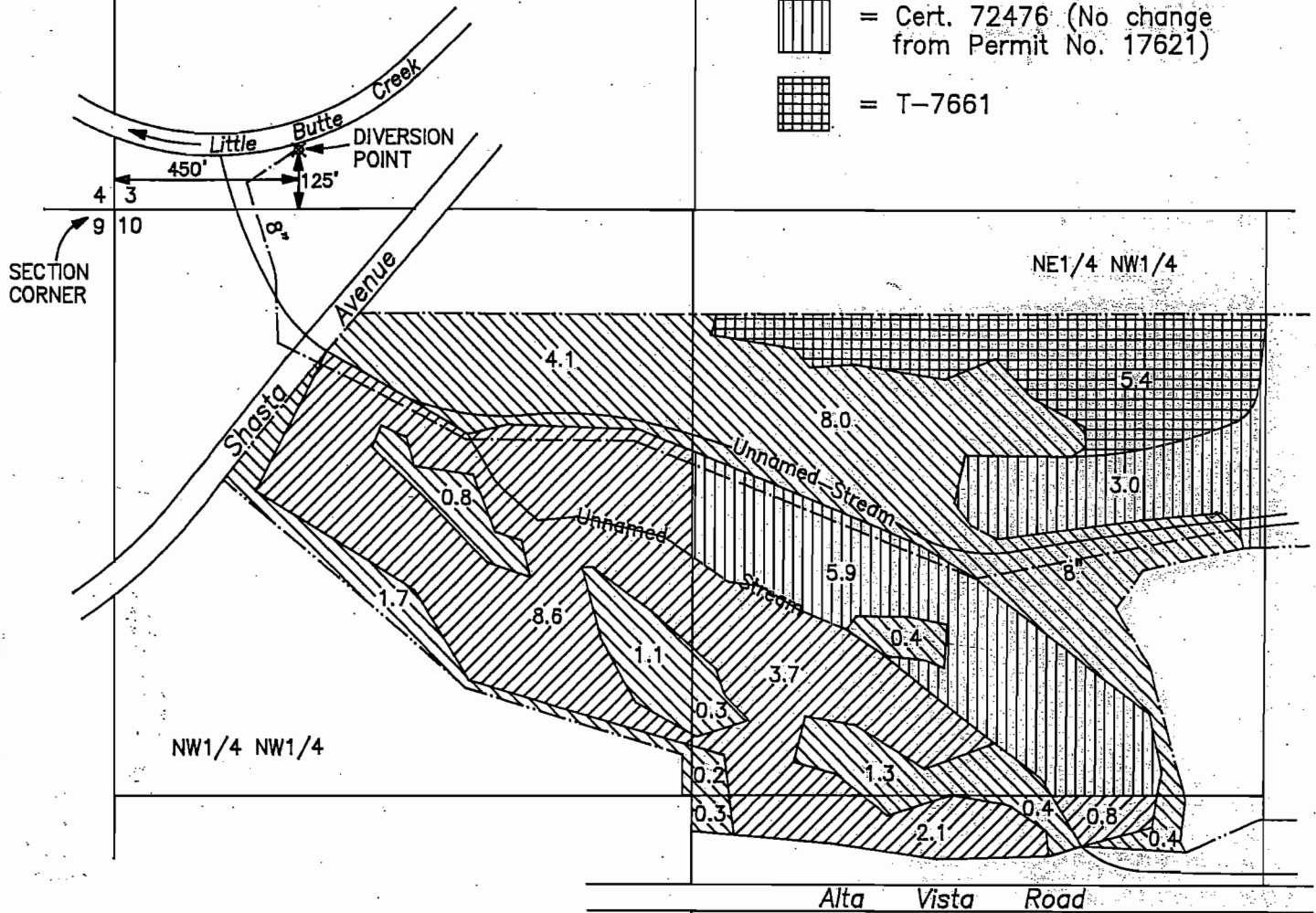

FINAL PROOF MAP

APPLICATION No. T-7660, T-7661,
T-7662, T-7663 & T-7664

IN THE NAME OF
EAGLE POINT GOLF CLUB, L.L.C.

MAP PREPARED MARCH 1, 1999
BY GARY D. KAISER

SE1/4 NW1/4

NOTE: MAP PREPARED FOR
WATER RIGHT PURPOSES ONLY,
NOT FOR PROPERTY BOUNDARY
LOCATIONS.

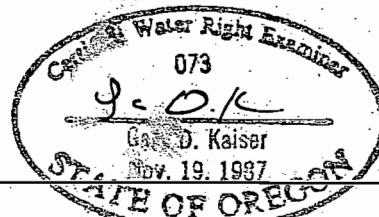

RECEIVED

T.36S.,R.1W.,W.M.

SHEET 2 OF 4

APR 26 1999

WATER RESOURCES DEPT.
SALEM, OREGON

SECTION COR.

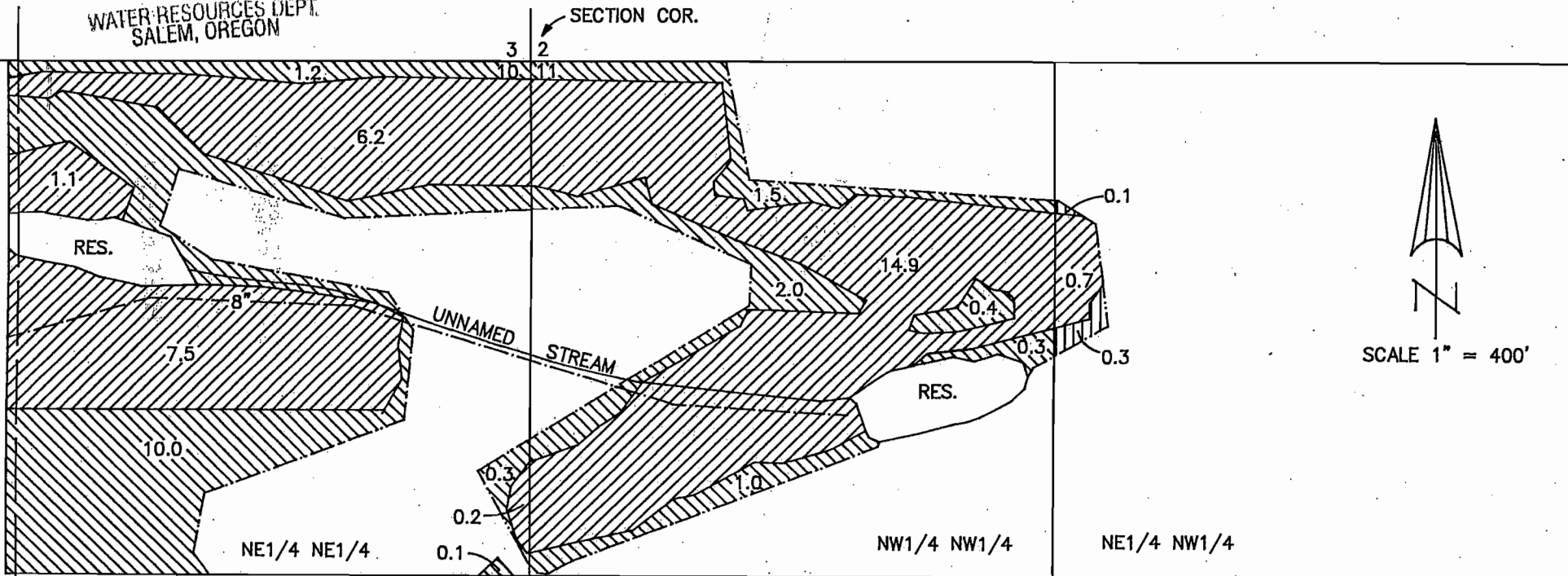

SCALE 1" = 400'

EAST BOUNDARY
D.L.C. NO. 47



FINAL PROOF MAP

APPLICATION No. T-7660, T-7661,
T-7662, T-7663 & T-7664

IN THE NAME OF
EAGLE POINT GOLF CLUB, L.L.C.

NOTE: 1. MAP PREPARED FOR
WATER RIGHT PURPOSES ONLY,
NOT FOR PROPERTY BOUNDARY
LOCATIONS.

2. FOR POINT OF DIVERSION
T-7664 SEE SHEET 1 OF 4

-  = Cert. 75429 (EPID, No Change)
-  = T-7662 (EPID)
-  = T-7664 (Little Butte Irrigation Co.)

MAP PREPARED MARCH 1, 1999 BY GARY D. KAISER

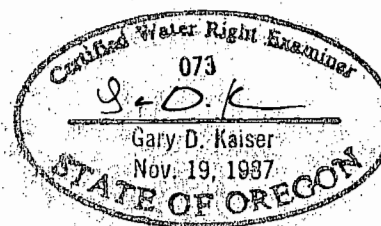

T.36S.,R.1W.,W.M.

S.E. D.L.C.
No. 46

N.E. D.L.C.
No. 47

SW1/4 SE1/4

RECEIVED

APR 26 1999

WATER RESOURCES DEPT.
SALEM, OREGON

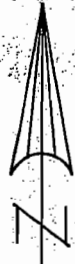

SCALE 1" = 400'



= Cert. 75429
(EPID, NO Change)



= T-7662 (EPID)



= T-7660



= Cert. 75427 (No change
from Permit No. 15987)



NOTE: 1. MAP PREPARED FOR
WATER RIGHT PURPOSES ONLY,
NOT FOR PROPERTY BOUNDARY
LOCATIONS.

2. FOR POINT OF DIVERSION
T-7660 AND CERT. 75427
SEE SHEET 1 OF 4

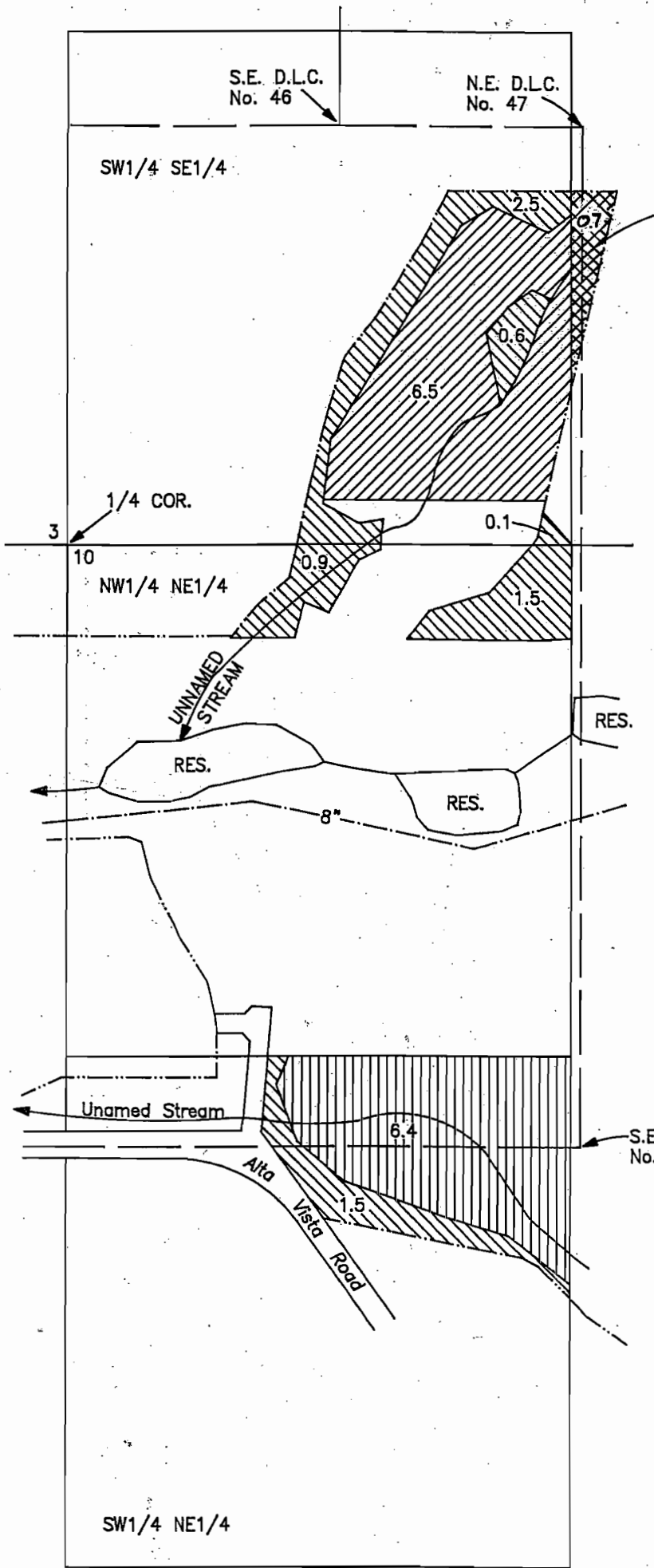

S.E. D.L.C.
No. 47

FINAL PROOF MAP

APPLICATION No. T-7660, T-7661,
T-7662, T-7663 & T-7664

IN THE NAME OF
EAGLE POINT GOLF CLUB, L.L.C.

MAP PREPARED MARCH 1, 1999
BY GARY D. KAISER

SW1/4 NE1/4

T.36S.,R.1W.,W.M.

RECEIVED

APR 26 1999

WATER RESOURCES DEPT.
SALEM, OREGON

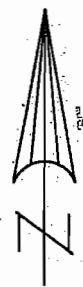

SCALE 1" = 400'

3 2
10 11
SECTION COR.

NE1/4 NE1/4

SE1/4 NE1/4

S.E. COR.
D.L.C.
No. 47

2.0

11.0

3.9

Unnamed Stream

Alta Vista Road

 = Cert. 75429
(EPID, No Change)

 = T-7663

NOTE: 1. MAP PREPARED FOR
WATER RIGHT PURPOSES ONLY,
NOT FOR PROPERTY BOUNDARY
LOCATIONS.

2. FOR POINT OF DIVERSION
T-7663 SEE SHEET 1 OF 4.

FINAL PROOF MAP

APPLICATION No. T-7660, T-7661,
T-7662, T-7663 & T-7664

IN THE NAME OF
EAGLE POINT GOLF CLUB, L.L.C.

MAP PREPARED MARCH 1, 1999 BY GARY D. KAISER

